

T. 7 S., R. 38 E., W.M.

RECEIVED

DEC 05 2002

WATER RESOURCES DEPT.  
SALEM, OREGON

Authorized P.O.D.  
located 240'  
South and 1800'  
East of the W<sup>1</sup>/<sub>4</sub>  
corner Sec. 34

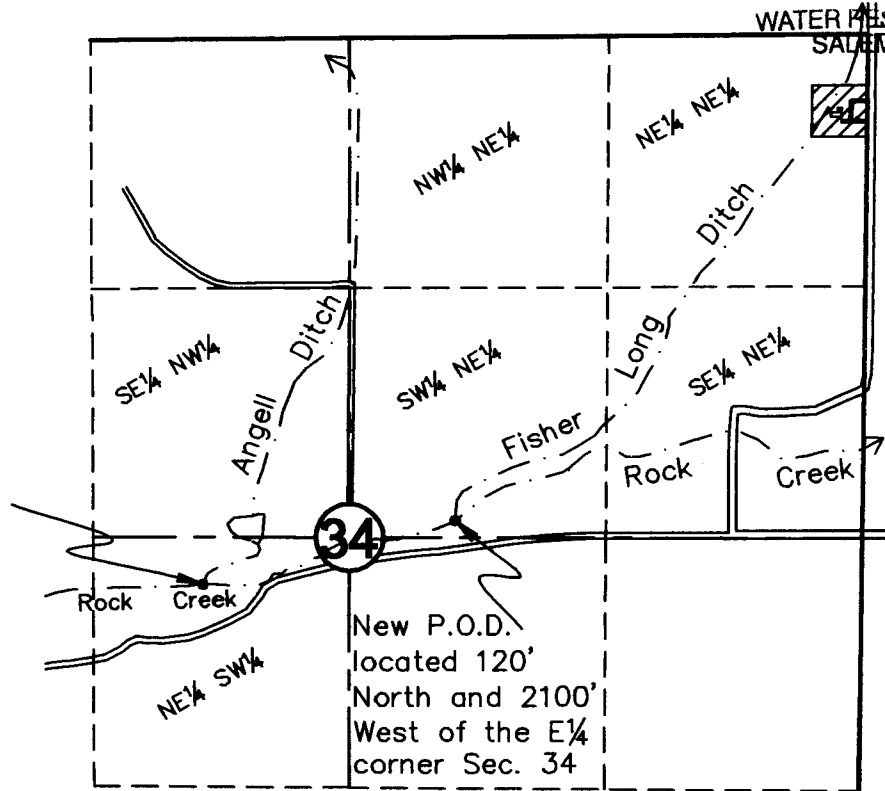

 Irrigated Lands

Scale: 1" = 1000'

FINAL PROOF SURVEY  
IN NAME OF  
Vance & Alice Tucker  
Application No. T-8755  
Surveyed July 2, 2002  
by Hanley Engineering

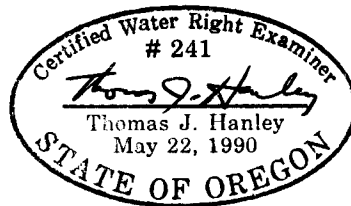

HANLEY ENGINEERING, INC.  
2043 MAIN STREET  
BAKER CITY, OREGON