

REVISED MAP

CLAIM OF BENEFICIAL USE

APPLICATION R-73610

PERMIT R-11511

APPLICATION S-73611

PERMIT S-51557

IN THE NAME OF DARYL ROBISON & DANIEL LOSHBAUGH

TOWNSHIP 31 SOUTH, RANGE 15 WEST, W.M.

CURRY COUNTY OREGON

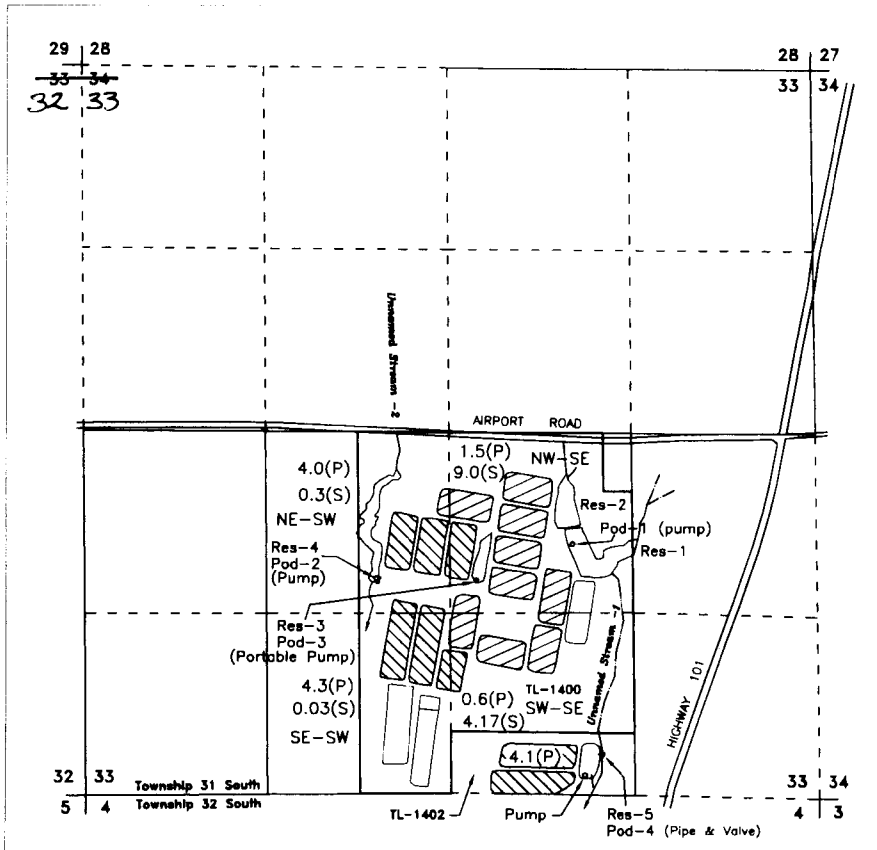

Scale
1 inch = 1320 feet

Revision based on survey map CS 31-178 over 2005 FSA & 2009 OSU aerial photos for assumed best fit

POD	NORTH	WEST	1/4 1/4	SECTION
1	1750	1740	NW/SE	33
2	1560	3150	NE/SW	33
3	1540	2430	NW/SE	33
4	295	1540	SW/SE	33

All from the SE Corner of Section 33 Township 31S, Range 15 W, W.M.

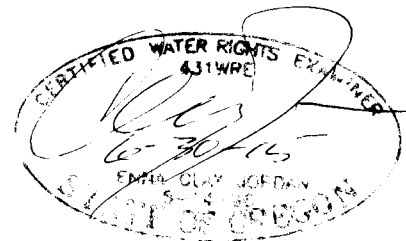

CRANBERRY OPERATIONS

- 14.5 Acres Primary
- 13.5 Acres Supplemental

Tax Lot 1400 - Robison
Tax Lot 1402 - Loshbaugh

This map is not intended to provide legal dimensions or locations of property ownership lines

Mapped from field inspection June 1, 2011 & September 25, 2012

JORDAN ENGINEERING
460 JORDAN LANE
ROSEBURG, OR 97471
(541) 673-1931

10/15/2012 n.e.d.

Map updated to reflect correct section numbers. MB/WRD 4-28-15