

T.4S. R.1W. Sec. 36, W.M. & T.4S. R.1E. Sec. 31, W.M.

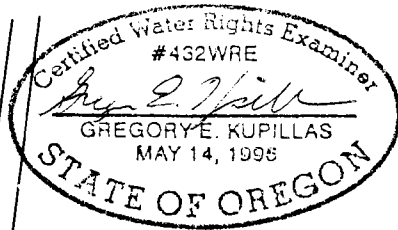

EXPIRATION DATE: 6/30/2015

West 1/4 Corner, Sec. 31

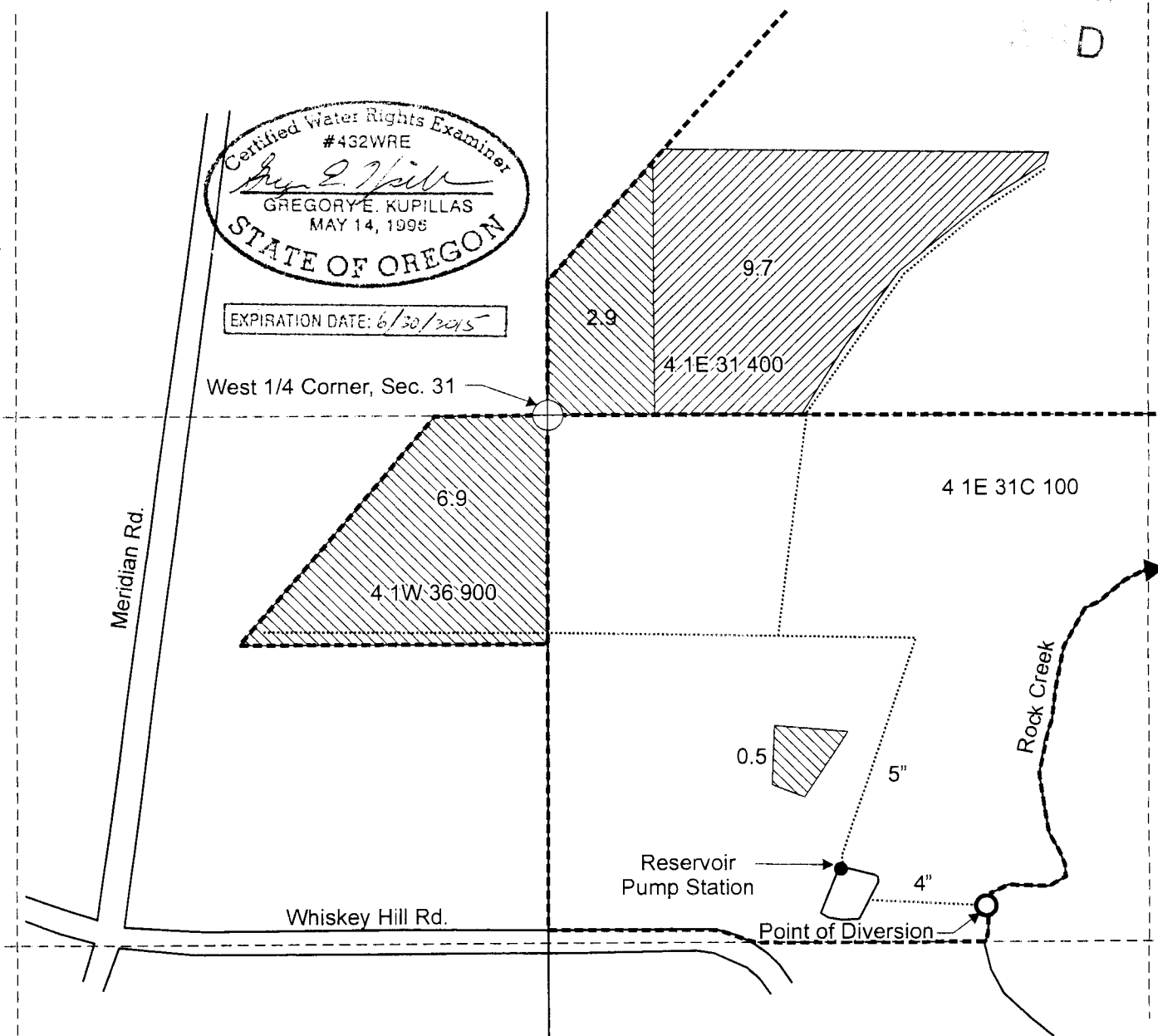

Point of Diversion is located 1,240 feet south and 1,090 feet east from the west 1/4 corner, Section 31.

- Area (9.7 acres) irrigated under T-7586, assigned to Warren Bean
- Area (10.3 acres) irrigated under T-7586, retained by Joel Neuschwander
- Tax lot boundary
- Mainline

Scale: 1" = 400'

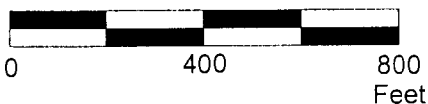

This map was prepared for the purpose of identifying the location of a water right only and is not intended to provide legal dimensions or location of property ownership lines.



Claim of Beneficial Use Map
Transfer 7586

Joel Neuschwander and Warren Bean
T.4S. R.1W. Sec. 36, W.M. &
T.4S. R.1E. Sec. 31, W.M.

Pacific Hydro-Geology Inc.

Amended 8/6/2014

T-7586_COBU_Map_Amended_2014_08_06_gek.cdr