

# REVISED MAP

## CLAIM OF BENEFICIAL USE

APPLICATION R-69982

PERMIT R-11243

APPLICATION S-69983

PERMIT S-51053

IN THE NAME OF DARYL ROBISON

TOWNSHIP 31 SOUTH, RANGE 15 WEST, W.M.

CURRY COUNTY OREGON

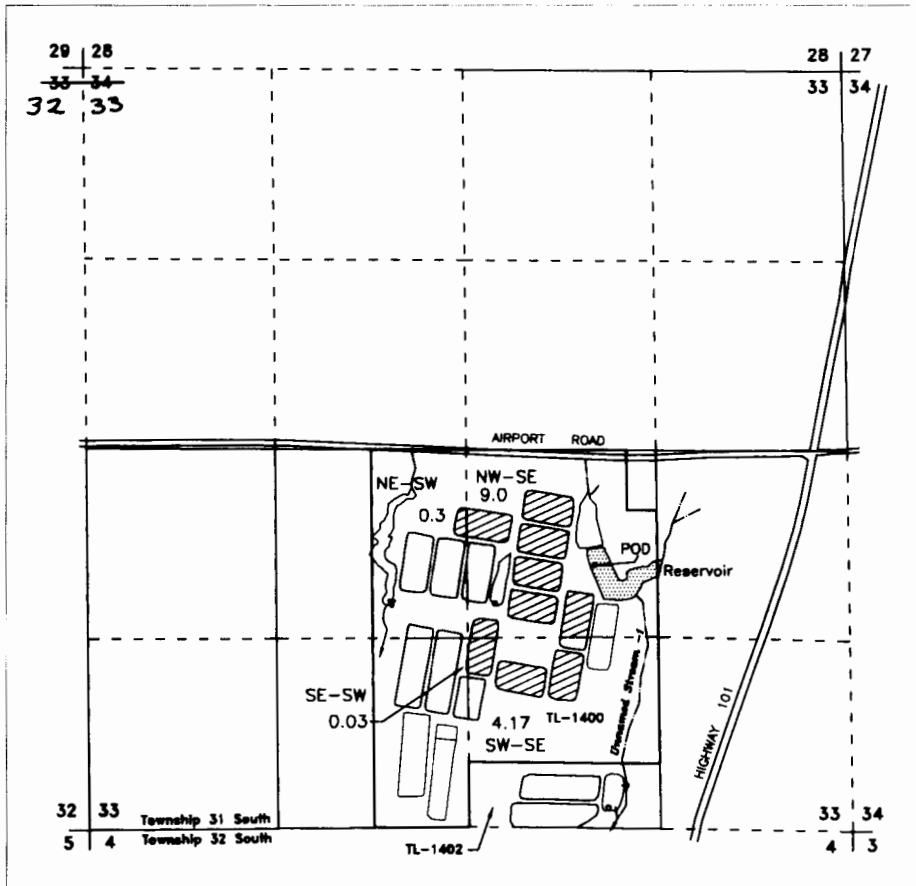

Scale  
1 inch = 1320 feet

Revision based on survey map CS 31-178 over 2005 FSA & 2009 OSU aerial photos for assumed best fit

POD - 1750 FEET NORTH AND 1740 FEET WEST FROM THE SOUTHEAST CORNER OF SECTION 33, BEING WITHIN THE NW1/4 SE1/4 OF SECTION 33

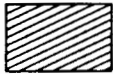
CRANBERRY OPERATIONS	
	13.5 Acres

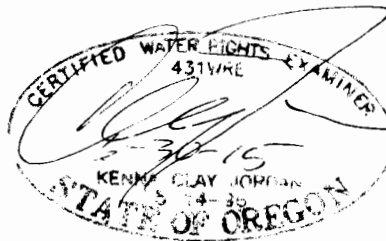

Mapped from field inspection June 1, 2011 & September 25, 2012

JORDAN ENGINEERING  
460 JORDAN LANE  
ROSEBURG, OR 97471  
(541) 673-1931

10/15/2012 n.e.d.

This map is not intended to provide legal dimensions or locations of property ownership lines

Map updated to reflect correct section numbers. MB/wrd 4-28-15