

Claim of Beneficial Use in the Name of Pine Meadow Ranch, Inc. Place of Use/Point of Diversion Map

Transfer CW-82, Former Certificates 293, 44043, and 75141
Township 15 South, Range 10 East (W.M.)

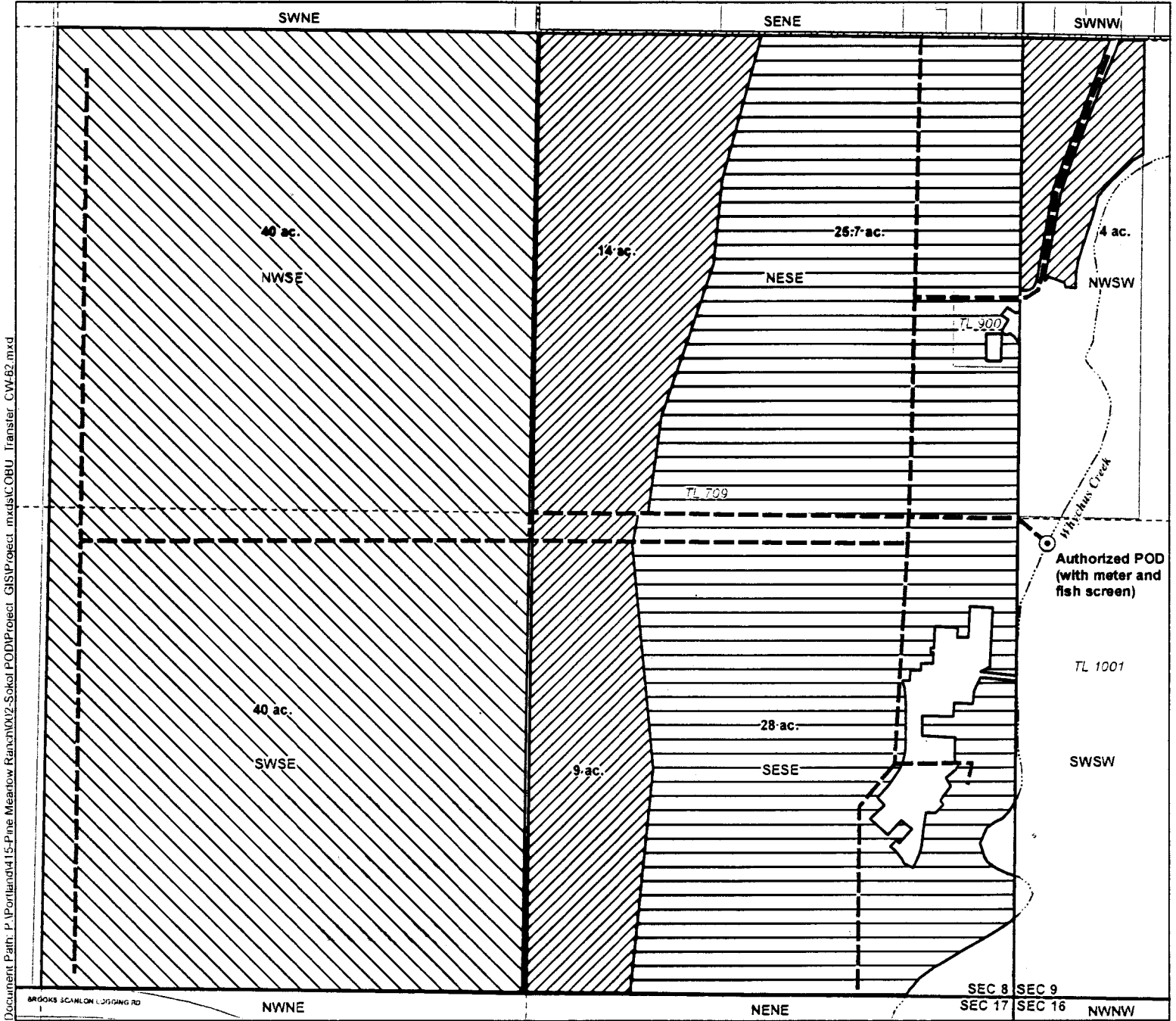

Document Path: P:\Portland\15-Pine Meadow Ranch\15-Sokal POD\Project_GIS\Project.mxd\K:\C:\OBU_Transfer_CW-82.mxd

LEGEND

Authorized Place of Use (POU)

- Former Certificate 293 (1886)
- Former Certificate 44043 (1886)
- Former Certificate 75141 (1885)
- Authorized Point of Diversion (POD)

- Conveyance Pipelines (locations provided by ranch)
- Sisters City Limits
- Waterbodies
- Watercourses

LOCATION DESCRIPTION

Authorized POD
Latitude 44.280227, Longitude -121.553322;
Located 1,250 feet North and 10 feet East from the SW corner of Section 9, Township 15 South, Range 10 East (W.M.)
- meter is located 10 feet west of pump
- fish screen is located at intake in creek

Certified Water Rights Examiner Stamp

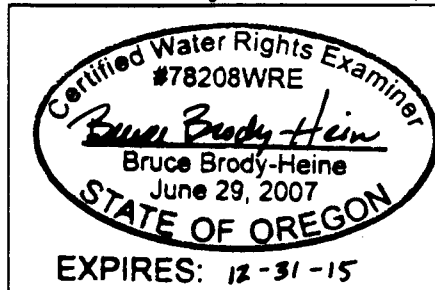

Disclaimer

This map was prepared for the purpose of identifying the location of a water right only and it is not intended to provide legal dimensions or location of property ownership lines.

Map Notes

Date: October 13, 2014
Data Sources: Deschutes Co. GIS, OWRD, USGS
Prepared By: GSI Water Solutions, Inc.



0 200 400
1 inch = 400 feet

