

WATER RIGHT TRANSFER MAP
T25S, R4W, WM
SCALE 1" = 1320'
DOUGLAS COUNTY

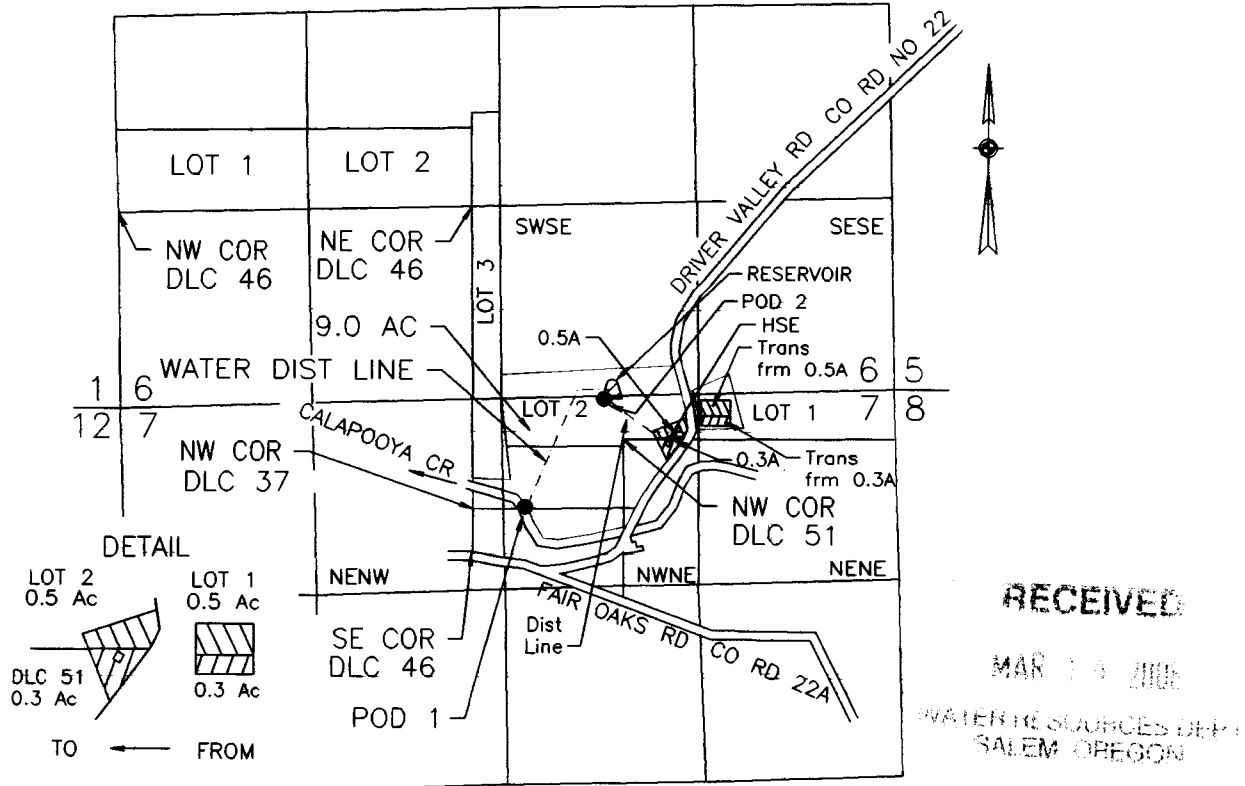

POD 1 IS 820 FT S AND 2530 FT W FROM NE COR SEC 7
POD 2 IS 80 FT S AND 1990 FT W FROM NE COR SEC 7

FINAL PROOF SURVEY
UNDER

Transfer No. T-9318 Certificate No. 20269

IN NAME OF
Dale E Beattie

Surveyed January 6, 2006 by M E Farr

THIS IS A LOCATION MAP FOR A FINAL PROOF SURVEY BY DALE E BEATTIE. THIS MAP IS FOR THE PURPOSE OF IDENTIFYING THE LOCATION OF THE WATER RIGHT ONLY AND IS NOT INTENDED TO PROVIDE LEGAL DIMENSIONS OR LOCATIONS OF PROPERTY OWNERSHIP LINES.

MAP PREPARED FOR:
DALE E BEATTIE
12986 DRIVER VALLEY ROAD
OAKLAND, OR 97462

MAP PREPARED BY:
MAURICE E FARR, CWRE
395 NE KIRBY AVENUE
ROSEBURG, OR 97470

