

FINAL PROOF SURVEY MAP

RECEIVED

IN THE NAME OF ROBERT M. LOFTIN

SEP 28 1999

SECTIONS 8 & 9, T 29 S, R 14 W, W.M.

WATER RESOURCES DEPT.
SALEM, OREGON

APPLICATION R-83393

PERMIT R-12324

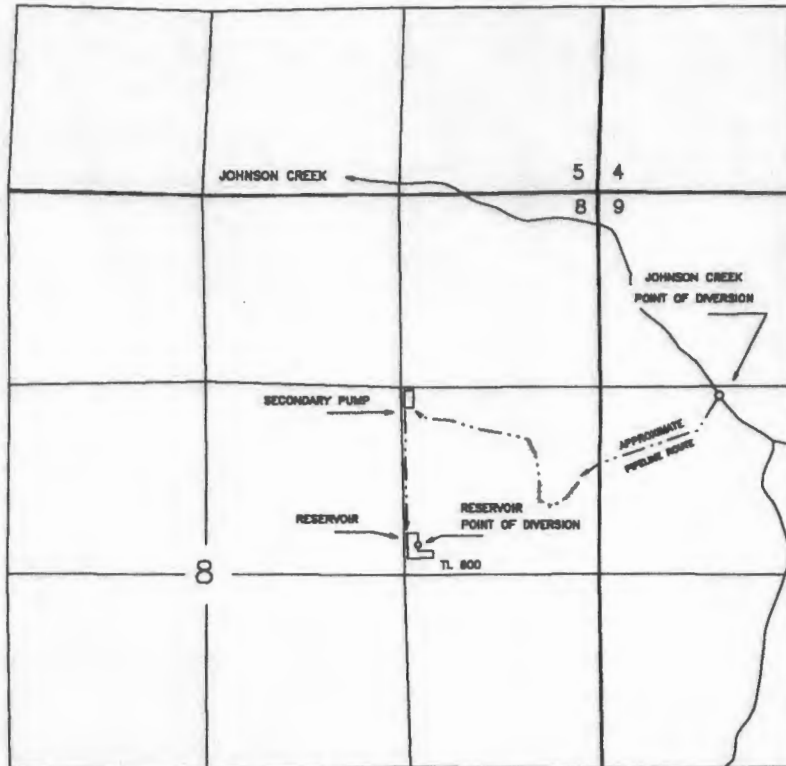

THE POINT OF DIVERSION ON JOHNSON CREEK IS LOCATED 1,415 FEET SOUTH AND 825 FEET EAST OF THE NORTHWEST CORNER OF SECTION 9, BEING WITHIN THE SW $\frac{1}{4}$ NW $\frac{1}{4}$ OF SECTION 9, TOWNSHIP 29 SOUTH, RANGE 14 WEST, W.M.; COOS COUNTY

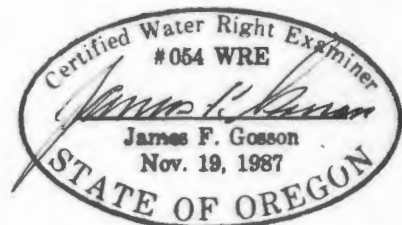

THE PURPOSE OF THIS MAP IS TO IDENTIFY THE LOCATION OF THE WATER RIGHT. IT IS NOT INTENDED TO PROVIDE INFORMATION RELATIVE TO THE LOCATION OF PROPERTY OWNERSHIP BOUNDARY LINES.