

T.4S. R.1W. Section 5, W.M.

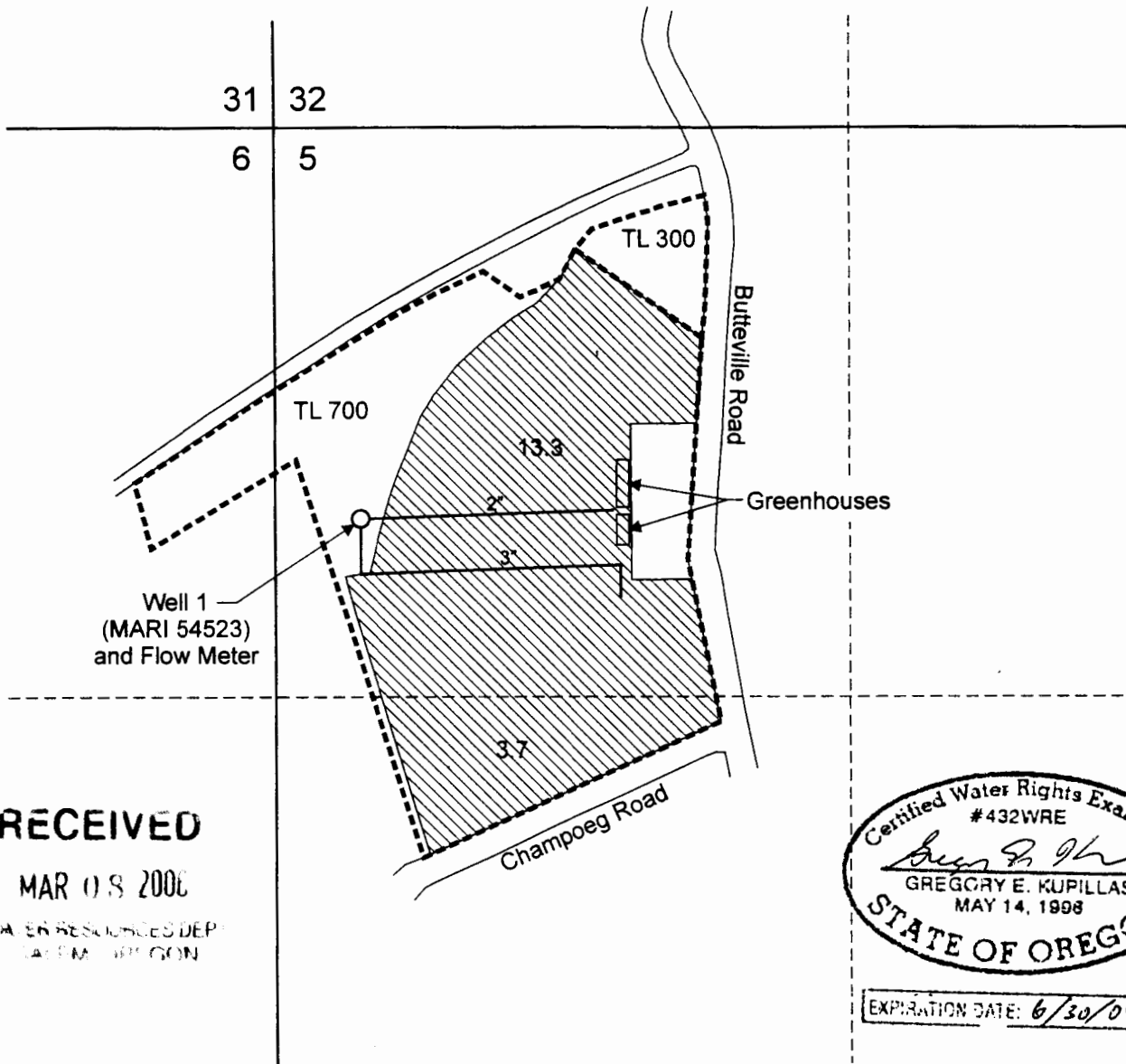

RECEIVED

MAR 08 2006

WATER RESOURCES DEPT
Salem, Oregon

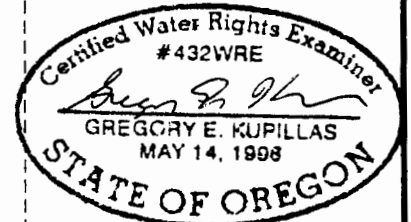

EXPIRATION DATE: 6/30/07

Well 1 (MARI 54523) is located 910 feet south and 190 feet east from the NW corner of Section 5.

Area (17.0 Acres) irrigated under Application G-14937, Permit G-13772.

Tax lot boundary

Scale: 1" = 400'

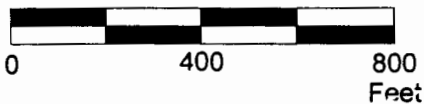

This map was prepared for the purpose of identifying the location of a water right only and is not intended to provide legal dimension or location of property ownership lines.



Claim of Beneficial Use Map
Application G-14937, Permit G-13772

Pacific Hydro-Geology Inc.

Elsinore Development Group LLC

2/2006