

RECEIVED BY OWRD

FEB 11 2015

SALEM, OR

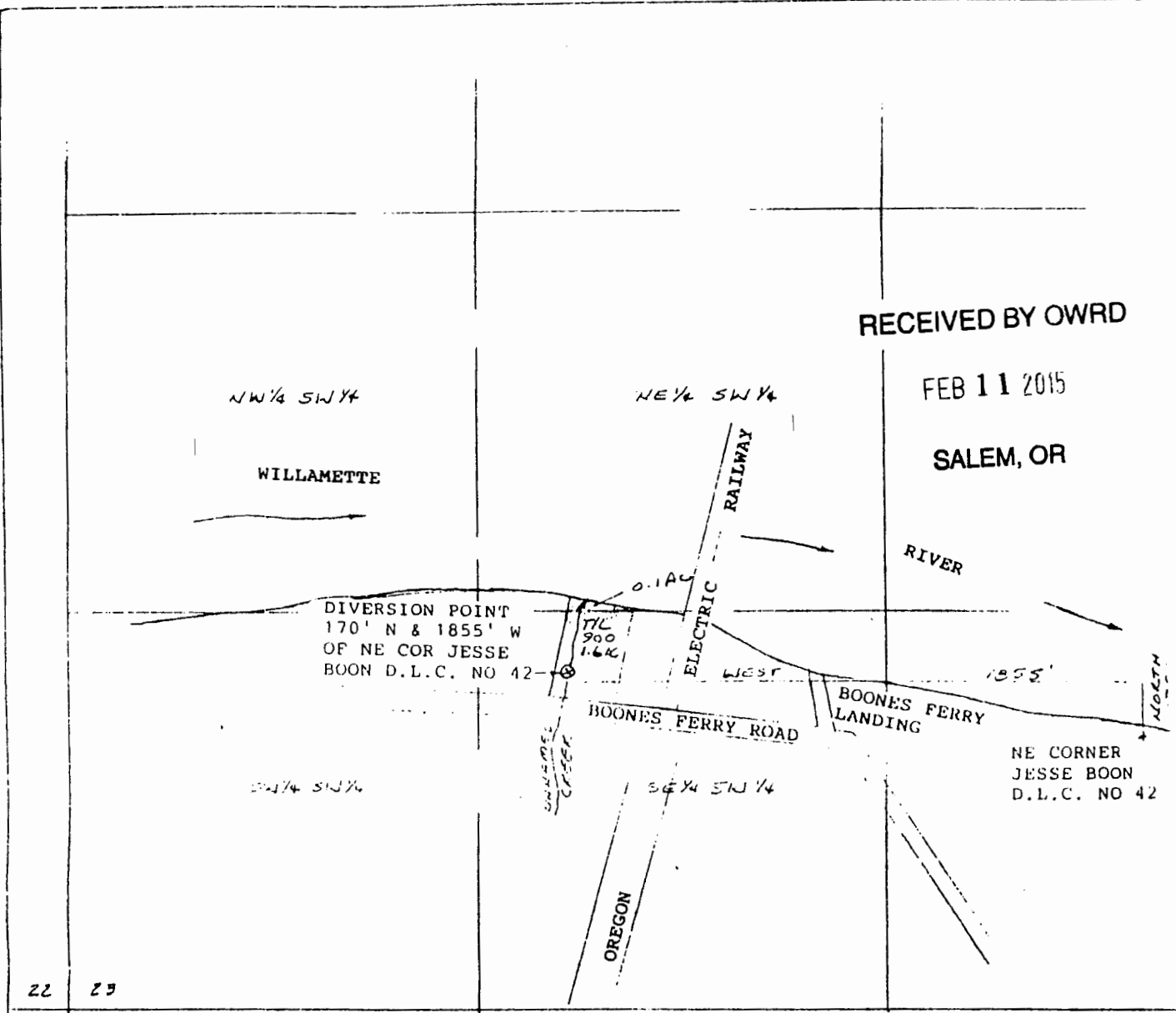

22 23

27 24

SURFACE WATER APPLICATION MAP FOR WILLIAM AND BETTY SAVAGE
 IN THE NE 1/4 OF THE SW 1/4 AND
 THE SE 1/4 OF THE SW 1/4 OF
 SECTION 23 T3S R1W W.M.
 CLACKAMAS COUNTY OREGON

FEBRUARY 26, 1990
 SCALE 1" = 400'

Gaylord Land Surveying
 15000 S.E. Linden Lane
 Milwaukie, Oregon 97267
 (503) 654 1100

Application No. ~~70000~~
 Permit No. ~~50000~~

R-84347