

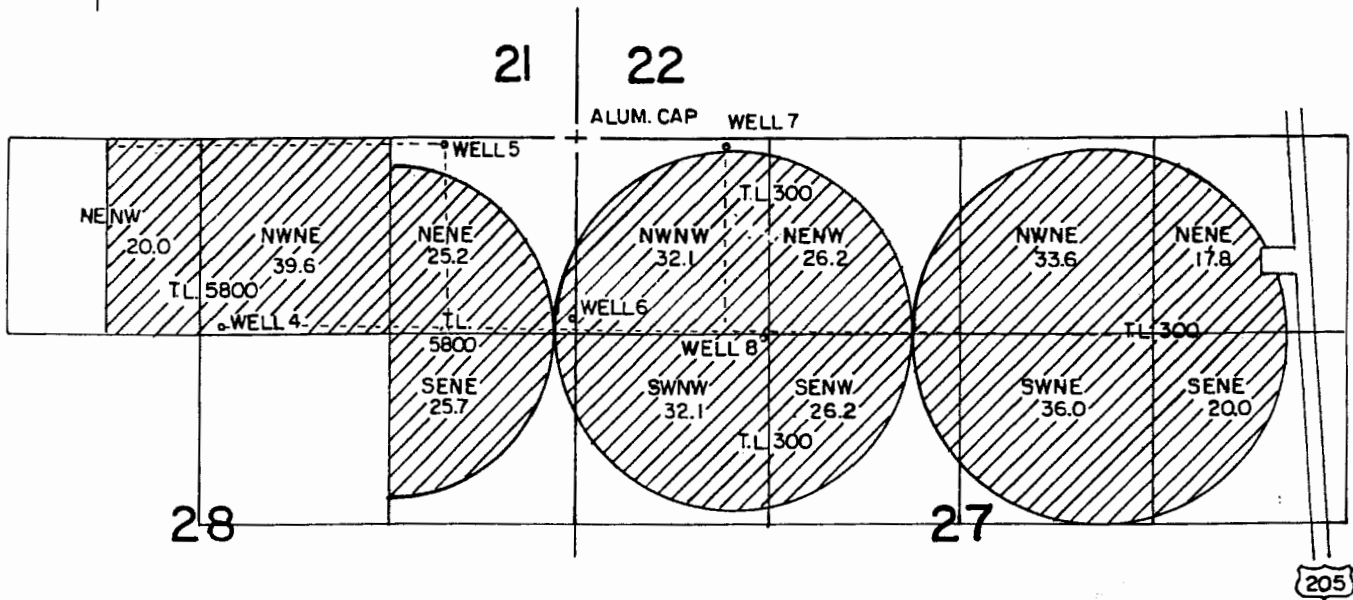

# T 25 S, R 31 E, WM



THE PURPOSE OF THIS MAP IS TO IDENTIFY THE LOCATION OF THE WATER RIGHT AND IS NOT INTENDED TO PROVIDE INFORMATION RELATIVE TO THE LOCATION OF PROPERTY OWNERSHIP.

### WELL LOCATIONS FROM THE CORNER COMMON TO SECTIONS 21, 22, 27, 28

- WELL 4 1295'S 2504'W
- WELL 5 64'S 985'W
- WELL 6 1271'S 2'W
- WELL 7 51'S 1030'E
- WELL 8 1341'S 1292'E

RECEIVED

AUG 10 2009

1047 2009-08-10

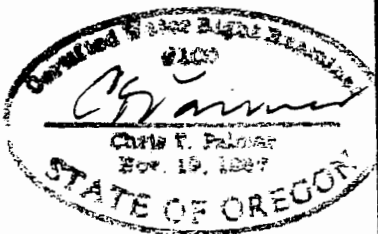

RENEW 1-1-2011

## FINAL PROOF SURVEY

UNDER T-10323 & 10324

IN THE NAME OF BEVERLY SAUCY

Scale: 4" = 1 MILE	Date: AUG. 2009	Job: 2285-09
Dsn:		Sht. No.
Drm: CHRIS		
Ckd:		of 1

M.A. PALMER & SONS, INC.  
ENGINEERING & SURVEYING  
711 Ponderosa Village • Box 61  
Burns, Oregon 97720