

$A = 3.84$
 $S = .001$
 $V = 1.23$
 $Q = 4.7 \text{ sec.ft.}$

Crosssection of Burkhead Dearinger Ditch

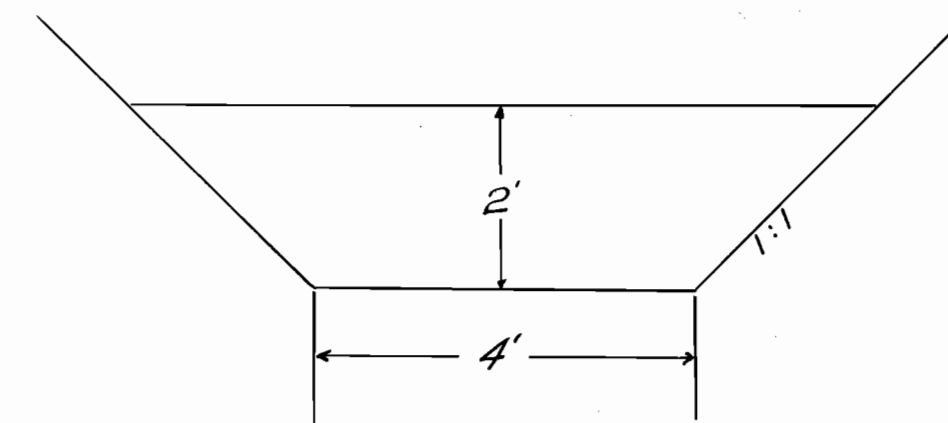

$A = 12.0$
 $S = .001$
 $V = 2.06$
 $Q = 24.7 \text{ sec.ft.}$

Cross section of Colt Ditch

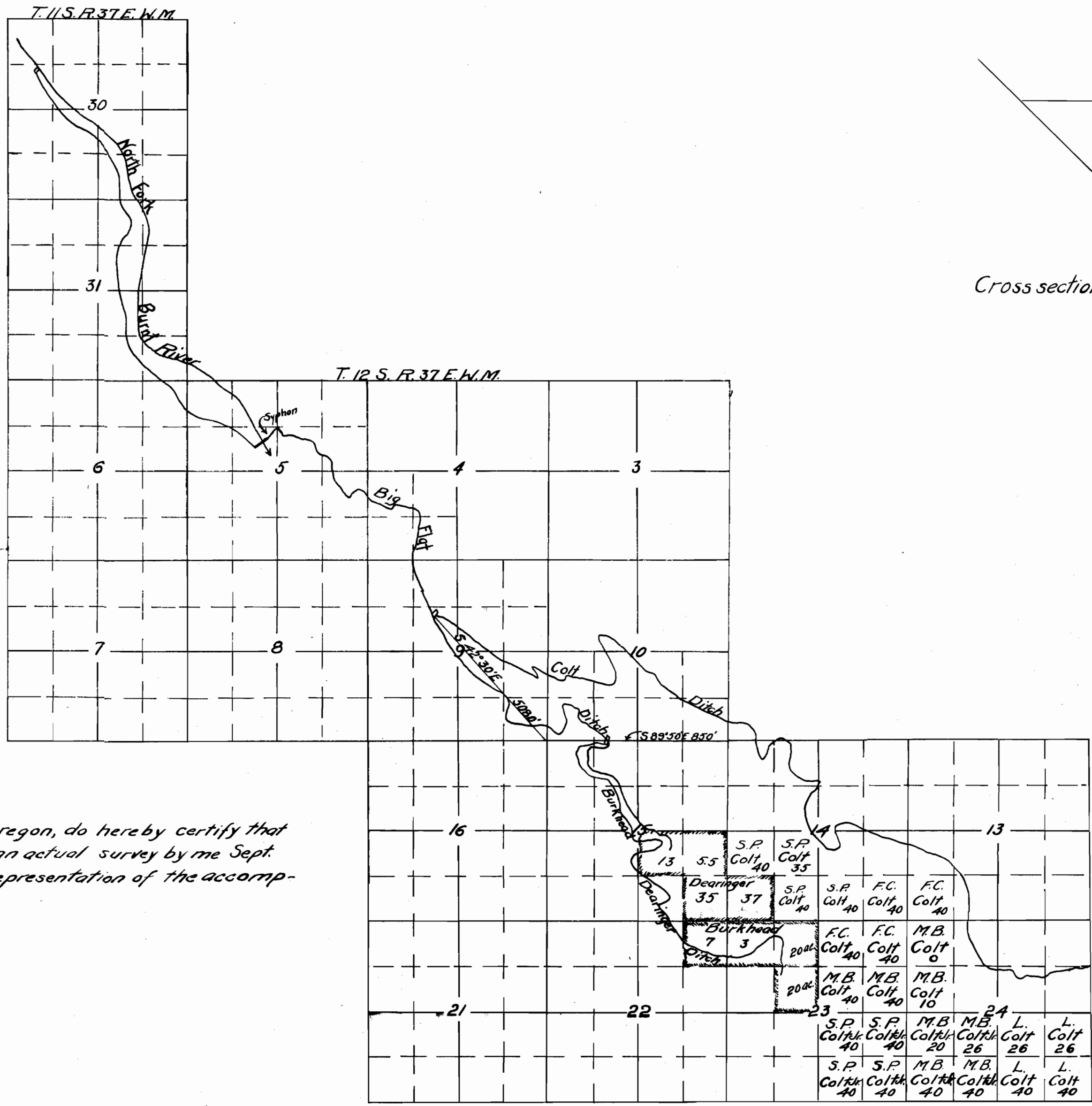

I, T.L. Borman, of Baker, Baker County, Oregon, do hereby certify that this map was made from the field notes of an actual survey by me Sept. 19th & 26, 1920, and that it is a correct representation of the accompanying application.



Map of Big Flat Ditch Enlargement and New Laterals Baker County, Oregon.

Application No. 7309
Permit No. 4827

FILED IN BAKER COUNTY OREGON
SEP 2 1920
SHERIFF

1920