

Final Proof Survey Map T 4 & 5 S R 1 W Portions of Sections 31 & 6

prepared for Marion County Dept. of Public Works
Environmental Services
Application # R-72924 & 72925
Permit # R-11627 & 51922

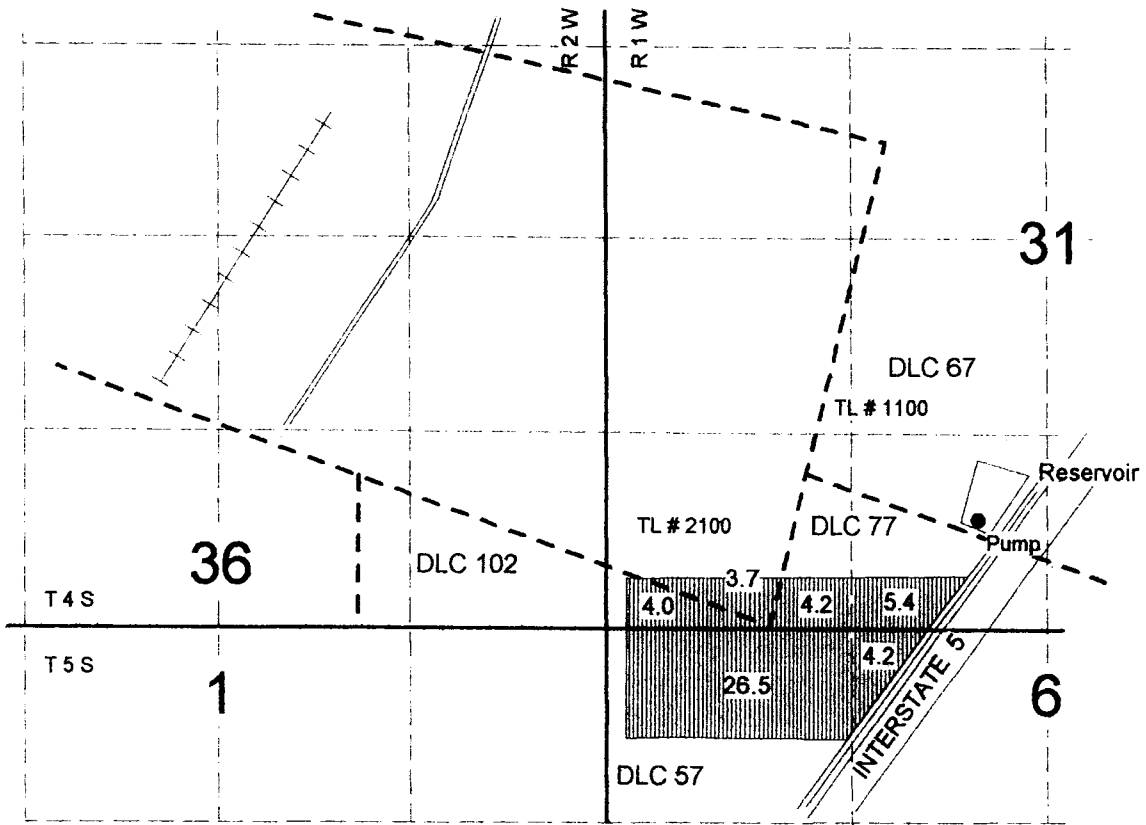

div. pt.; 740' N & 2550' E from the SW cor. sec.31

 supplemental irrigation

4" = 1 mile



0 2500

Don Knauer Consulting
PO Box 5416
Salem Oregon 97304
503-585-8474

This map is for water
right purposes only.

