

RECEIVED

NOV 07 2006

WATER RESOURCE DEPT
SALEM OREGON

FINAL PROOF SURVEY MAP

applications # R-84996 thru R-85003
permits # R-13305 thru R-13312
T 14 S R 2 W Section 7

Div. Pt. locations:
501-1: 180°N & 2160°W
501-2: 200°N & 2000°W
501-3: 100°N & 1300°W
501-4: 200°N & 240°W
601-1: 1250°S & 1410°E
601-2: 1250°S & 1410°E
601-3: 1250°S & 1410°E
601-4: 1250°S & 1410°E
As from C to corner

In the name of:
David A. Rogers

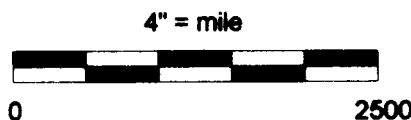
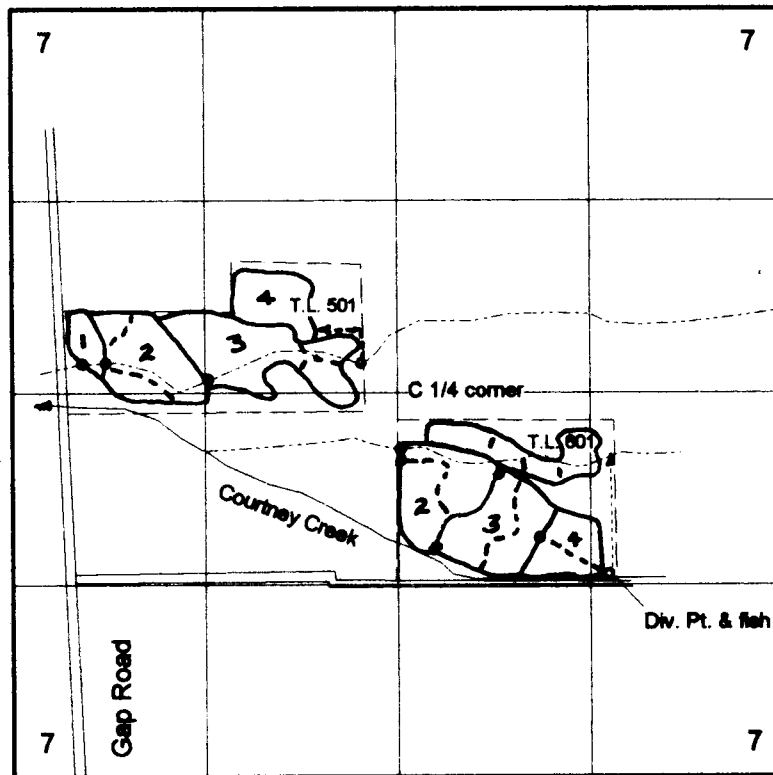
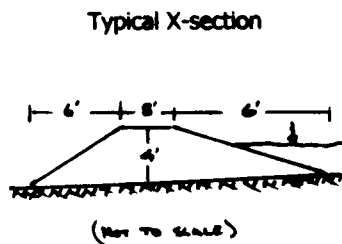

This map is for water right purposes only.

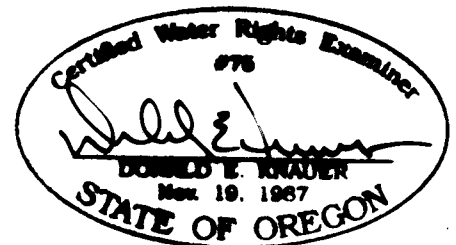

RENEWAL DATE: 6-30-2007