

RECEIVED

MAY 27 1997

WATER RESOURCES DEPT.
SALEM, OREGON

RECEIVED

JUL -3 1997

WATER RESOURCES DEPT.
SALEM, OREGON



TAX LOT 500
T: 3 South, R: 45, S: 2 - SW 1/4
WALLOWA COUNTY

Prairie Creek Rd.
2640'

T.L. 500

No. P-83488
Permit No. R12454

RECEIVED BY OWRD

FEB 18 2010

SALEM, OR

Knepper Rd.
2640'

Existing Diversion Attn Sheep Creek

Liberty Rd.
2640'

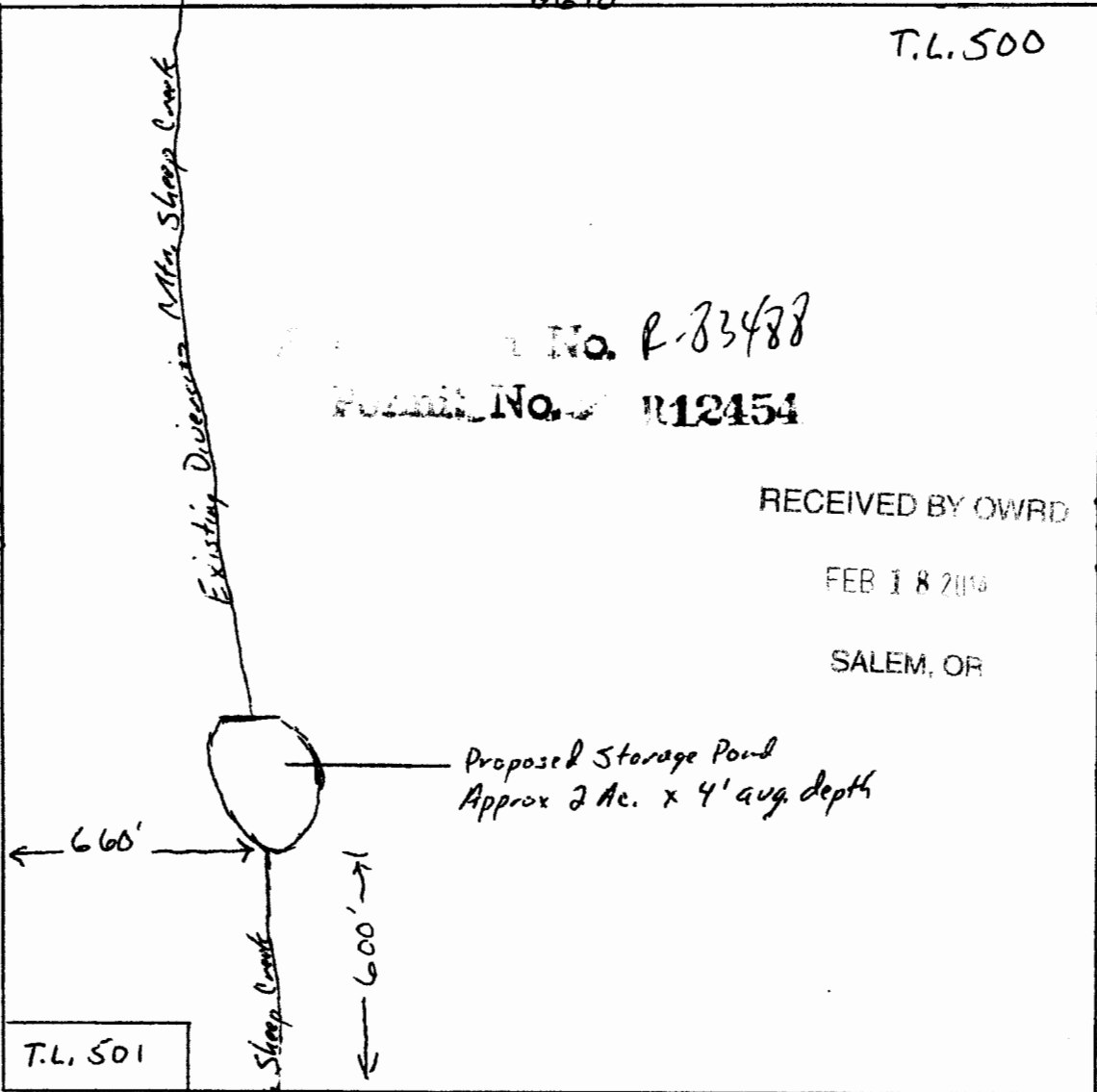

1" = 440'