

SECTION 28, T.4S., R.4W., W.M.
YAMHILL COUNTY, OREGON

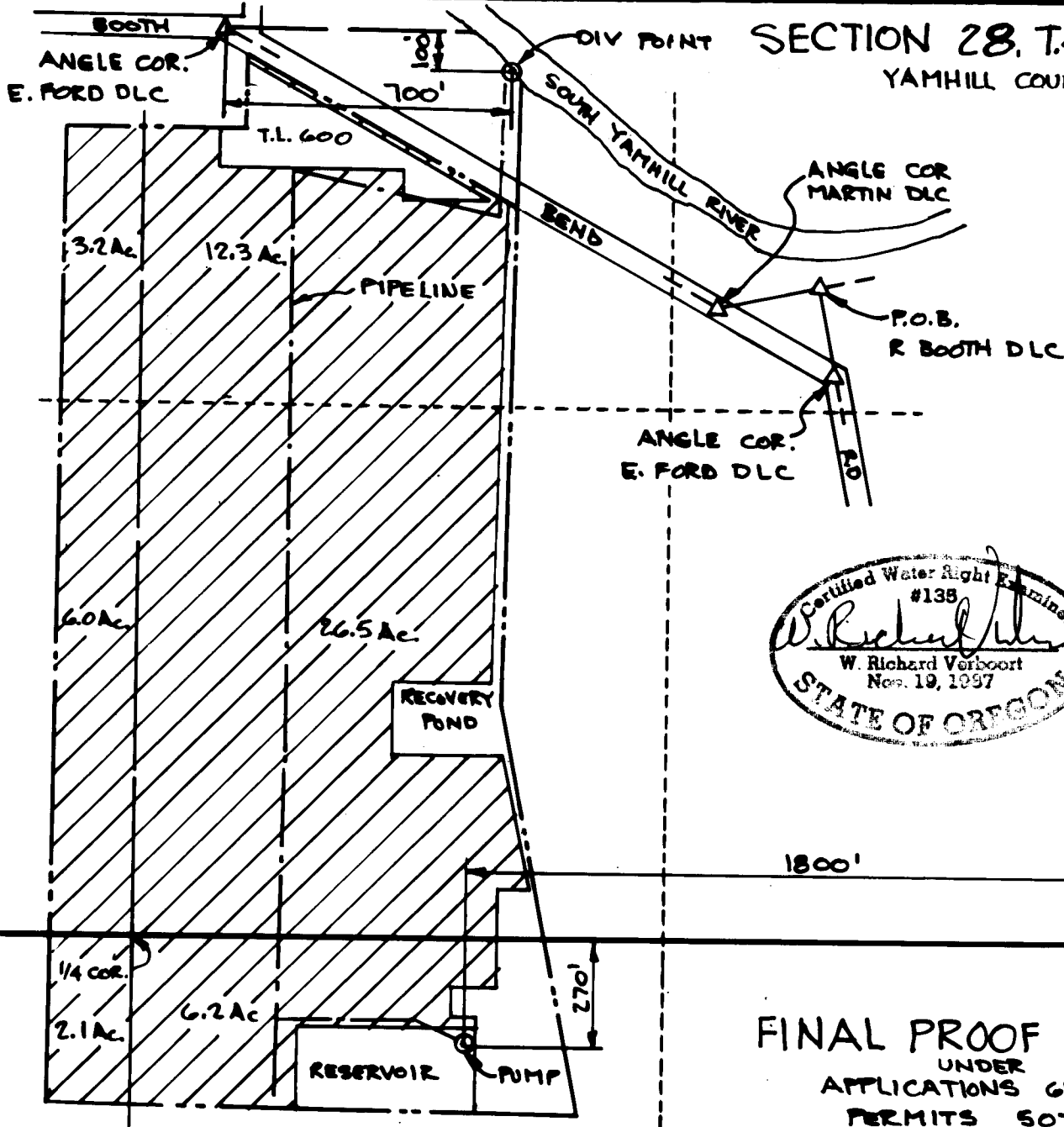

SCALE: 1"=400'
MAP BASE:
ASSESSORS MAP
WAC PHOTO

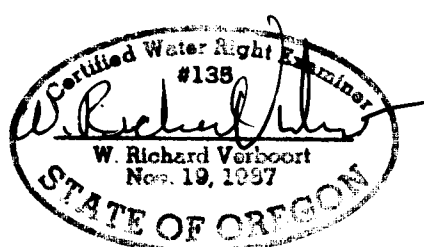

RECEIVED

SEP 18 2004

PREPARATION OF THIS MAP IS FOR THE PURPOSE OF IDENTIFYING THE LOCATION OF THE WATER RIGHT ONLY. THERE IS NO INTENT TO PROVIDE DIMENSIONS OR LOCATION OF PROPERTY OWNERSHIP LINES.

FINAL PROOF SURVEY
UNDER
APPLICATIONS 69723 R-69744
PERMITS 50713 R-11149
SURVEYED SEPTEMBER 22, 1998

28	27
33	34

C.V.H. LANDHOLDING
5380 SE BOOTH BEND RD
McMINNVILLE, OR 97128

by 0110
designed WRY 9-24-98
drawn JER 9-24-98
checked WRY 9-24-98
drawing no. 98-A-10
sheet no. 1/1

VERBOORT ENGINEERING
AGRICULTURE · CIVIL · WATER RESOURCES
HILLSBORO, OREGON