

TOWNSHIP 9 SOUTH, RANGE 2 EAST SECTION 25 & 36
 TOWNSHIP 9 SOUTH, RANGE 3 EAST SECTIONS 29, 30, 31 & 32

RECEIVED

APR 14 2006





WATER RESOURCES DEPT
 SALEM, OREGON

SCALE 1" = 1320'

THE PURPOSE OF THIS MAP IS TO IDENTIFY THE LOCATION OF THE WATER RIGHT. IT IS NOT INTENDED TO PROVIDE INFORMATION RELATIVE TO THE LOCATION OF PROPERTY OWNERSHIP BOUNDARY LINES.

APPLICATION G-16101
 PERMIT G-15608

EXPLANATION:

-  POINT OF APPROPRIATION (WELL)
-  PLACE OF USE
-  SERVICE AREA BOUNDARY
-  MAINLINES

Certified Water Right Examiner
 439 WRE
Steven R. Bruce
 STEVEN R. BRUCE
 JUNE 13, 1997
 Expires 12/31/2007
 STATE OF OREGON

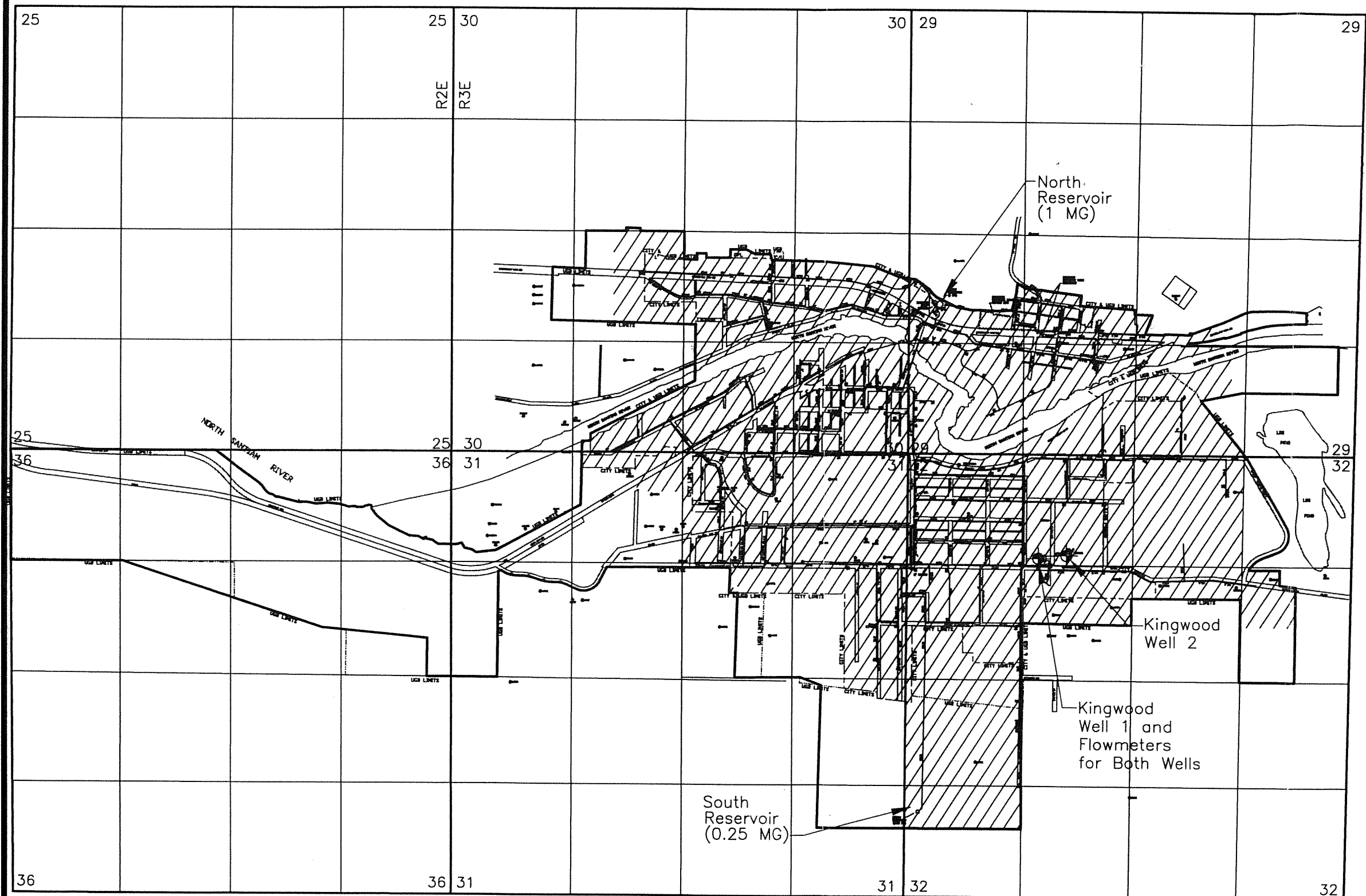

Notes:

1. Kingwood Well 1 located 1,240 feet south and 1,580 feet east of NW corner of Section 32.
2. Kingwood Well 2 located 1,200 feet south and 1,920 feet east of NW corner of Section 32.
3. Survey completed on March 8, 2006.

COBU MAP #0199

GEOENGINEERS 

CLAIM OF BENEFICIAL USE MAP
 CITY OF MILL CITY, OREGON

FIGURE 1

Portland\p:\10\10079001\01\Cad\COBU.dwg SRB:MWJ 04/06/06