

PERMIT NO. G-15092
 APPLICATION NO. G-15455

CLAIM OF BENEFICIAL USE MAP
 FOR
HENRY & PATRICIA O'KEEFFE
 SECTION 15, 20, AND 21, TOWNSHIP 41 SOUTH
 RANGE 12 EAST W.M.
 KLAMATH COUNTY, OREGON

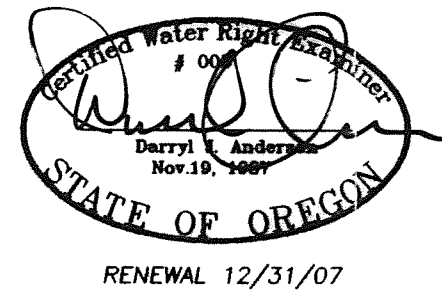
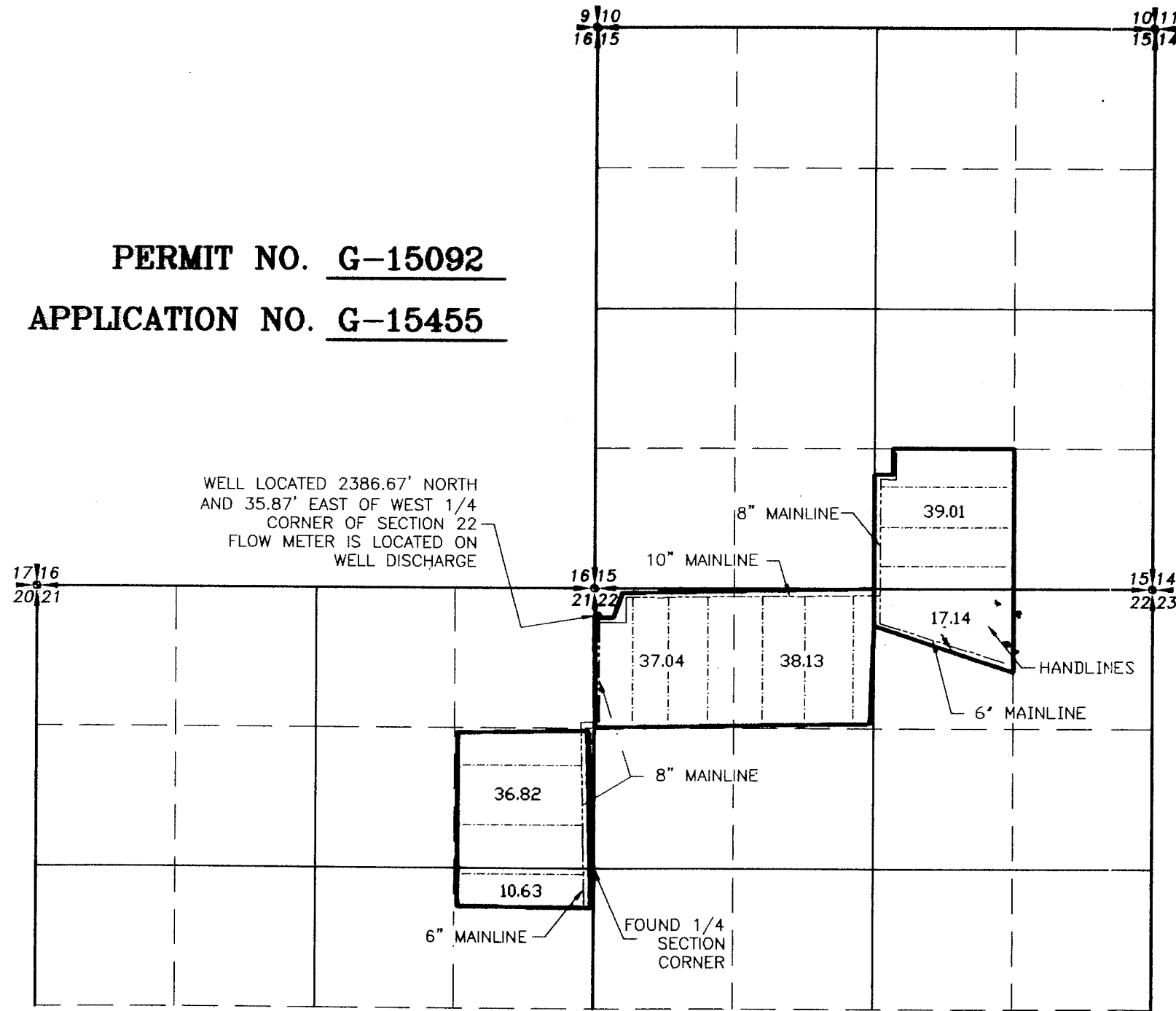

SCALE: 1"=1320'

- LEGEND**
- SECTION LINE
 - 1/4 SECTION LINE
 - 1/16 SECTION LINE
 - - - IRRIGATION MAIN LINE
 - - - WHEEL/HAND LINE

NOTE:
 PREPARATION OF THIS MAP IS FOR IDENTIFYING PROPOSED WATER RIGHTS ONLY. IT HAS NO INTENT TO PROVIDE LOCATIONS OR DIMENSIONS OF PROPERTY BOUNDARIES.

COBU MAP # 0211

RECEIVED
 JUL 17 2006
 WATER RESOURCES DEPT
 SALEM, OREGON

REVISION	BY

ANDERSON ENGINEERING AND SURVEYING, INC.
 P.O. BOX 28
 LAKEVIEW, OREGON 97630
 (541) 947-4407
 FAX 947-2321

P.O. BOX 418
 REDMOND, OREGON 97756
 (541) 923-4307
 FAX 923-4308

FOR: **HENRY & PATRICIA O'KEEFFE**
 PO BOX 286
 MALIN, OR 97632
 (541) 728-8091

FINAL PROOF
PERMIT G-15092
APP. G-15455

DATE:	5/18/2006
SCALE:	1"=1320'
DWG. BY:	R.C.
JOB:	2006-081
FILE:	2006-081
SHEET:	1