

CLAIM OF BENEFICIAL USE MAP IN THE NAME OF DUANE BROWN AND BILL ZERBACH

APPLICATION S-86235 PERMIT S-54276

TOWNSHIPS 26 SOUTH, RANGE 3 WEST, W.M., SECTION 9, SE1/4 SW1/4

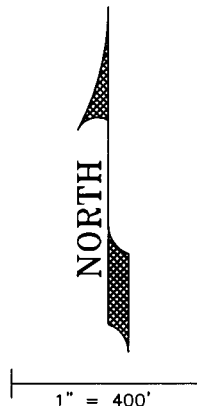
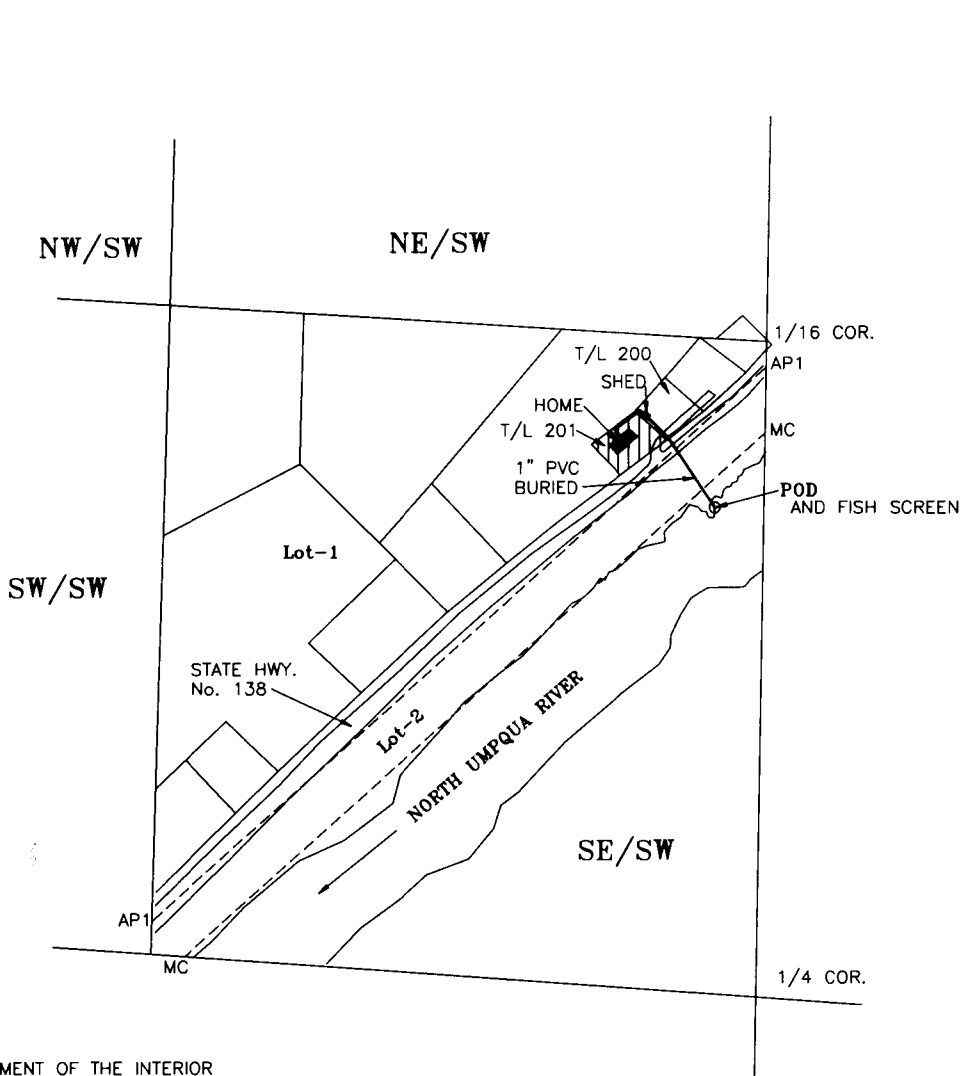

RECEIVED
MAY 14 2004
JORDAN ENGINEERING

PER DEPARTMENT OF THE INTERIOR
GENERAL LAND OFFICE 8-9-1926
SURVEY 1-28-1926

AP1 & 2 = BLM'S ANGLE POINT
MC = BLM'S MEANDERING CORNER
----- GOVERNMENT LOT LINE

POD COORDINATES:
SW1/4 SW1/4 S9, T26S, R3W
1020 FEET NORTH AND 85 FEET
WEST FROM S1/4 CORNER.

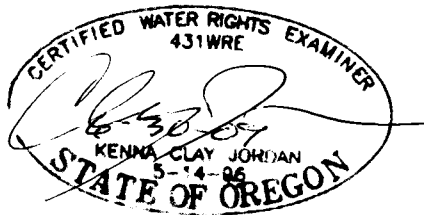

LOCATIONS PER 1/4 1/4 ARE DERIVED BY ASSUMED FIT
OF AERIAL PHOTO ORIENTATION TO GROUND SURVEYS
AND/OR TAX ASSESSOR MAPS.

THE PURPOSE OF THIS MAP IS TO IDENTIFY THE LOCATION OF THE WATER RIGHT.
IT IS NOT INTENDED TO PROVIDE INFORMATION RELATIVE TO THE LOCATION OF
PROPERTY OWNERSHIP BOUNDARY LINES.

JORDAN ENGINEERING
460 JORDAN LANE
ROSEBURG, OR 97470
(541) 673-1931
6-12-08