

Final Proof Survey Map

T 4 & 5 S R 1 & 2 W

Portions of sections 31, 36, 1, 6

prepared for Marion County Dept. of Public Works
 Environmental Services
 Application G-13166 Permit G-11757

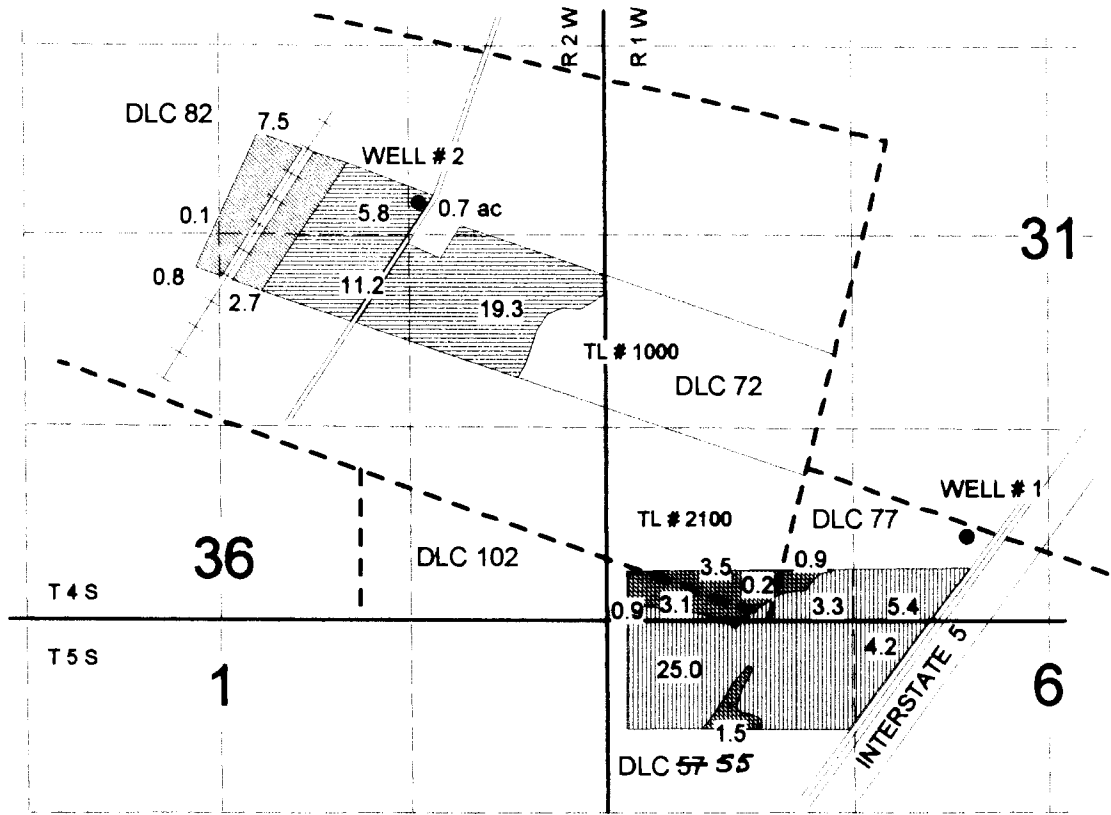

- | | | | |
|--|---|--|---|
| | <i>supplemental</i>
well #1 irrigation | | <i>primary</i>
well #1 supplemental irrigation |
| | well #2 irrigation | | well #2 agricultural |

well #1 = 590' N & 2450' E
 well #2 = 2870' N & 1260' W
 both from the SW corner section 31

4" = 1 mile



Don Knauer Consulting
 PO Box 5416
 Salem Oregon 97304
 503-585-8474

This map is for water
 right purposes only.

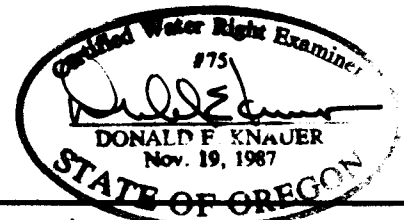

*This map has been revised
 by WRD to reflect DLC 55 in section 6,
 and the type of irrigation (primary &
 supplemental) for WELL 1. MB/WRD 3-30-15*