

CLAIM OF BENEFICIAL USE MAP
 FOR MORAND POND,
 TUALATIN RIVER NATIONAL WILDLIFE REFUGE
 LOCATED IN SECTION 16,
 T. 2 S., R. 1 W., W.M.,
 WASHINGTON COUNTY, OREGON

APPLICATION R-84813 PERMIT NO. R-13319
 TAX LOT 2650

RECEIVED
 10/5/08
 WATER RESOURCES DEPT
 SALEM, OREGON

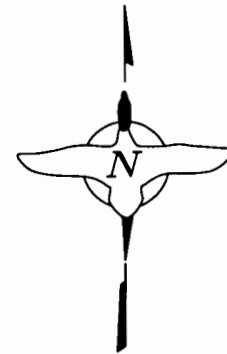
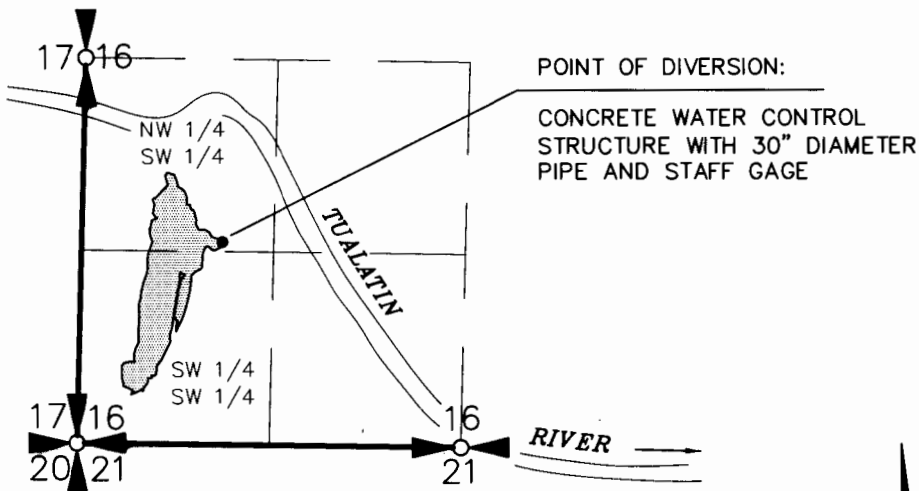

OREGON NORTH ZONE NAD 83
 THETA = $-1^{\circ}38'54''$

POINT OF DIVERSION IS 1364 FEET
 NORTH AND 996 FEET EAST OF THE
 SOUTHWEST CORNER OF SECTION 16,
 T2S R1W WM

Certified Water Right Examiner
 46944 WRE
David Hill
 DAVID HILLS
 JULY 11, 2006
 STATE OF OREGON

10/5/08

Renews 6/30/2009

THE PURPOSE OF THIS MAP IS TO IDENTIFY
 THE LOCATION OF THE WATER RIGHT. IT IS
 NOT INTENDED TO PROVIDE INFORMATION
 RELATIVE TO THE LOCATION OF PROPERTY
 OWNERSHIP BOUNDARY LINES.

SCALE: 1"=1320'