

**CLAIM OF BENEFICIAL USE & FINAL PROOF MAP
 LOCATED IN THE NW¼ SW¼ OF SECTION 4,
 TOWNSHIP 25 SOUTH, RANGE 12 WEST, W.M.
 APPLICATION S-87006, PERMIT 54521
 COOS COUNTY, OREGON**

PREPARED FOR: JASON & AIMEE FINNIGAN
 PREPARED BY: DENNIS GOUDE
 DATE PREPARED: MARCH 2, 2009



NOTE:
 THE POINT OF DIVERSION IS AN INSPIRING
 CONCRETE CATCH BASIN 4'X2'X1' LOCATED
 1909 FEET NORTH AND 1564 FEET EAST
 FROM THE SOUTHWEST CORNER OF SECTION 4,
 TOWNSHIP 25 SOUTH, RANGE 12 WEST, W.M.

LEGEND

POB
 (POINT OF BEGINNING)

POD
 (POINT OF DIVERSION)

BUILDINGS
 (NOT TO SCALE)

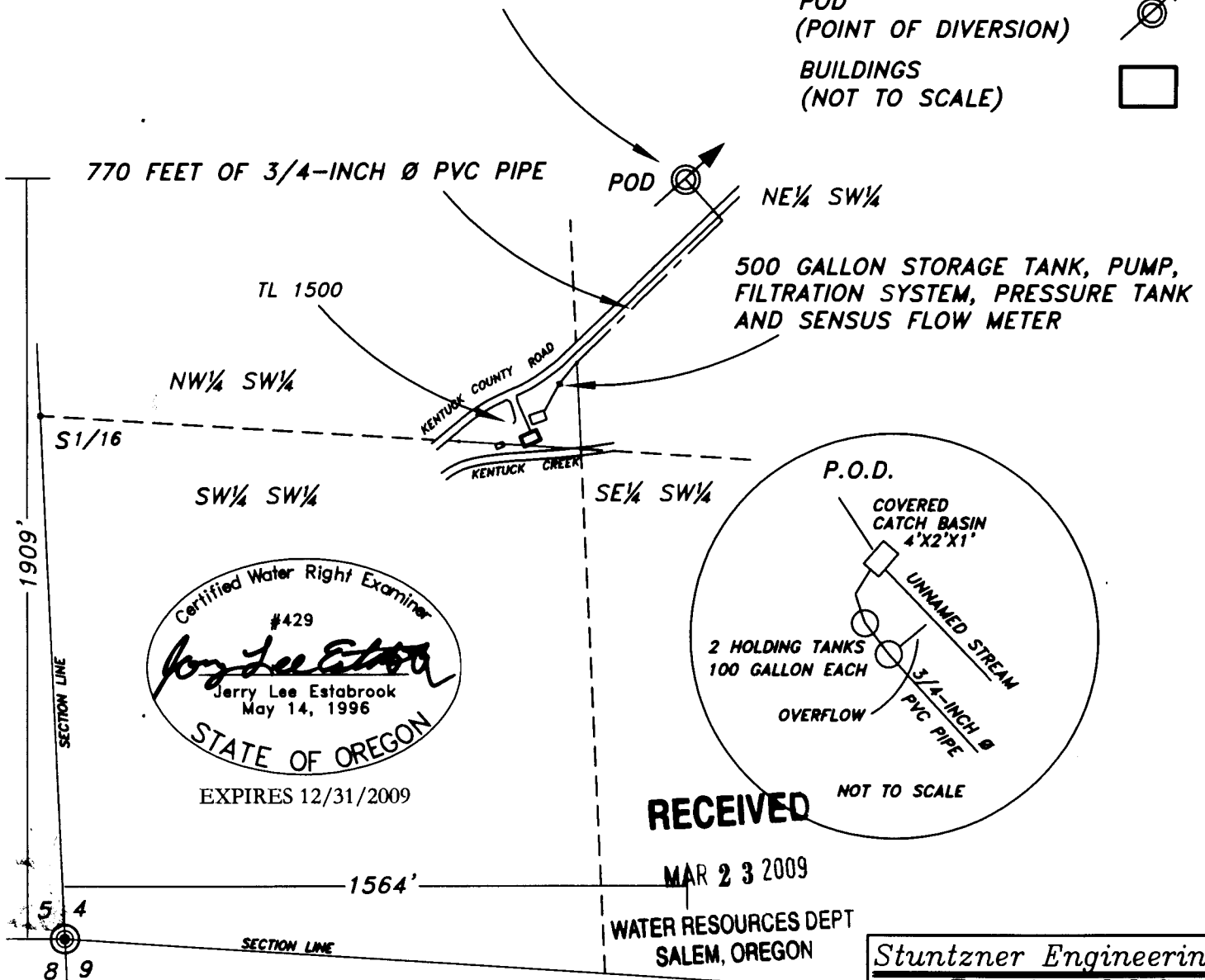

RECEIVED

MAR 23 2009

WATER RESOURCES DEPT
 SALEM, OREGON

**Stuntzner Engineering
 & Forestry, L.L.C.**

ENGINEERING • LAND SURVEYING • FORESTRY
 PLANNING • WATER RIGHTS

705 South 4th St.
 Post Office Box 118
 Coos Bay, Oregon 97420

Phone: (541) 267-2872
 Fax: (541) 267-0588

EXAMINERS DISCLAIMER STATEMENT

The preparation of this map was for the purpose of identifying the location of the Water Right only and has no intent to provide dimensions or location of property ownership lines.