



CLAIM OF BENEFICIAL USE & FINAL PROOF MAP  
 LOCATED IN THE SE¼ NW¼ OF SECTION 15,  
 TOWNSHIP 30 SOUTH, RANGE 12 WEST, W.M.  
 APPLICATION S-86621, PERMIT 54598  
 COOS COUNTY, OREGON

1" = 400 FEET

**LEGEND**

- POB  
(POINT OF BEGINNING) 
- POD  
(POINT OF DIVERSION) 
- RESIDENCE  
(NOT TO SCALE) 

PREPARED FOR: LARRY G. BULLARD  
 PREPARED BY: DENNIS GOUDE  
 DATE PREPARED: SEPT. 24, 2009

RECEIVED

09 04 2009

WATER RESOURCES DEPT  
 SALEM, OREGON

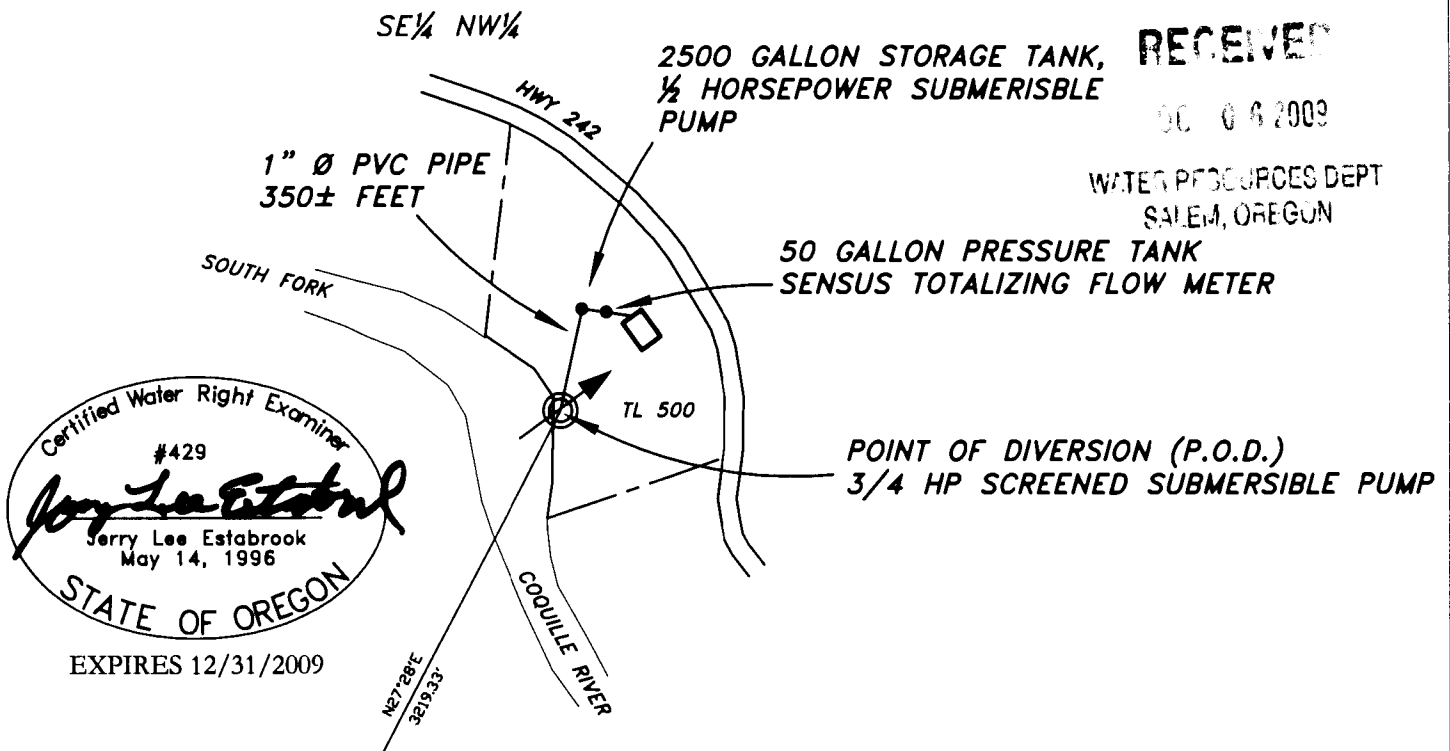

Certified Water Right Examiner  
 #429  
*Jerry Lee Estabrook*  
 Jerry Lee Estabrook  
 May 14, 1996  
 STATE OF OREGON  
 EXPIRES 12/31/2009

**NOTE:**  
 THE POINT OF DIVERSION IS AN INSTREAM  
 SUBMERSIBLE 3/4 HP PUMP, WITH 3/32 INCH  
 MESH SCREEN AND IS LOCATED NORTH 27°28' EAST  
 3219 FEET FROM THE SW CORNER OF SECTION 15,  
 TOWNSHIP 30 SOUTH RANGE 12 WEST, W.M.

**EXAMINERS DISCLAIMER STATEMENT**

The preparation of this map was for the purpose of identifying the location of the Water Right only and has no intent to provide dimensions or location of property ownership lines.

**Stuntzner Engineering & Forestry, L.L.C.**  
 ENGINEERING • LAND SURVEYING • FORESTRY  
 PLANNING • WATER RIGHTS  
 705 South 4th St.  
 Post Office Box 118  
 Coos Bay, Oregon 97420  
 Phone: (541) 267-2872  
 Fax: (541) 267-0622