

Townships 5 & 6 South, Range 1 West, W.M.

Portions of Sections 33, 34 & 35 in Township 5 South
& Sections 2 & 3 & the East 1/2 of Section 4 in Township 6 South

RECEIVED
SEP 29 2000

AUG 09 2011

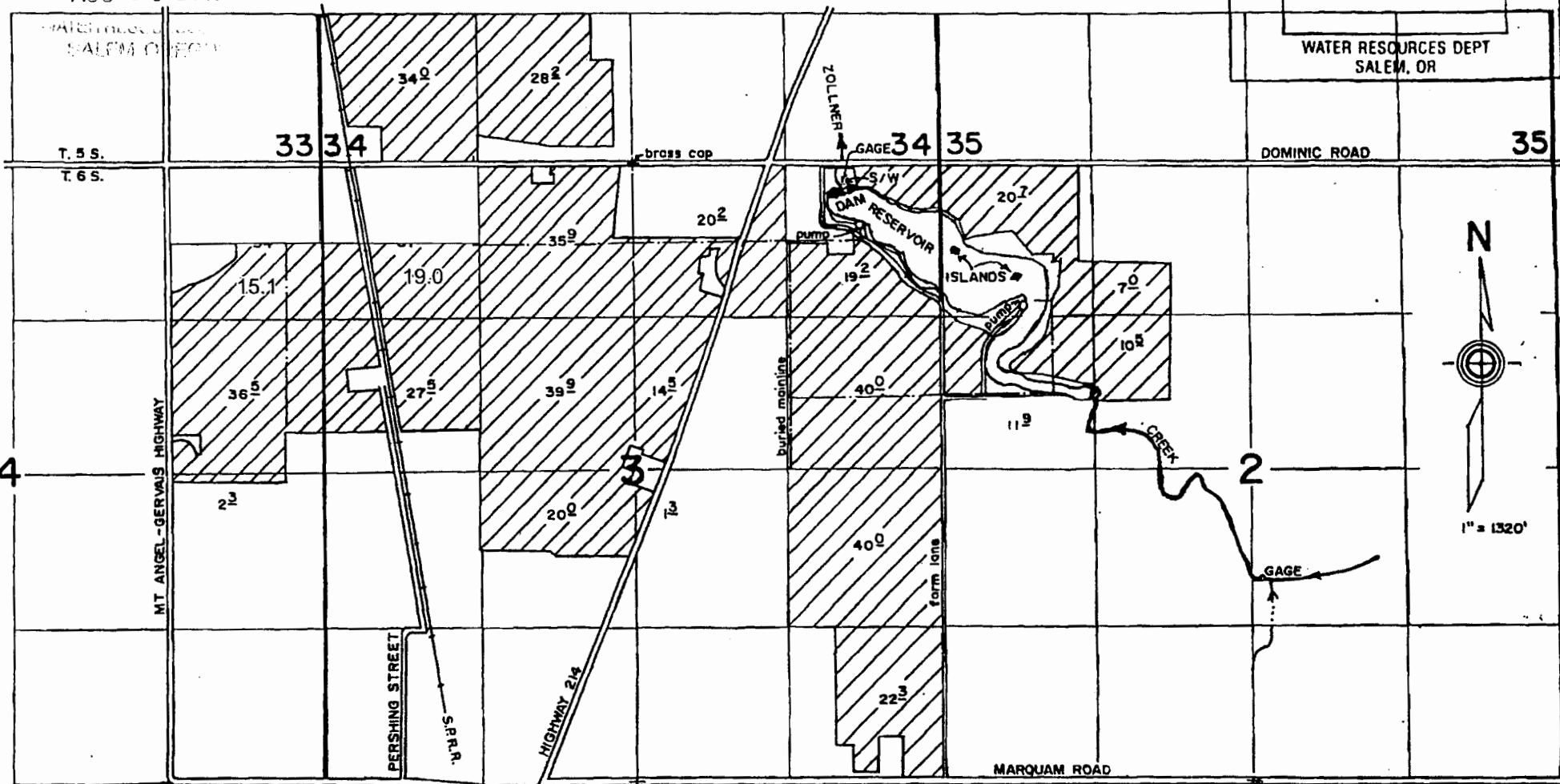

WATER RESOURCES DEPT
SALEM, OR

DAM LOCATED 250' S. & 1750' E.
PUMPS LOCATED: 520' S. & 1950' E. and 1210' S. & 3370' E.
ALL FROM N. 1/4 COR. SEC. 3.

FINAL PROOF SURVEY
under

Revised Claim of Beneficial Use Map
12/2/2009

Appl. No. 72037, Per. No. 52836
R-72038 R-12051
in name of
KRAEMER FARMS

Sep. 25, 2000

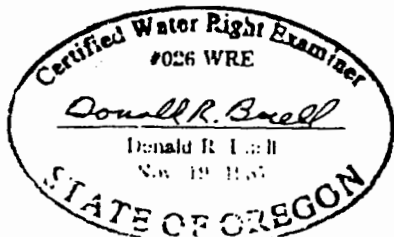

THIS MAP WAS PREPARED FOR THE PURPOSE OF IDENTIFYING THE LOCATION OF A WATER RIGHT ONLY AND IS NOT INTENDED TO PROVIDE LEGAL DIMENSIONS OR LOCATION OF PROPERTY OWNERSHIP LINES.