

**FINAL PROOF SURVEY MAP
IN THE NAME OF:
FORREST RANCH MOBILE HOME PARK**

Application S-84224 Permit S-53807

SECTION 10, TOWNSHIP 26 SOUTH, RANGE 3 WEST, W.M.

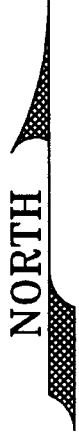

1"=1320'

AREA OF DOMESTIC USE FOR 111 HOUSEHOLDS.

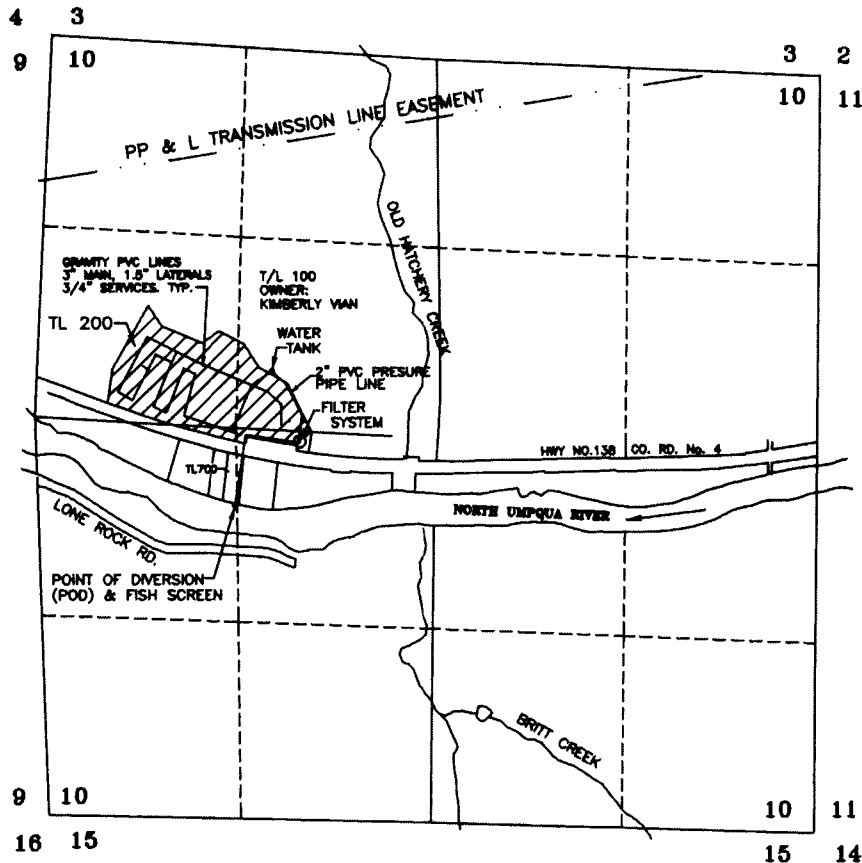

THE POINT OF DIVERSION IS LOCATED 3256 SOUTH AND 1248 EAST FROM THE NORTHWEST CORNER OF SECTION 10; BEING WITHIN THE NW1/4 SW1/4 OF SECTION 10, TOWNSHIP 26 SOUTH, RANGE 3 WEST, W.M. DOUGLAS COUNTY.

RECEIVED

OCT 30 2006

WATER RESOURCES DEPT
SALEM, OREGON

CERTIFIED WATER RIGHTS EXAMINER
431WRE
Kenna Clay Jordan
6-30-07
KENNA CLAY JORDAN
5-14-96
STATE OF OREGON

THE PURPOSE OF THIS MAP IS TO IDENTIFY THE LOCATION OF THE WATER RIGHT. IT IS NOT INTENDED TO PROVIDE INFORMATION RELATIVE TO THE LOCATION OF PROPERTY OWNERSHIP BOUNDARY LINES.