

FINAL PROOF SURVEY MAP IN THE NAME OF WALTER BELDEN

APPLICATION R-72430
APPLICATION S-72731

PERMIT R-12102
PERMIT 52998

AJP

SECTION 12, TOWNSHIP 30 SOUTH, RANGE 15 WEST, W.M.

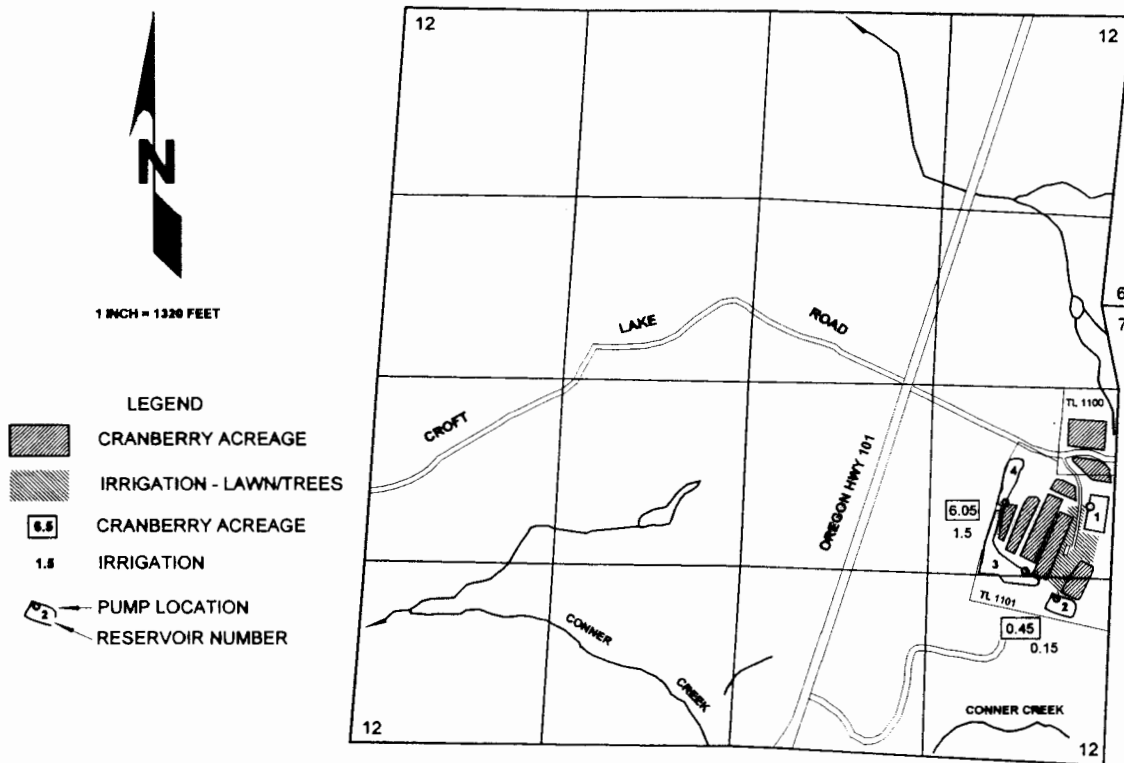

LOCATION OF RESERVOIRS:

- No. 1: 1775 FEET NORTH AND 40 FEET WEST;
- No. 2: 1060 FEET NORTH AND 320 FEET WEST;
- No. 3: 1400 FEET NORTH AND 700 FEET WEST; AND
- No. 4: 2025 FEET NORTH AND 635 FEET WEST.

POINT OF DIVERSION FROM RESERVOIRS:

- No. 1: 1810 FEET NORTH AND 90 FEET WEST; WITHIN THE NE $\frac{1}{4}$ SE $\frac{1}{4}$;
- No. 2: 1165 FEET NORTH AND 325 FEET WEST; WITHIN THE SE $\frac{1}{4}$ SE $\frac{1}{4}$;
- No. 3: 1360 FEET NORTH AND 535 FEET WEST; WITHIN THE NE $\frac{1}{4}$ SE $\frac{1}{4}$ AND
- No. 4: 1835 FEET NORTH AND 670 FEET WEST; WITHIN THE NE $\frac{1}{4}$ SE $\frac{1}{4}$;

ALL FROM THE SOUTHEAST CORNER OF SECTION 12 AND WITHIN SECTION 12, TOWNSHIP 30 SOUTH, RANGE 15 WEST, W.M.; COOS COUNTY,

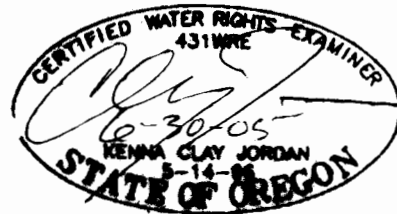

RECEIVED

JUL 12 2005

WATER RESOURCES DEPT
SALEM, OREGON