

**Township 33 S. Range 10 W. and 11 W. W.M.  
Curry County**

**Claim of Beneficial Use For  
Half Moon Bar Lodge**

**Application # S-83391**

**Permit # 53438**

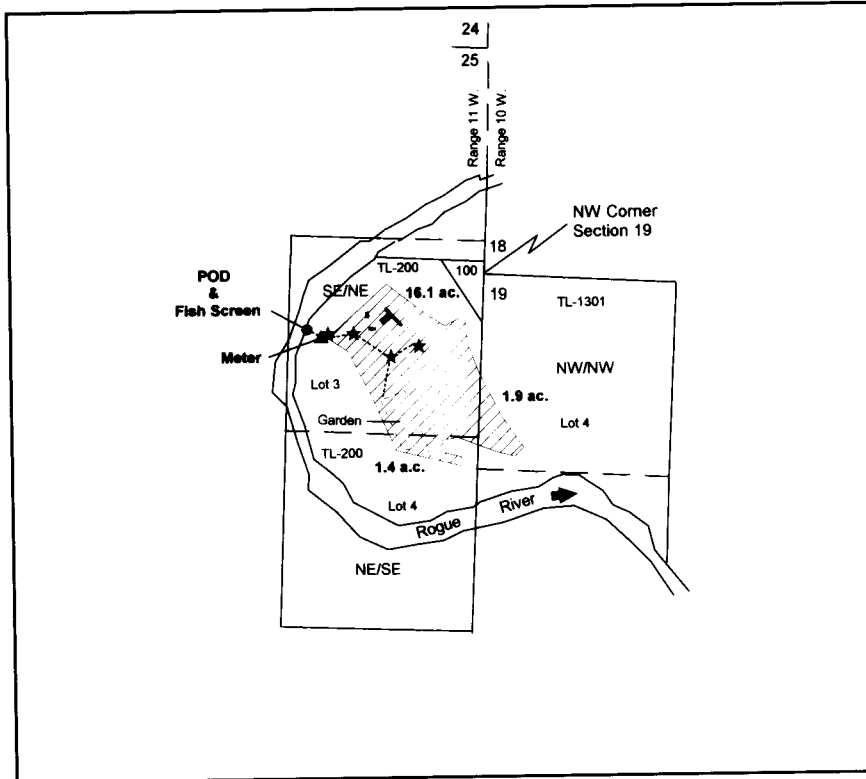

POD - 430 feet South and 1205 feet West from the NW Corner Section 19, T33 South R10 West, WM.

**RECEIVED**

NOV 15 2006

WATER RESOURCES DEPT  
SALEM, OREGON

**Scale 1 inch = 1320 feet**

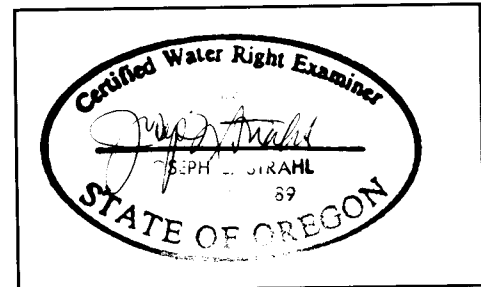
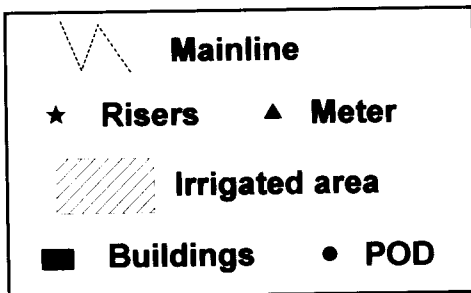

Property and irrigation system inspected  
September 13 & 14, 2006

Map 10/17/2006

n.e.d.

This map is for the purposes of identifying the location of the water right only and is not intended to provide legal dimensions or locations of property ownership lines.