

# CLAIM OF BENEFICIAL USE

APPLICATION S-86286

PERMIT S-54298

IN THE NAME OF CHARLES SPOONER

TOWNSHIP 26 SOUTH RANGE 4 WEST, W.M.

DOUGLAS COUNTY OREGON

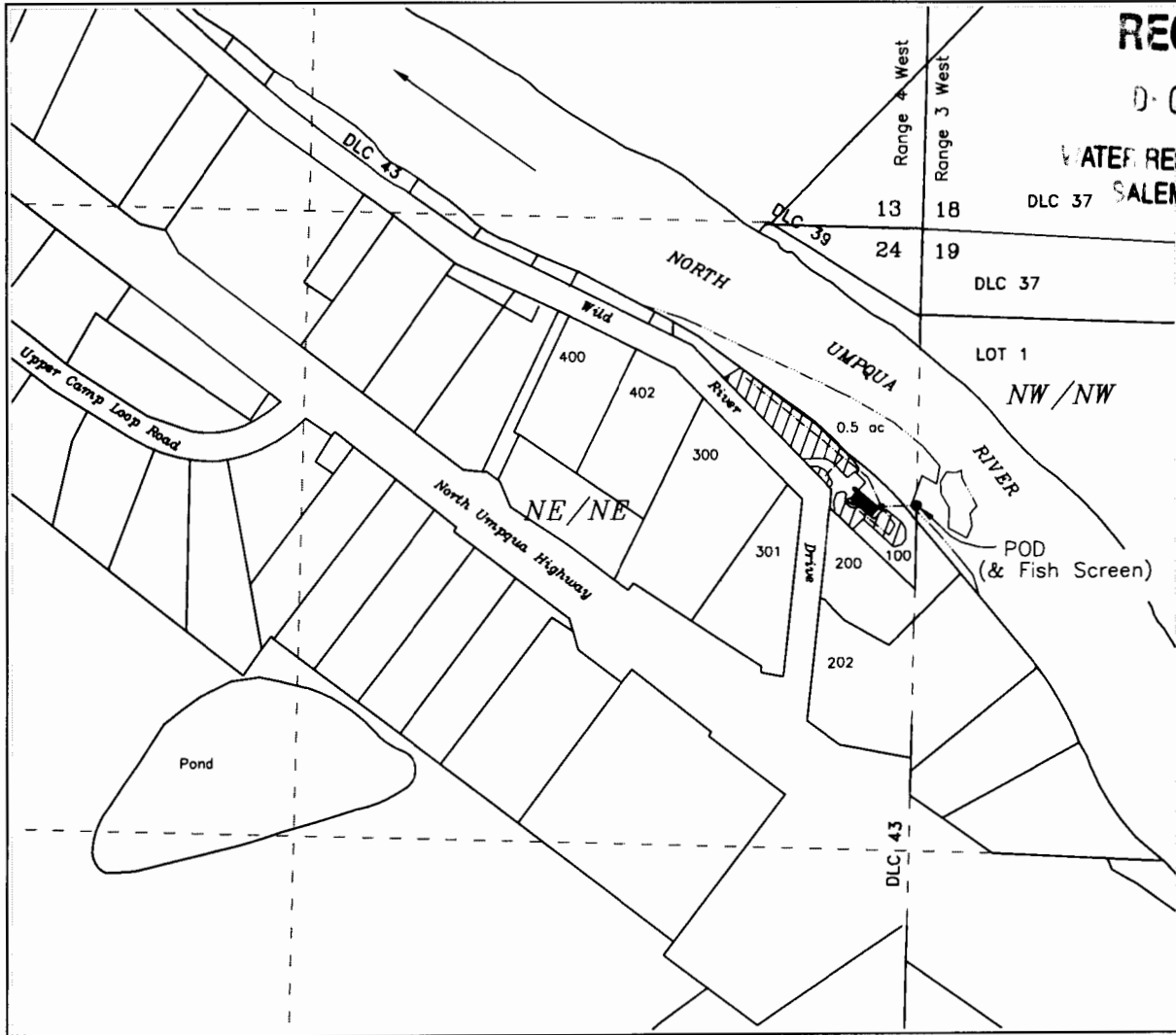

**RECEIVED**

0-018 2009

WATER RESOURCES DEPT  
DLC 37 SALEM, OREGON

P.O.D. - Pump location - DLC 43, NE/NE Section 24, 595 feet south & 0.0 feet west from the NE corner section 24, T26S, R4W, W.M.

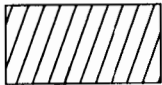

Irrigated area 0.50 acres

Scale  
1 inch = 400 feet



Base map - Douglas County GIS tax lots with 2005 FSA aerial photo overlay with assumed best fit

For purpose of locating POD (Pump) Cardinal directions are in reference from point of beginning (NE COR Section 24) extending along it's boundary lines

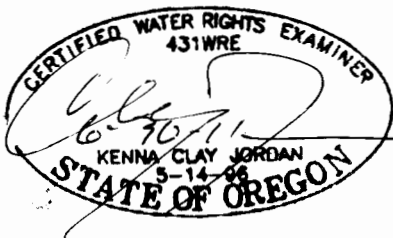

JORDAN ENGINEERING  
460 JORDAN LANE  
ROSEBURG, OR 97471  
(541) 673-1931

This map is not intended to provide legal dimensions or locations of property ownership lines

Revised Nov 6, 2009 n.e.d.