

**CLAIM OF BENEFICIAL USE MAP FOR CACKLER MARSH,
BASKETT SLOUGH NATIONAL WILDLIFE REFUGE
LOCATED IN SECTIONS 14 AND 23,
T. 7 S., R. 5 W., W.M., POLK COUNTY, OREGON
UNDER APPLICATION NO. R-74272 AND PERMIT NO. R-14175
IN THE NAME OF U.S FISH AND WILDLIFE SERVICE
SURVEYED SEPTEMBER 21&25, 2006
BY MINISTER AND GLAESER SURVEYING, INC**

APR 05 2008

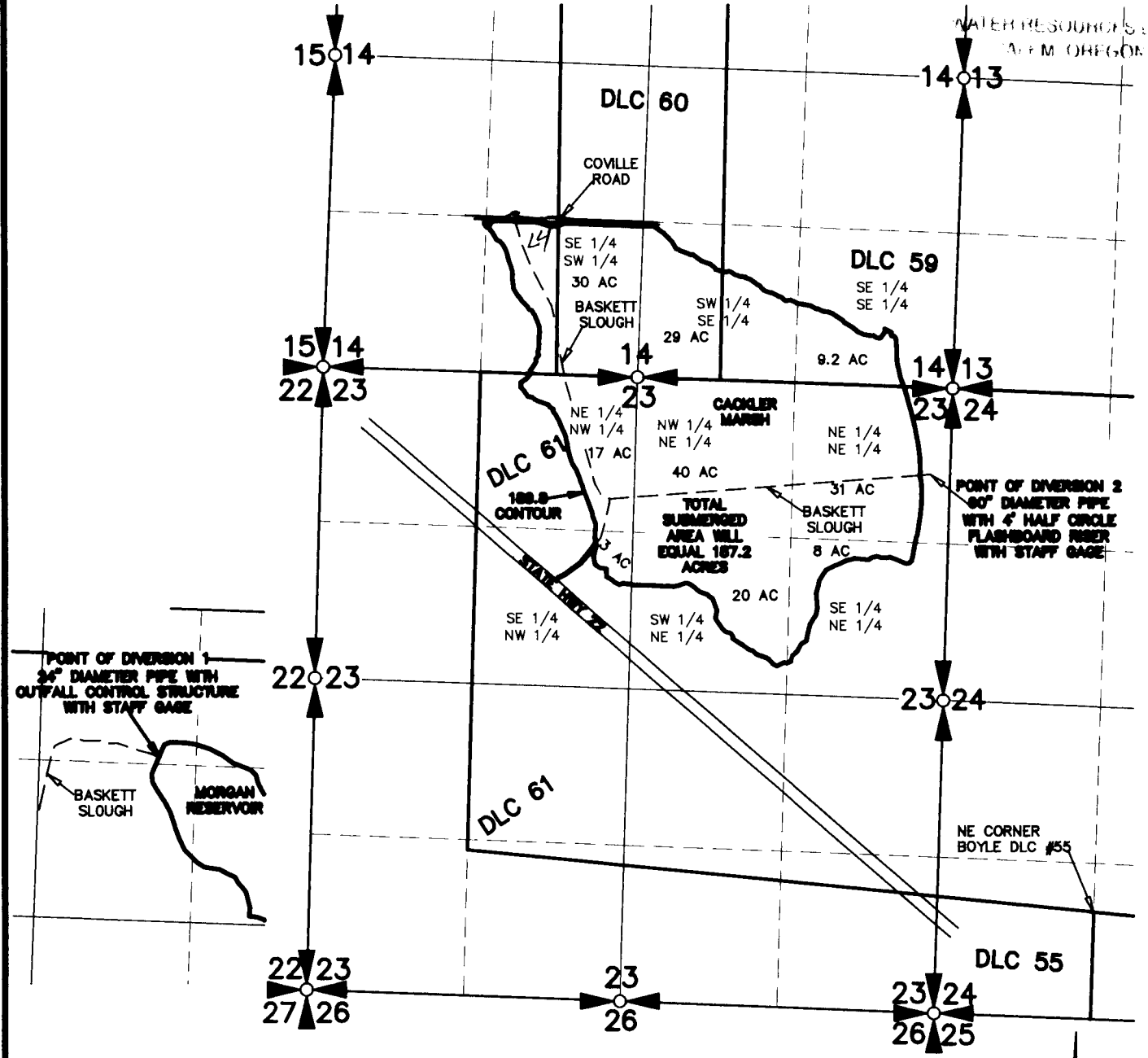

POINT OF DIVERSION 1 (MORGAN RESERVOIR DAM) IS N10°08'17"W, 13,997 FEET FROM THE NE CORNER OF THE J.W. BOYLE D.L.C. NO. #55

POINT OF DIVERSION 2 (CACKLER DAM) IS N21°37'40"W, 3961 FEET FROM THE NE CORNER OF THE J.W. BOYLE D.L.C. NO. #55

THE PURPOSE OF THIS MAP IS TO IDENTIFY THE LOCATION OF THE WATER RIGHT. IT IS NOT INTENDED TO PROVIDE INFORMATION RELATIVE TO THE LOCATION OF PROPERTY OWNERSHIP BOUNDARY LINES.

03/26/07
 Certified Water Right Examiner
 52790WRE
Daniel A. Renton
 DANIEL A. RENTON
 DECEMBER 31, 2008
 STATE OF OREGON



SCALE: 1"=1320'

Added Lot 4 to Map DC/wrD 7/15/15