

T10S, R4W, W.M. Sec. 28

28

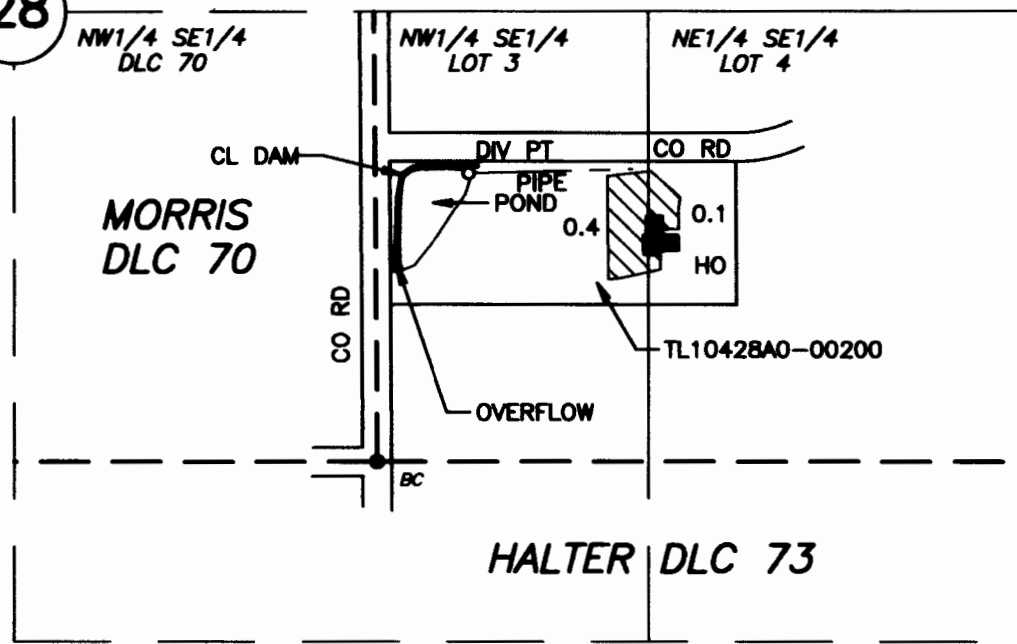

CL DAM LOCATION: NORTH 600 FT & EAST 55' FROM THE SE CORNER,
MORRIS DLC 70
DIV PT: NORTH 600 FT & EAST 200 FT FROM THE SE CORNER, MORRIS DLC 70
NW1/4 SE1/4 - 0.4A
NE1/4 SE1/4 - 0.1A

1" = 400'

CLAIM OF BENEFICIAL USE MAP

IN THE NAME OF
GARY & LAURA FOSDICK
APPLICATION S-85866, PERMIT 54091
RESERVOIR APPLICATION R-85865, PERMIT R-13894

Prepared July 24, 2006
Revised: March 22, 2007
PARSONS SURVEYING
1915 S.E. Stone St.
Corvallis, OR 97333
541-752-7515
Project No. 0607

RECEIVED

MAR 27 2007

WATER RESOURCES DEPT
SALEM, OREGON

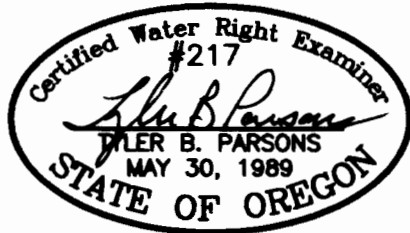

This map is for location of a Water Right only and does not constitute a boundary survey.

EXP: 12/31/2008