

FINAL PROOF SURVEY MAP IN THE NAME OF LOSHBAUGH INCORPORATED

APPLICATION G - 13522

PERMIT G - 13027

SECTIONS 1 & 12, TOWNSHIP 30 SOUTH, RANGE 15 WEST, W.M.

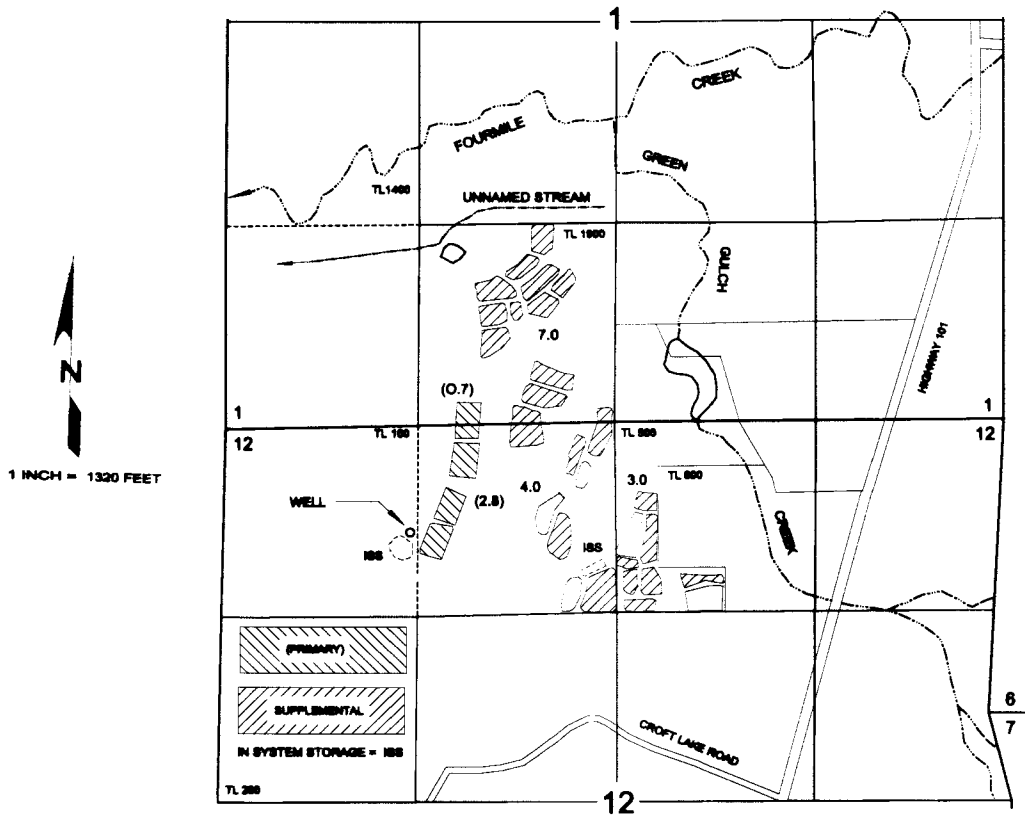

THE WELL IS LOCATED 780 FEET SOUTH AND 1380 FEET WEST FROM THE NORTH QUARTER CORNER OF SECTION 12, BEING WITHIN THE NW 1/4 NW 1/4 OF SECTION 12, TOWNSHIP 30 SOUTH, RANGE 15 WEST, W.M.; COOS COUNTY.

RECEIVED

MAR 25 2004

WATER RESOURCES DEPT.
SALEM, OREGON

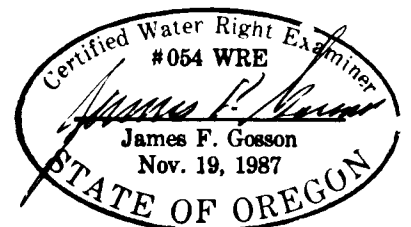

THE PURPOSE OF THIS MAP IS TO IDENTIFY THE LOCATION OF THE WATER RIGHT. IT IS NOT INTENDED TO PROVIDE INFORMATION RELATIVE TO THE LOCATION OF PROPERTY OWNERSHIP BOUNDARY LINES.