

CLAIM OF BENEFICIAL USE & FINAL PROOF MAP
 LOCATED IN THE NW¼ & SW¼ OF SECTION 12,
 GOV'T LOT 7 AND GOV'T LOT 6 & 5
 TOWNSHIP 26 SOUTH, RANGE 13 WEST, W.M.
 APPLICATION G-15472, PERMIT G-15245
 APPLICATION S-84712, PERMIT 53850
 COOS COUNTY, OREGON

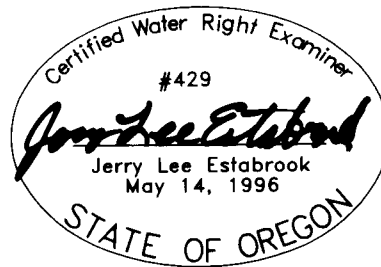

EXPIRES 12/31/2011

LEGEND

- POB (POINT OF BEGINNING)
- POD (POINT OF DIVERSION)
- POA (POINT OF APPROPRIATION)



1" = 400 FEET

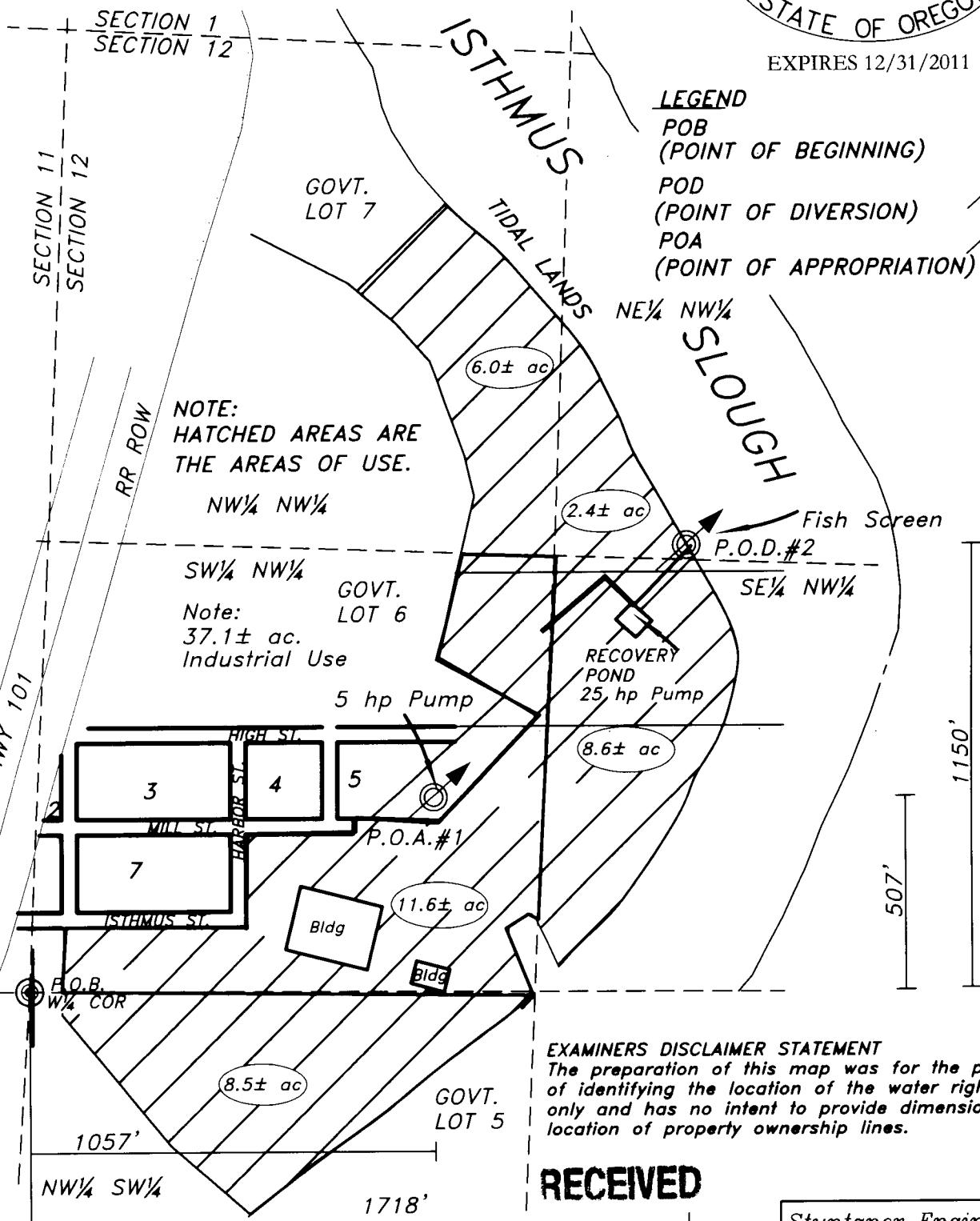

NOTE:
 HATCHED AREAS ARE
 THE AREAS OF USE.
 NW¼ NW¼

SW¼ NW¼
 Note:
 37.1± ac.
 Industrial Use

EXAMINERS DISCLAIMER STATEMENT
 The preparation of this map was for the purpose
 of identifying the location of the water right
 only and has no intent to provide dimensions or
 location of property ownership lines.

RECEIVED

PREPARED FOR: KNUTSON TOW BOAT
 PREPARED BY: DENNIS GOUDE
 DATE PREPARED: JANUARY 19, 2010

WATER RESOURCES DEPT
 SALLA, OREGON

Stuntzner Engineering & Forestry, L.L.C.
 ENGINEERING • LAND SURVEYING • FORESTRY
 PLANNING • WATER RIGHTS
 706 South 4th St.
 Post Office Box 118
 Coos Bay, Oregon 97409
 Phone: (541) 267-2872
 Fax: (541) 267-0688