

# Final Proof Survey T 6 S R 1 E, WM portions of sections 21, 22, 27, 28

Prepared for: DAVID J. BIELENBERG

Application # R-71961 & 71962  
Permit # R-12178 & 53180



div pt locations:  
 #1 = 30' S & 1195' W  
 #2 = 25' S & 2260' W  
 #3 = 320' S & 2310' W  
 #4 = 135' N & 2280' W  
 #5 = 30' S & 850' W  
 all from the NE cor. DLC 40

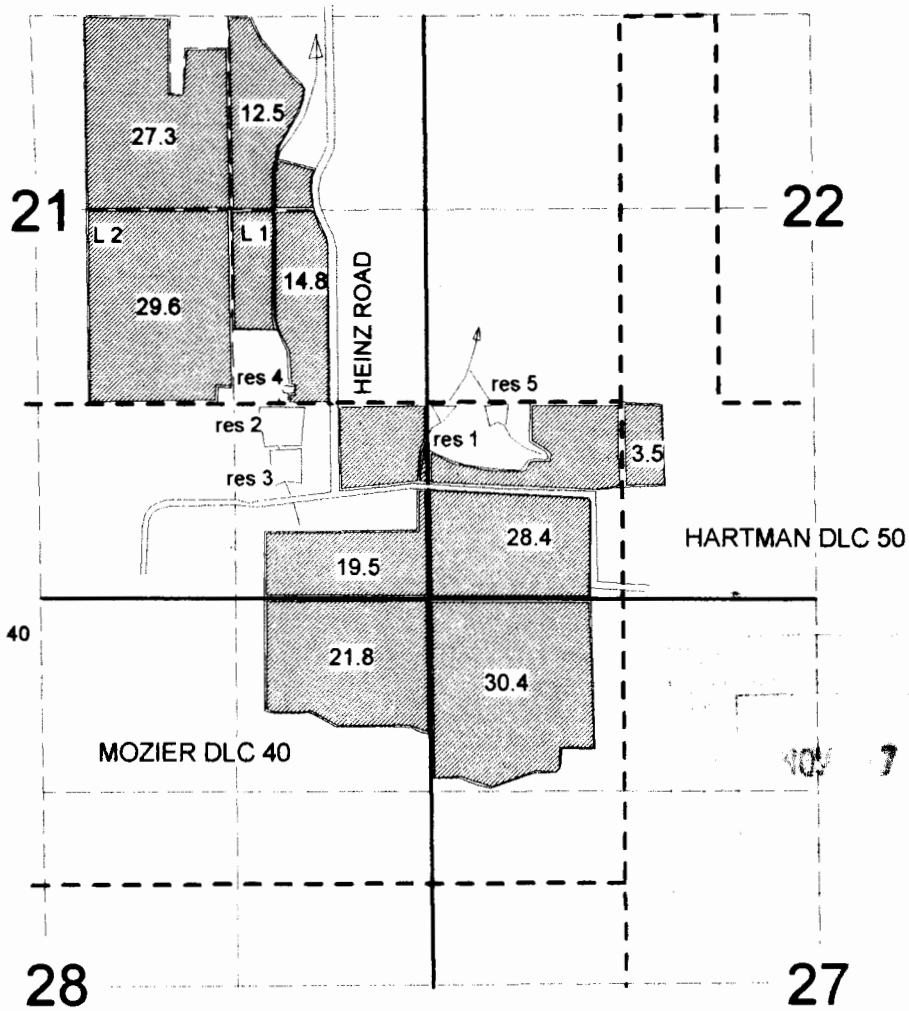

Don Knauer Consulting  
 PO Box 5416  
 Salem, OR 97304  
 503-585-8474

