

COBU MAP FOR
 APPLICATION S-86365, PERMIT S-54305
 SECTIONS 15 & 16 T1N, R3W, W.M.
 WASHINGTON COUNTY, OREGON

FOR:
GLENN WALTERS NURSERY
 P.O. BOX 280
 BANKS, OR 97106

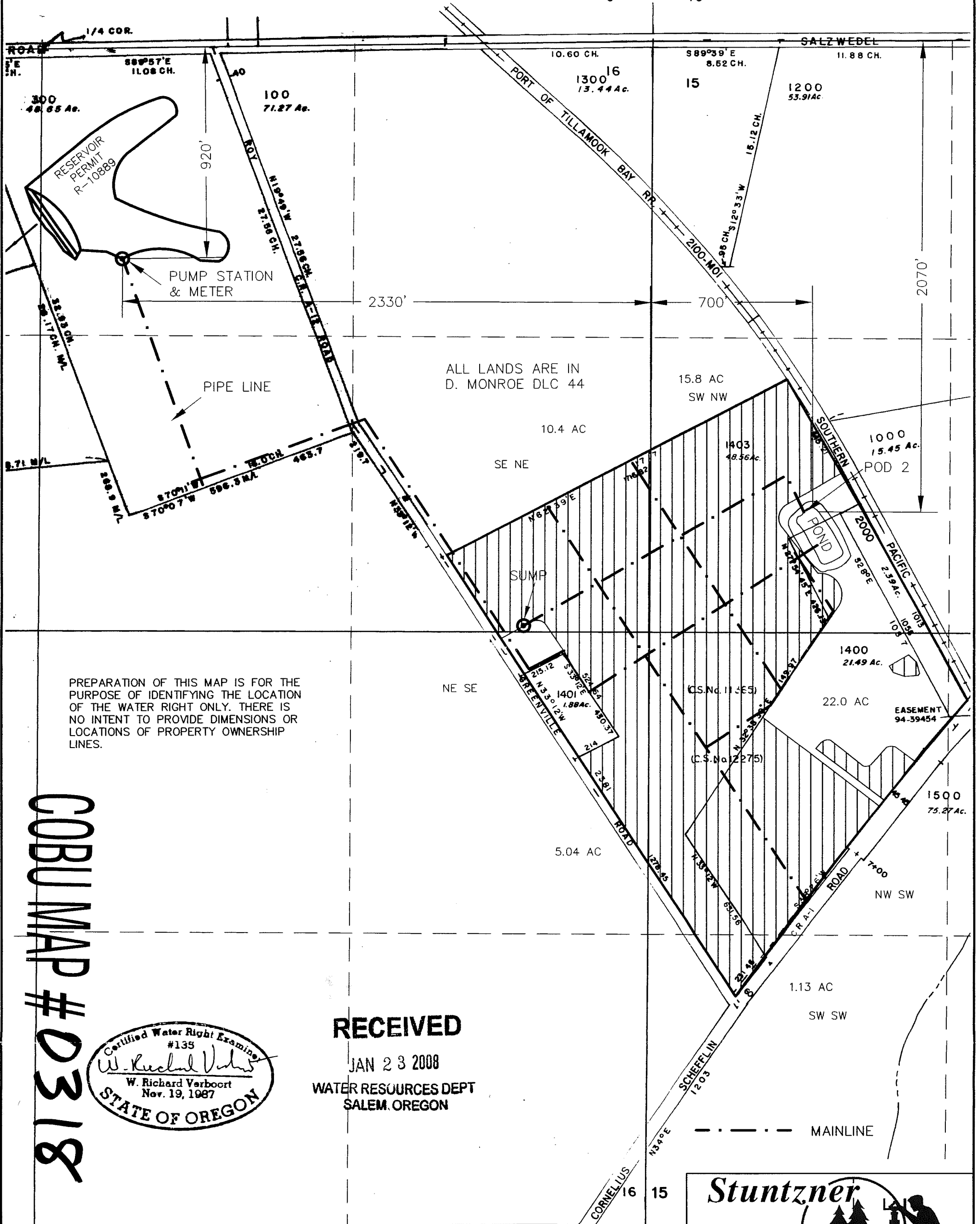
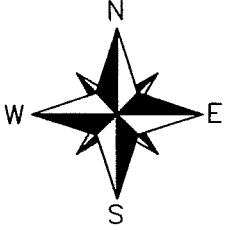

ALL LANDS ARE IN
 D. MONROE DLC 44

PREPARATION OF THIS MAP IS FOR THE
 PURPOSE OF IDENTIFYING THE LOCATION
 OF THE WATER RIGHT ONLY. THERE IS
 NO INTENT TO PROVIDE DIMENSIONS OR
 LOCATIONS OF PROPERTY OWNERSHIP
 LINES.

COBU MAP # 0318



RECEIVED
 JAN 23 2008
 WATER RESOURCES DEPT
 SALEM, OREGON

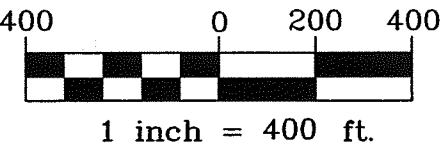

MAP IS BASED ON ASSESSORS
 MAPS 1N3W15 & 1N3W16, AND
 12-3-07 USDA-FSA PHOTO

Stuntzner
 Engineering & Forestry, LLC

ENGINEERING • LAND SURVEYING • FORESTRY
 PLANNING • WATER RIGHTS

2137 19TH AVENUE
 FOREST GROVE, OR 97116
 INFO@STUNTZNER.COM
 PHONE: (503) 357-5717
 FAX: (503) 357-5698

DRAWN BY: C VAN BUREN	DATE: 11-16-07
CHECKED BY: W.R. VERBOORT	DRAWING NO.: 3052076GWNCOBUC
DESIGNED BY:	REVISED:
JOB NAME: 3052076GWN-Clermont	SHEET 1 OF 1