

R. 44 E. R. 45 E.

13 18
24 18

18 17
18 28

17 18
20 21

T. 18 S.
24 19
25 30

25 30
36 31

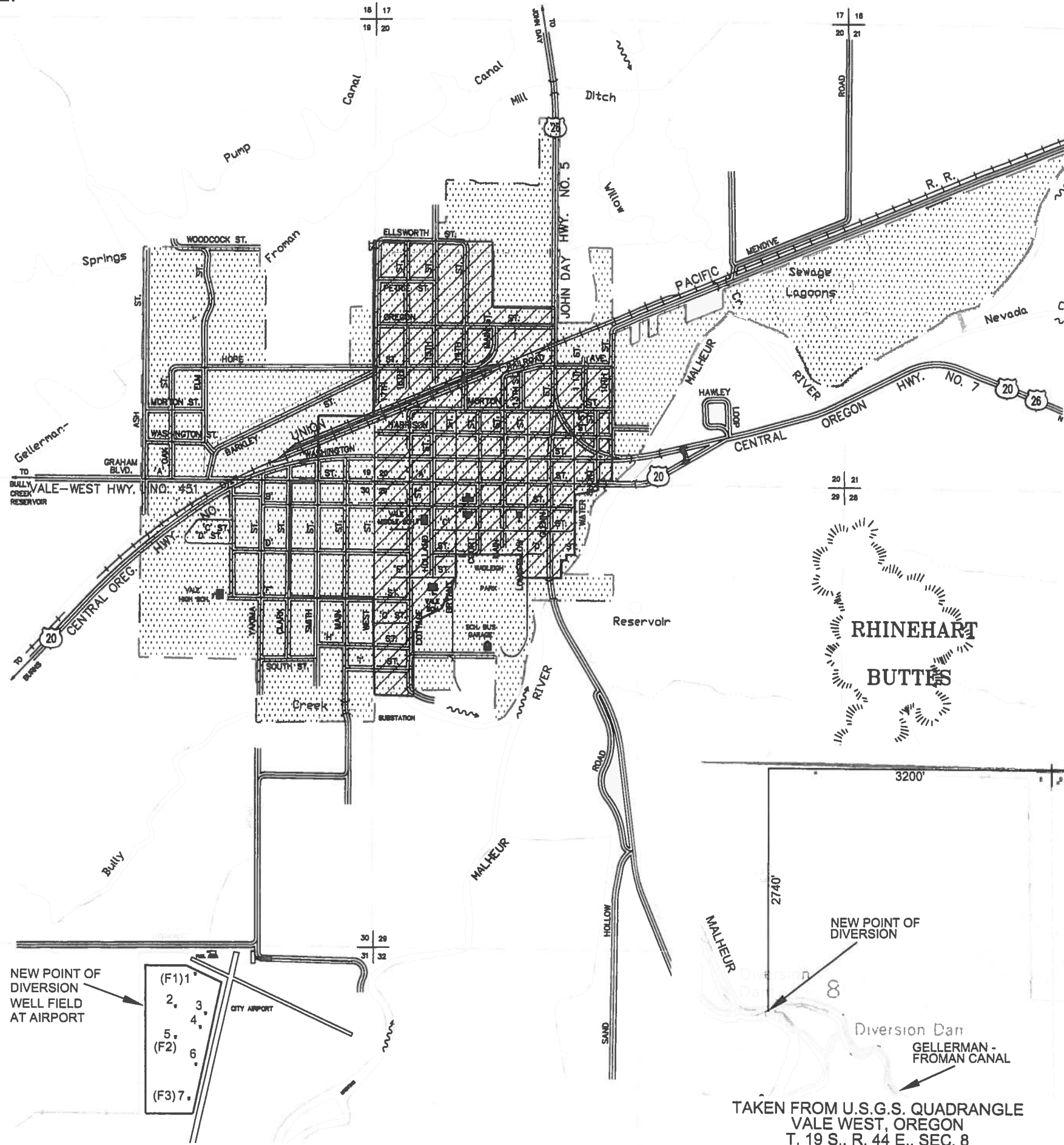

RECEIVED
 OCT 04 2004
 WATER RESOURCES DEPT
 SALEM OREGON



CITY OF VALE

- LEGEND:
- 1897 WATER RIGHT USE AREA
 - NEW WATER RIGHT USE AREA
 - CURRENT CITY LIMITS
 - CITY BOUNDARY DURING 1927 ADJUDICATION
 - RIVER FLOW DIRECTION
 - IRRIGATION DITCH FLOW DIRECTION

NOTE: ORIGINAL WATER USE AREA WAS 185 ACRES.
 THE CURRENT CITY OF VALE BOUNDARY INCLUDES APPROXIMATELY 695 ACRES.

State Water Right Examiner
 #069
 Michael E. Halladay
 Nov. 19, 1987
 STATE OF OREGON
 9/30/04

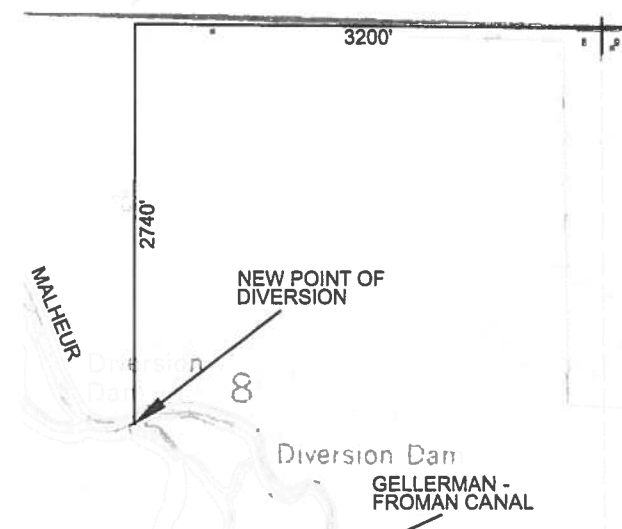
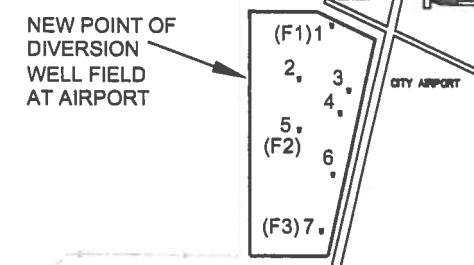

TAKEN FROM U.S.G.S. QUADRANGLE
 VALE WEST, OREGON
 T. 19 S., R. 44 E., SEC. 8

TAKEN FROM U.S.G.S. QUADRANGLE
 VALE WEST, OREGON
 T. 19 S., R. 44 E., SEC. 3

HOLLADAY ENGINEERING CO.
 ENGINEERS · CONSULTANTS
 32 N. MAIN P.O. BOX 235 PAYETTE, ID 83401
 (208) 642-3304 FAX (208) 642-2100
 EMAIL: holladayengr@earthlink.net

CITY OF VALE OREGON
 CLAIM OF BENEFICIAL USE & SITE REPORT
 TRANSFER APPLICATION T-8166

REUSE OF DOCUMENTS
 THIS DOCUMENT AND THE DATA AND DESIGN INCORPORATED HEREIN, AS AN INSTRUMENT OF PROFESSIONAL SERVICE, IS THE PROPERTY OF HOLLADAY ENGINEERING CO. AND IS NOT TO BE REPRODUCED, COPIED, EITHER WHOLE OR IN PART, FOR ANY OTHER PROJECT WITHOUT THE WRITTEN AUTHORIZATION OF HOLLADAY ENGINEERING CO.

JOB NO.	VL 091798-B
CADD FILE	
DATE	7/7/99
REVISION	9/10/99
PLOTTER	9/13/99
DRAWN BY	CMD
CHECKED BY	MEH