

T 6 S, R 1 W, W.M.

MARION COUNTY, OREGON

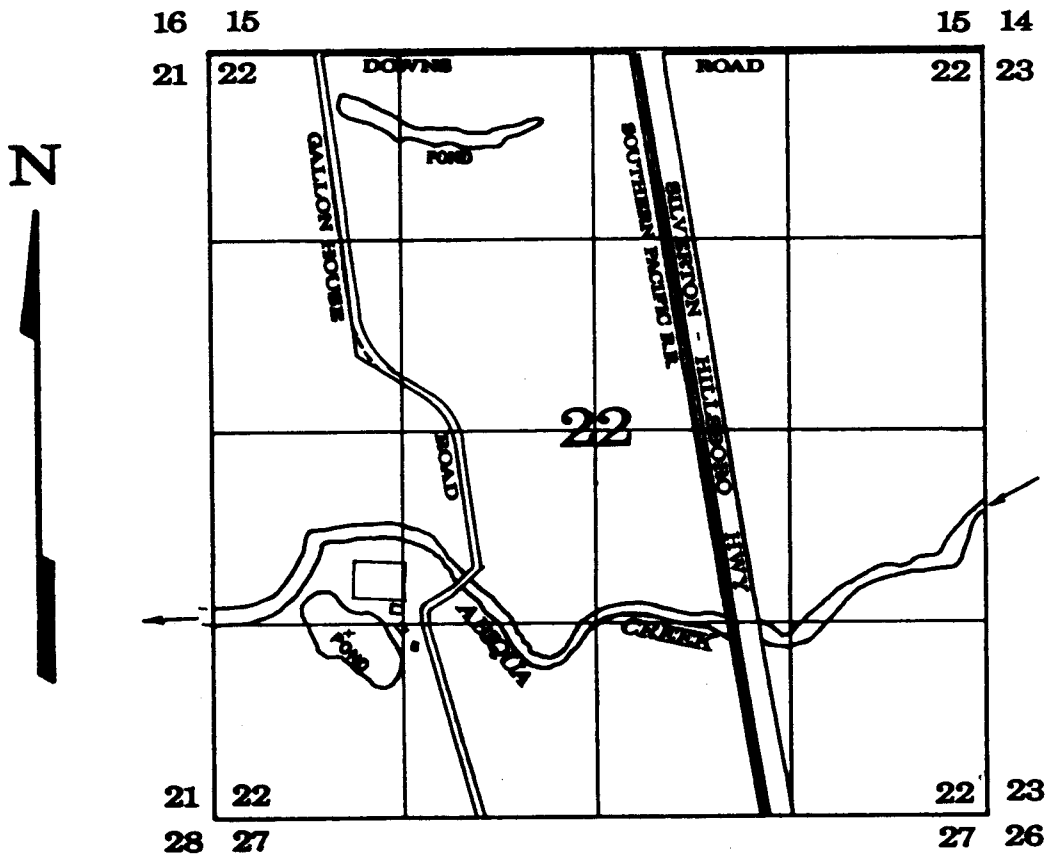

CENTER OF POND 940' E & 1270' N FROM THE S.W. CORNER OF SECTION 22 T.6S., R.1W., W.M.

FINAL PROOF SURVEY

33615

26580

Application No. R 72221 Permit No. R-11871

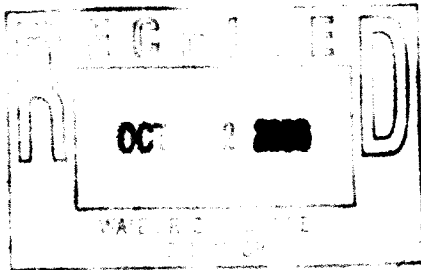

FRED RHYME

Scale 1" = 1320'

SEPTEMBER 22, 1900

NOTE: This map is for the purpose of identifying the location of water rights and has no intent to dimension or locate property ownership lines.

