

CORBU MAP # 0384

T3S, R2E, Section 21, WM
 Claim of Beneficial Use Map
 Clackamas County

Permit No. S-51274 & R-11390
 Application No. S-70118 & R-70117

THIS MAP IS NOT INTENDED TO
 PROVIDE LEGAL DIMENSIONS
 OR LOCATIONS OF PROPERTY
 OWNERSHIP LINES.

Site Inspection Conducted
 August 27 and
 September 9, 2008

Map Date: October 1, 2008

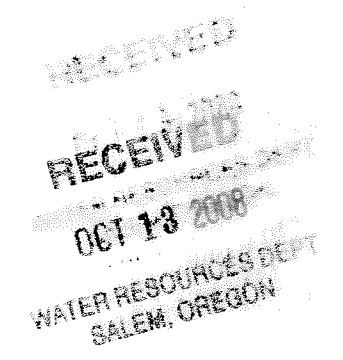
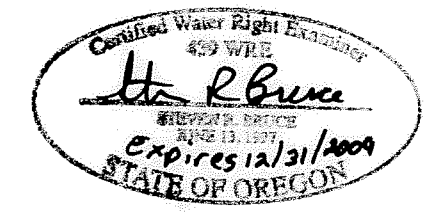

1 inch = 400 feet

FIGURE 1

STONE CREEK GOLF CLUB

0384

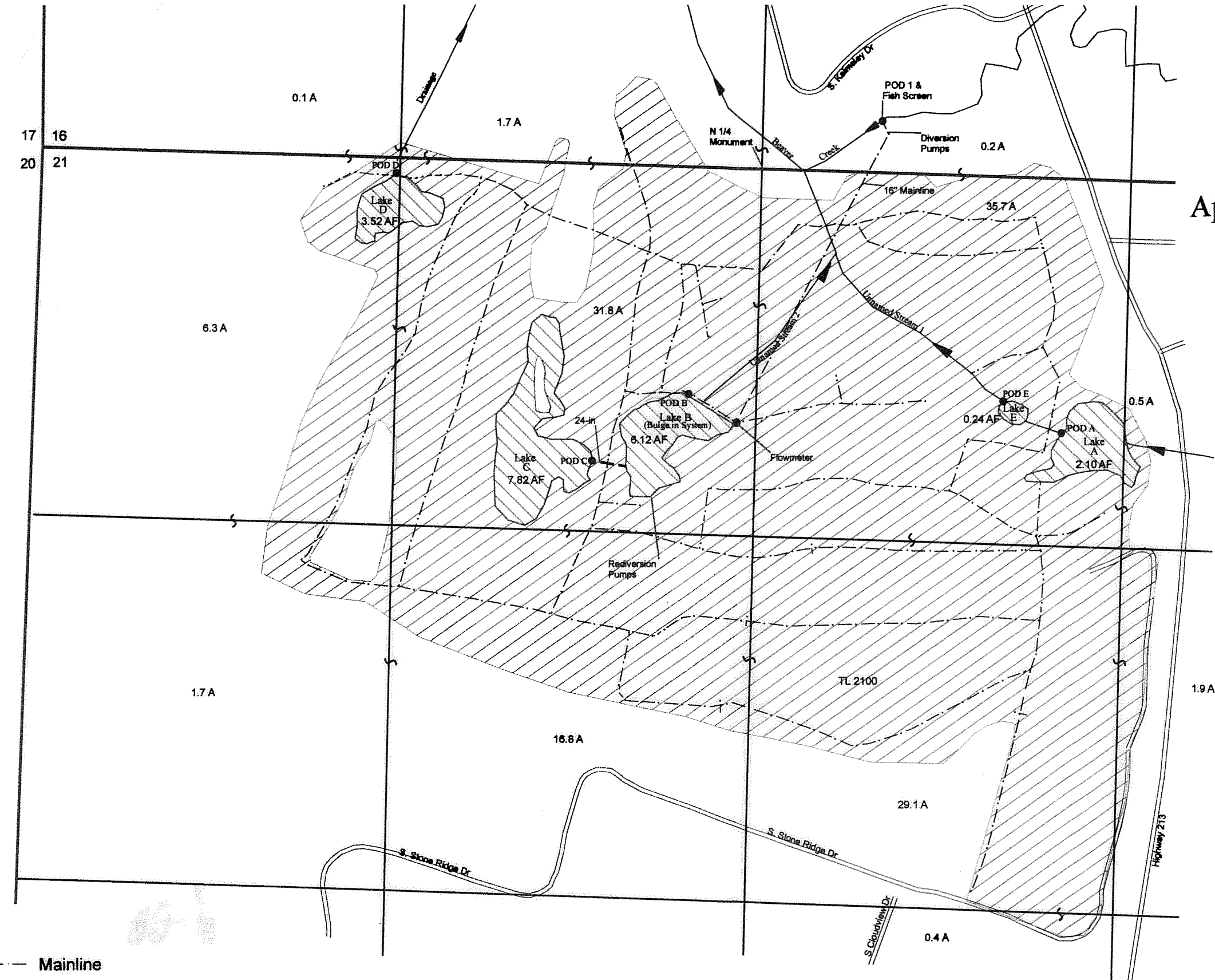

- Mainline
- Place of Use for Primary Irrigation (126.2 Acres)
- Place of Use for Storage (Irrigation and Recreation)

- POD 1 located 190 ft N and 430 ft E from NW 1/4 corner of Section 21
- POD A located 930 ft S and 1,120 ft E from NW 1/4 corner of Section 21
- POD B located 830 ft S and 250 ft W from NW 1/4 corner of Section 21
- POD C located 1,080 ft S and 600 ft W from NW 1/4 corner of Section 21
- POD D located 60 ft S and 1,330 ft W from NW 1/4 corner of Section 21
- POD E located 820 ft S and 900 ft E from NW 1/4 corner of Section 21

All from N 1/4 corner, section 21 mfb/wrd 7-30-15