



Section 5, T4N, R37E, WM
Section 32, T5N, R37E, WM
Umatilla County

1 inch = 400 feet

RECEIVED

AUG 26 2009

WATER RESOURCES DEPT
SALEM, OREGON

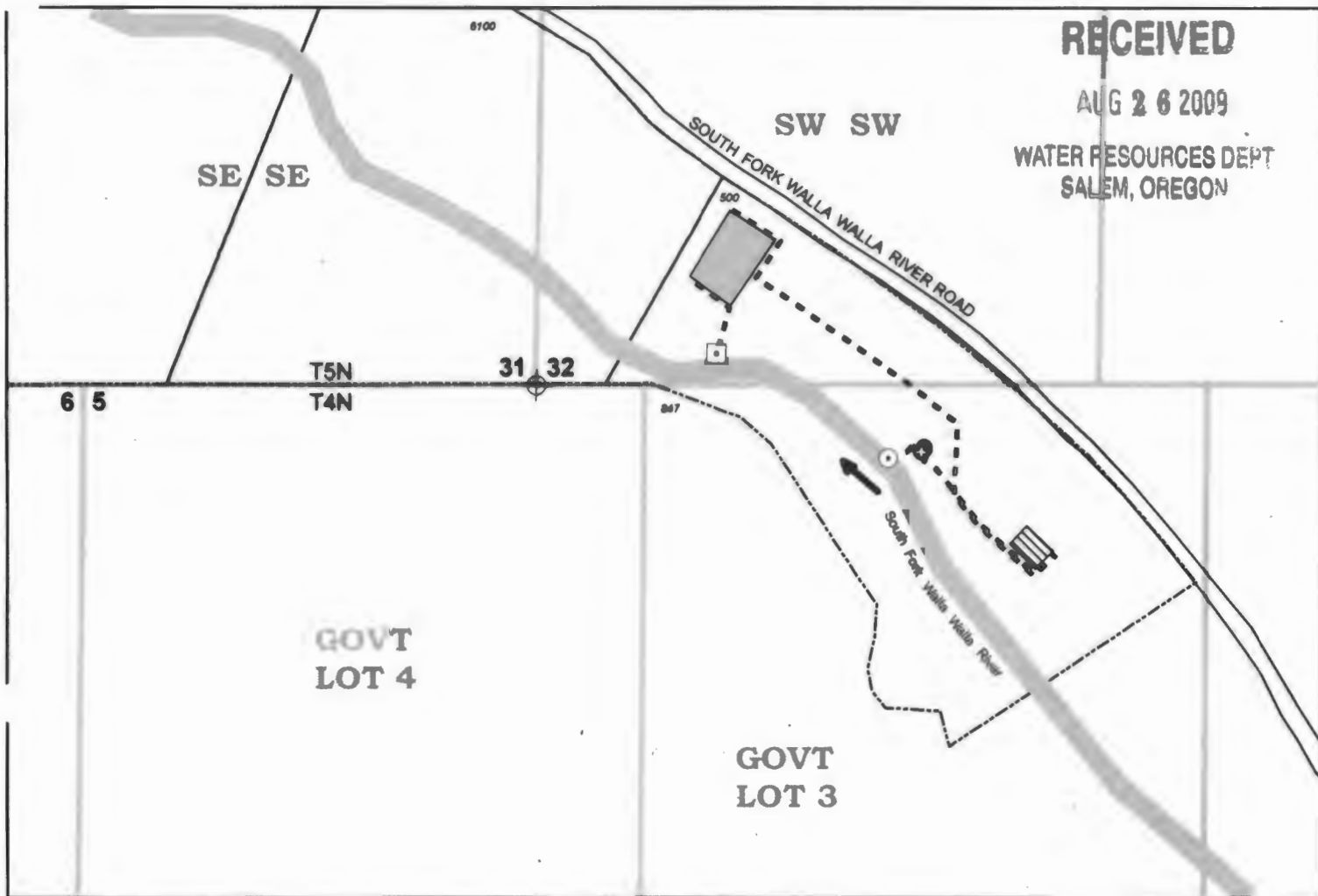

⊙ **Point of Diversion**

Headgate with fish screen located in NE/4 of NW/4 of Section 5, about 162 feet S and 837 feet E from SW Corner of Section 32.

⊕ **Pumps**

Two 200 horsepower turbine pumps located in building. One pump operated at a time.

--- **Conveyance**

Water conveyed from South Fork Walla Walla River to pump station via short reach of open ditch.

Water conveyed from pump station to rearing raceways via buried mainline (24-inch).

Water conveyed from rearing raceways to settling pond and outfall via buried mainline (24-inch).

 **Raceways**

Used to hold/rear and spawn adult Spring Chinook salmon in NE/4 of NW/4 of Section 5.

 **Settling Pond**

Used to treat water prior to discharge to river.

 **Weir and Outfall**

Measurement weir at outfall to South Fork Walla Walla River.

The purpose of this map is to identify the location of a water right. It is not intended to provide information regarding the location of property ownership boundary

FOUNTAINHEAD
1204 Alvarado Terrace
Walla Walla, WA 99362
509.529.2646 phone

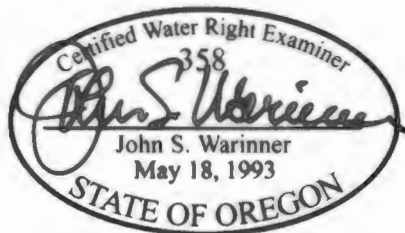

CLAIM OF BENEFICIAL USE
App S-80879 Permit 53028

in the name of
BONNEVILLE POWER ADMIN

Revised 01 DEC 2008