

Sections 7 & 18, T5S, R1E, WM  
 Clackamas County, Oregon  
 Application G-15056, Permit G-13833  
 Permit Amendment T-9545

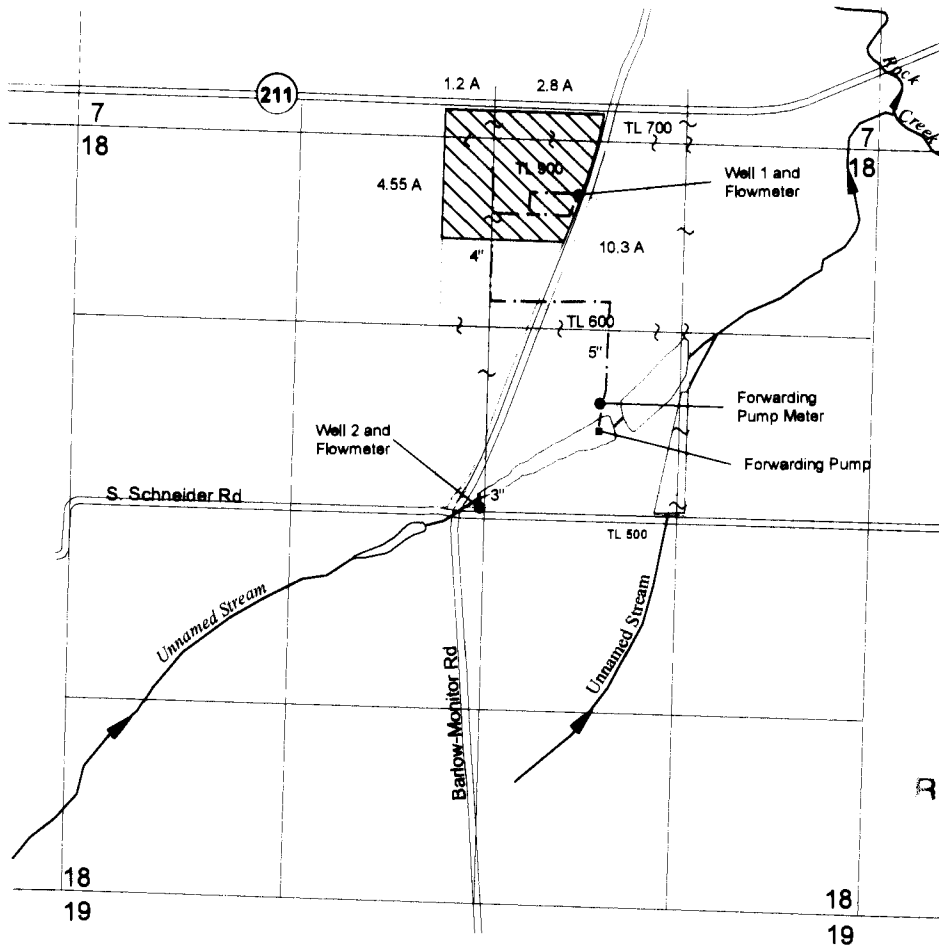



RECEIVED BY OWRD

AUG 10 2015

SALEM, OR

**EXPLANATION**

 Place of Use for T-9545  
 18.85 acres

 Place of Use for Permit G-17412  
 (Application G-17680)

- Well 1 located 370 feet S and 2,045 feet W from NE Corner of Section 18.
- Well 2 located 40' feet N and 2,650 feet W from E1/4 corner of Section 18.

Site Inspections Conducted  
 on 6/5/2013 and 7/1/2015

— Mainline



THIS MAP IS NOT INTENDED TO  
 PROVIDE LEGAL DIMENSIONS OR  
 LOCATIONS OF PROPERTY  
 OWNERSHIP LINES.

1 inch = 1,320 feet

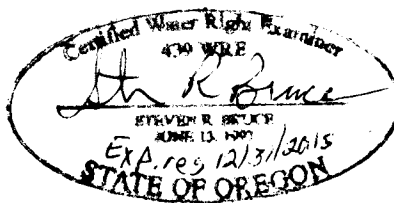
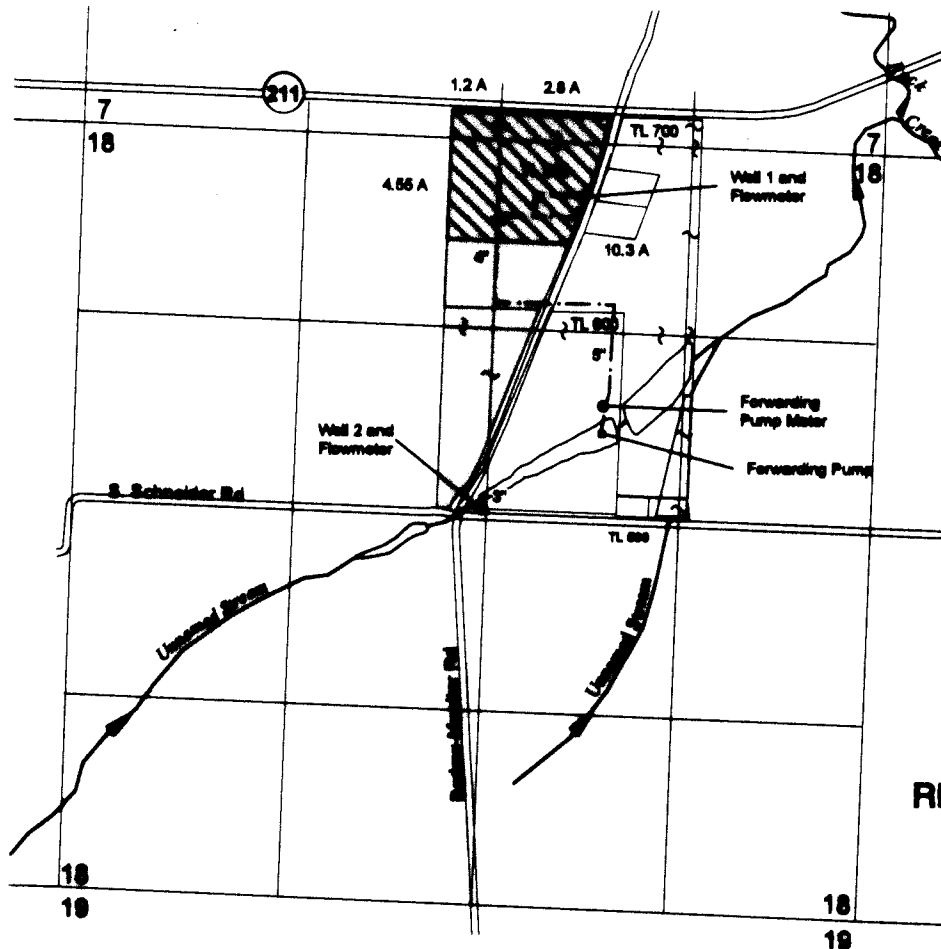

FIGURE 1

August 3, 2015

**Sections 7 & 18, T5S, R1E, WM**  
**Clackamas County, Oregon**  
**Application G-15056, Permit G-13833**  
**Permit Amendment T-9545**





RECEIVED BY OWRD

AUG 10 2015

SALEM, OR

**EXPLANATION**

 **Place of Use for T-9545**  
18.85 acres

 **Place of Use for Permit G-17412**  
(Application G-17680)

- Well 1 located 370 feet S and 2,045 feet W from NE Corner of Section 18.
- Well 2 located 40' feet N and 2,650 feet W from E1/4 corner of Section 18.

Site Inspections Conducted on 6/5/2013 and 7/1/2015

--- Mainline



THIS MAP IS NOT INTENDED TO PROVIDE LEGAL DIMENSIONS OR LOCATIONS OF PROPERTY OWNERSHIP LINES.

1 inch = 1,320 feet

August 3, 2015

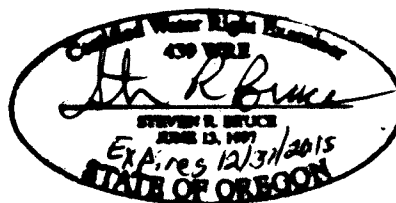

**FIGURE 1**