

# T9S, R3W, WM

MARION COUNTY

POND IS SURROUNDED BY DIKE

TAX LOTS:  
9 3W 17 400

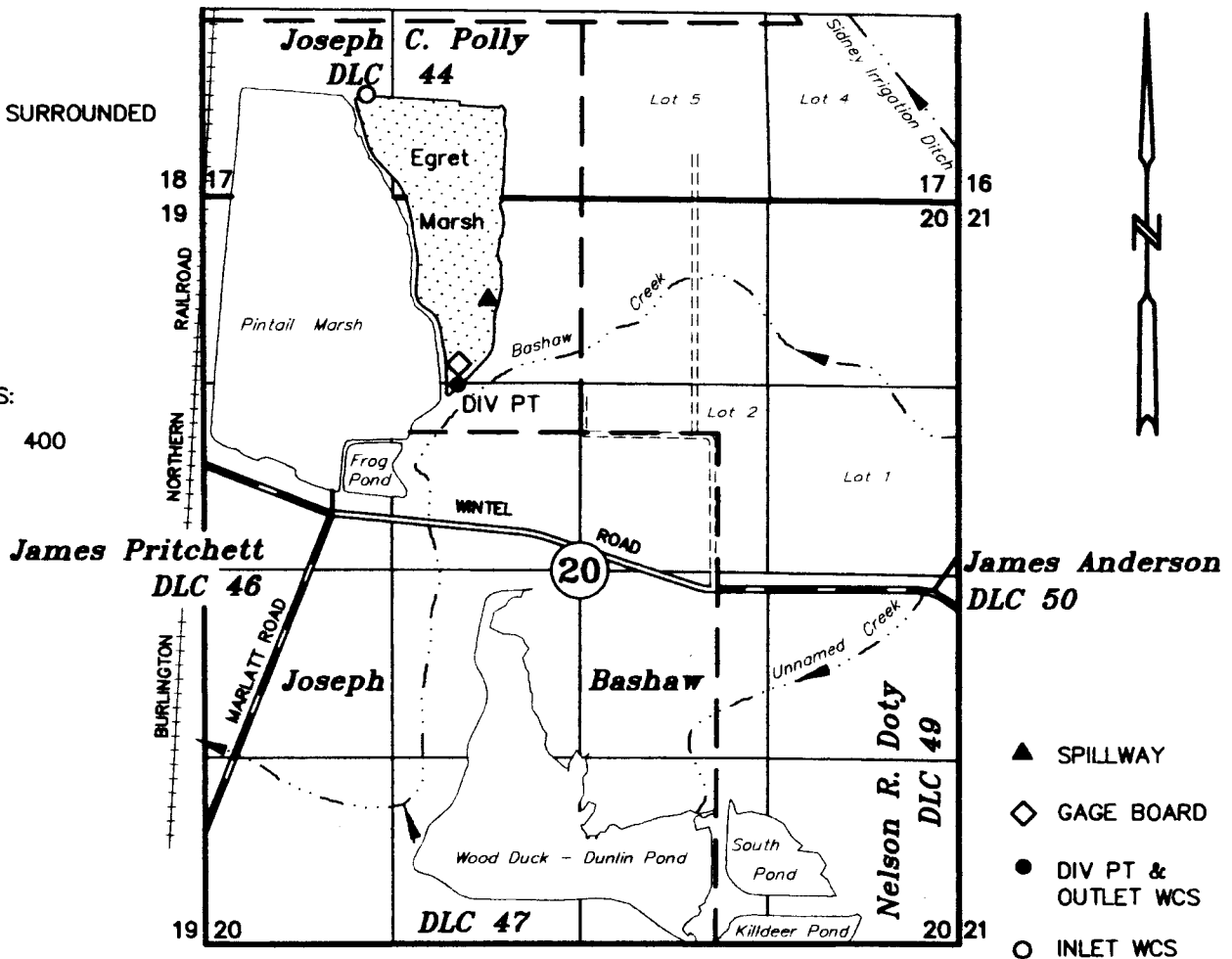

WCS = WATER CONTROL STRUCTURE

DIV PT, EGRET MARSH: 895' NORTH & 906' EAST OF NE COR JAMES PRITCHETT DLC No 46

## FINAL PROOF SURVEY

UNDER

Application No. R-86726

Permit No. R-14440

## U.S. FISH & WILDLIFE SERVICE

### Division of Engineering

November 24, 2009

June 23, 2009

SCALE: 1" = 1320'

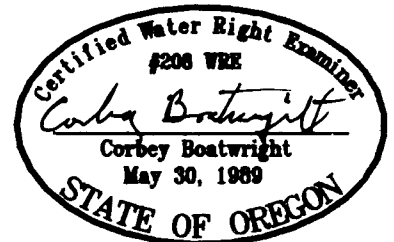

NOTE: This map is for the purpose of identifying the location of water rights and has no intent to dimension or locate property ownership lines.

EXPIRES: 12-31-2011