

T.18S. R.12W. Section 23, W.M.

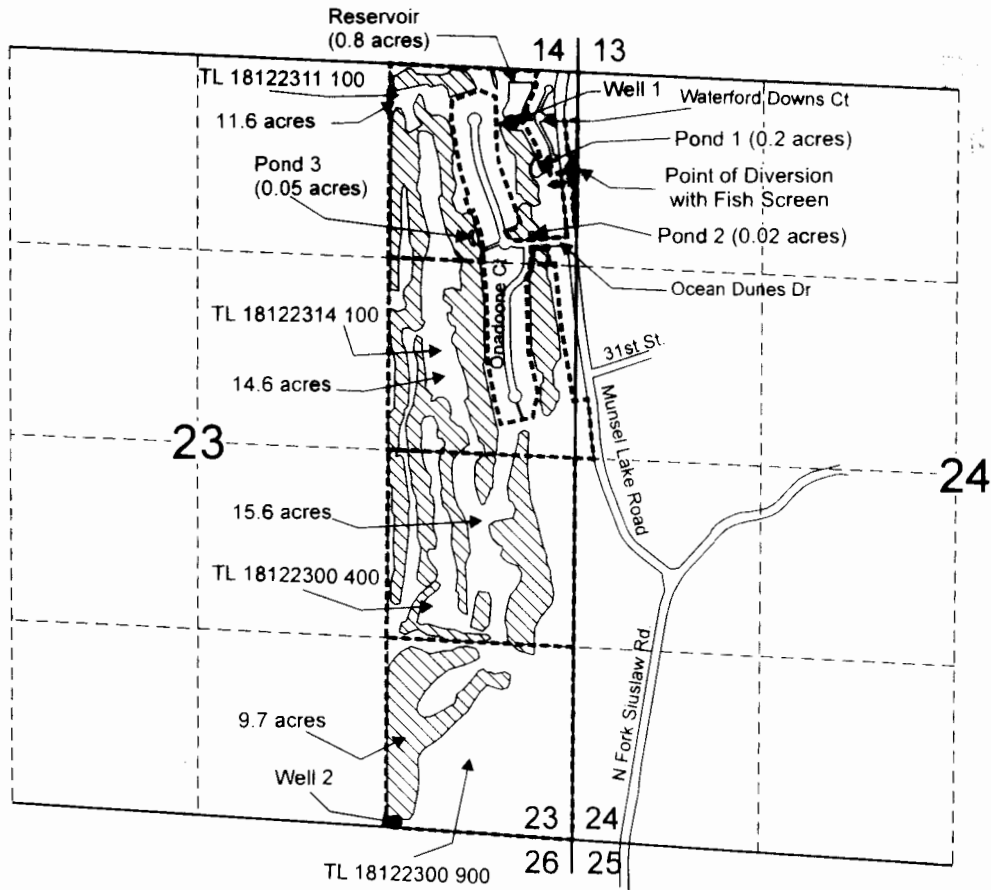

Point of Diversion is located 662 feet south and 41 feet west from the NE corner of Section 23.
 Well 1 is located 340 feet south and 456 feet west of the NE corner of Section 23.
 Well 2 is located 121 feet north and 1,217 feet west of the SE corner of Section 23.
 The Reservoir is located 195 feet south and 414 feet west of the NE corner of Section 23.
 Pond 1 is located 668 feet south and 288 feet west of the NE corner of Section 23.
 Pond 2 is located 1,058 feet south and 352 feet west of the NE corner of Section 23.
 Pond 3 is located 1,059 feet south and 773 feet west of the NE corner of Section 23.

- Area (51.5 Acres) of primary Irrigation under Application R-84856, Permit R-13407.
- Tax Lot Boundary

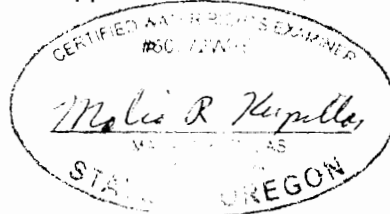

Scale: 1" = 1,320'

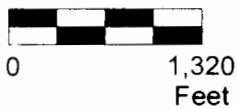

6/30/09
 This map was prepared for the purpose of identifying the location of a water right only and is not intended to provide legal dimensions or location of property ownership lines.



Claim of Beneficial Use Map
 Application R-84856, Permit R-13407
 + R-85108, R-13404
 Ocean Dunes LLC.
 T.18S. R.12W. Section 23

Pacific Hydro-Geology Inc.

09/2009

Ocean Dunes .cdr