

T9S, R3W, WM

MARION COUNTY

NOTE:
BOTH PONDS ARE
SURROUNDED BY
DIKES

TAX LOTS:

9 3W 20 400
9 3W 17 400

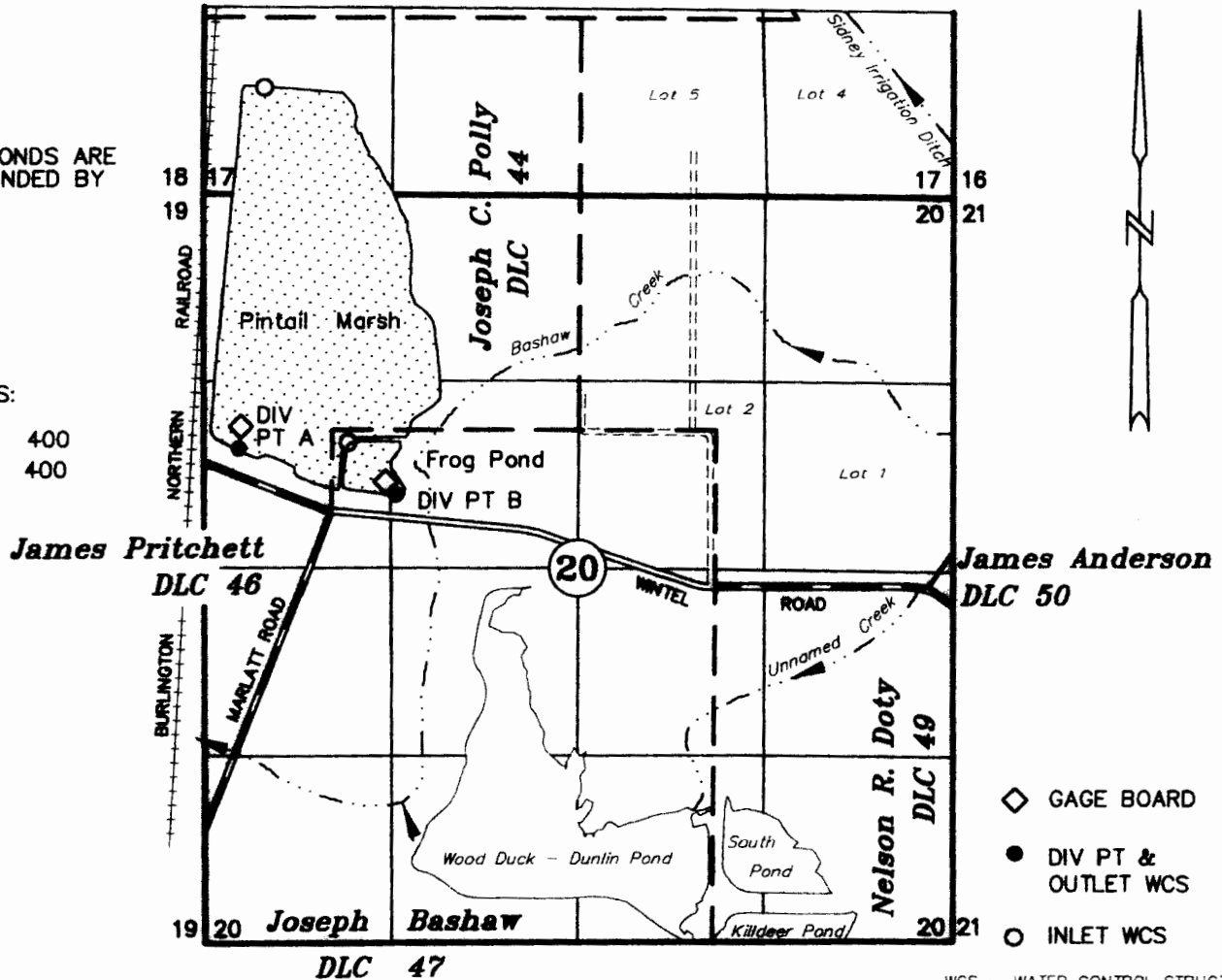

- ◇ GAGE BOARD
- DIV PT & OUTLET WCS
- INLET WCS

WCS = WATER CONTROL STRUCTURE

DIV PT A, PINTAIL MARSH: 491' NORTH & 652' WEST OF NE COR JAMES PRITCHETT DLC No 46
DIV PT B, FROG POND: 216' NORTH & 467' EAST OF NE COR JAMES PRITCHETT DLC No 46

FINAL PROOF SURVEY

UNDER

Application No. R-83528 Permit No. R-12349

U.S. FISH & WILDLIFE SERVICE

Division of Engineering

JULY 10, 2007
JUNE 23, 2009

SCALE: 1" = 1320'

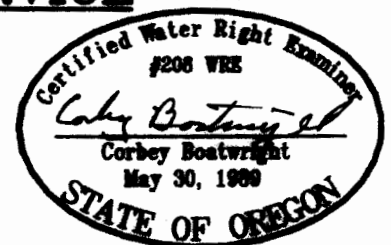

EXPIRES: 12-31-2011

NOTE: This map is for the purpose of identifying the location of water rights and has no intent to dimension or locate property ownership lines.