

Partial Perfection Claim of Beneficial Use Point of Re-Diversion Map

Permit S-53898 (Application S-84029)

Water Right in the Name of City of Talent
Jackson County
Township 36 South, Range 1 and 2 West (W.M.)

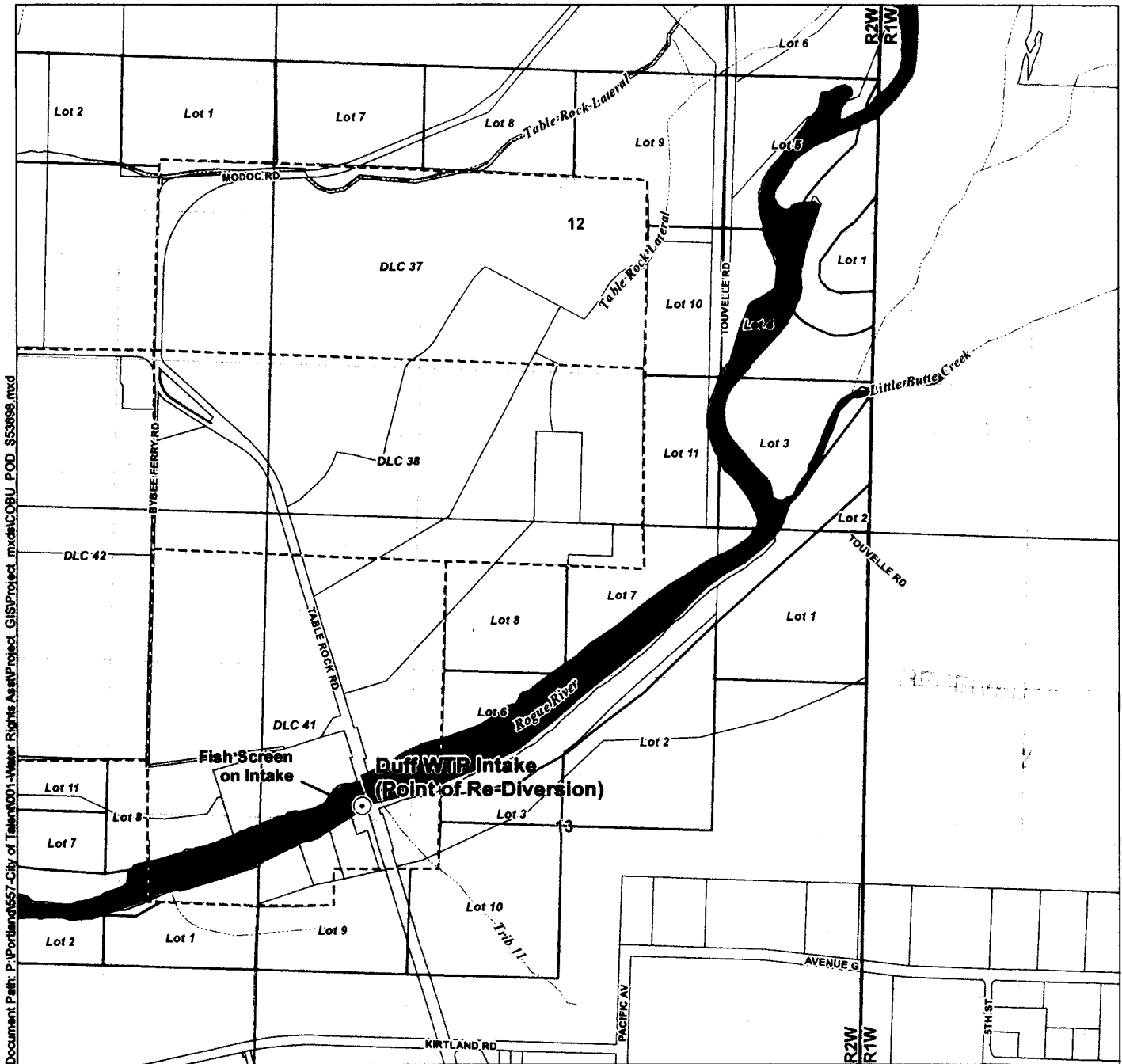

Legend

- Point of Re-Diversion (POD)
- Donation Land Claims (DLCs)
- Government Lots
- Taxlots
- Watercourses
- Waterbodies

POD Location Description

Duff WTP Intake
Located South 25°25'28" East, 4,385.6 feet from the NE corner of Donation Land Claim 42 (W.M.)

Certified Water Rights Examiner Stamp

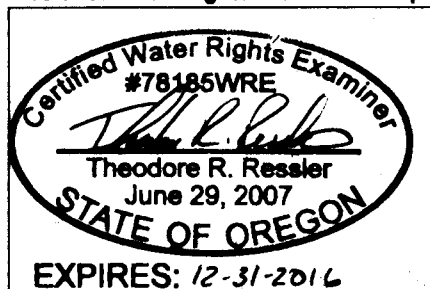

Disclaimer

This map was prepared for the purpose of identifying the location of a water right only and it is not intended to provide legal dimensions or location of property ownership lines.

Map Notes

Date: February 27, 2015
Data Sources: Jackson County GIS, OWRD
Prepared By: GSI Water Solutions, Inc.

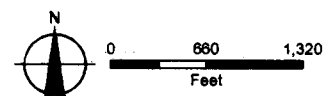

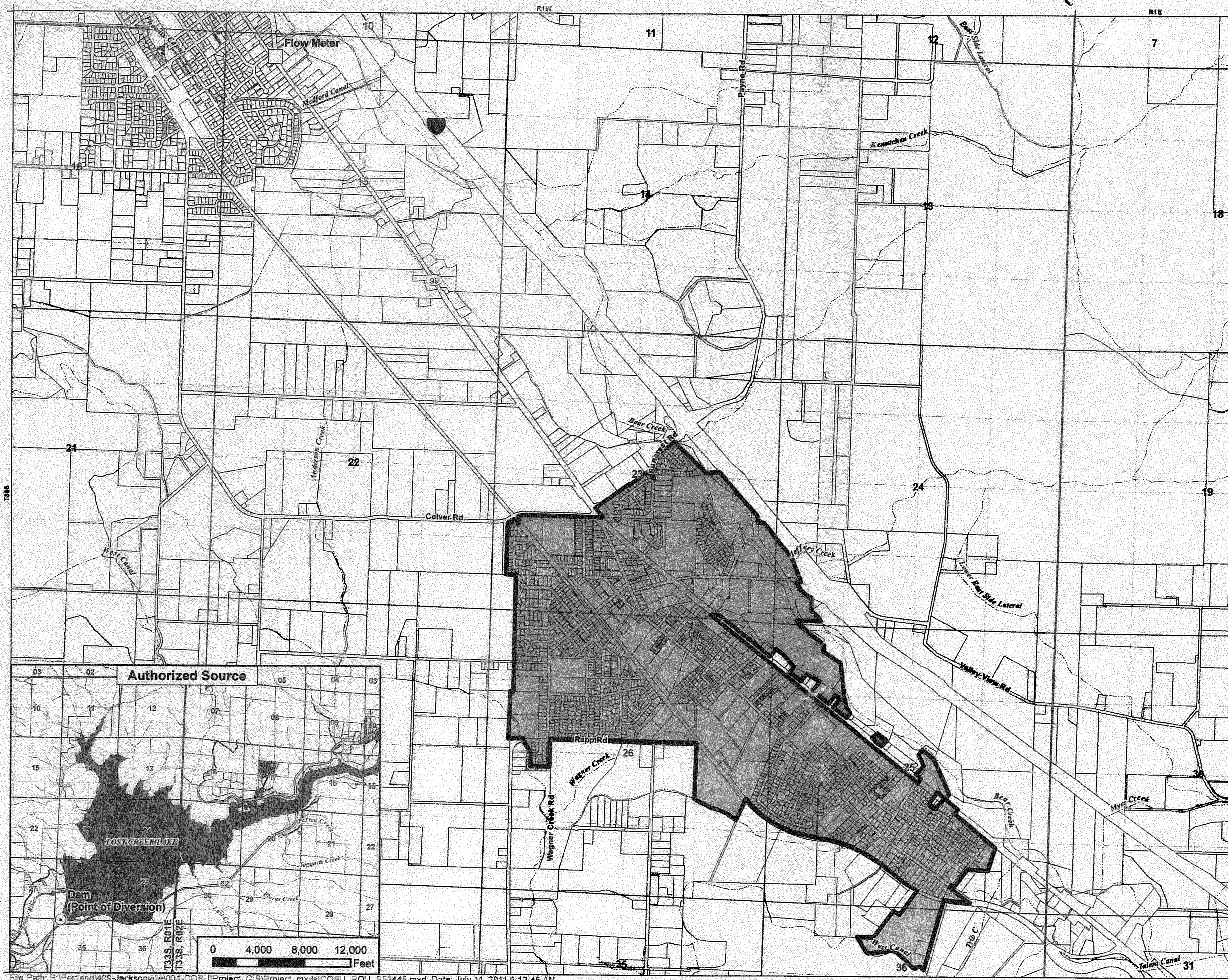

**Partial Perfection
Claim of Beneficial Use
Place of Use Map**

Permit S-53898 (Application S-84029)
Water Rights in the Name of City of Talent
Jackson County
Township 37 South, Range 2 West (W.M.)

LEGEND

- Flow Meter
- Place of Use (POU)
- Taxlots
- Jacksonville City Limit
- Watercourses
- Waterbodies

RECEIVED BY OWRD

AUG 12 2015

SALEM, OR

Place of Use Description
"Within the service boundaries of the
City of Talent"

Certified Water Rights Examiner Stamp

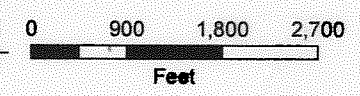
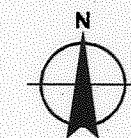

MAP NOTES:

Date: February 27, 2015
Data Sources: Jackson County GIS, OWRD

