

T.10S., R.3W., W.M.

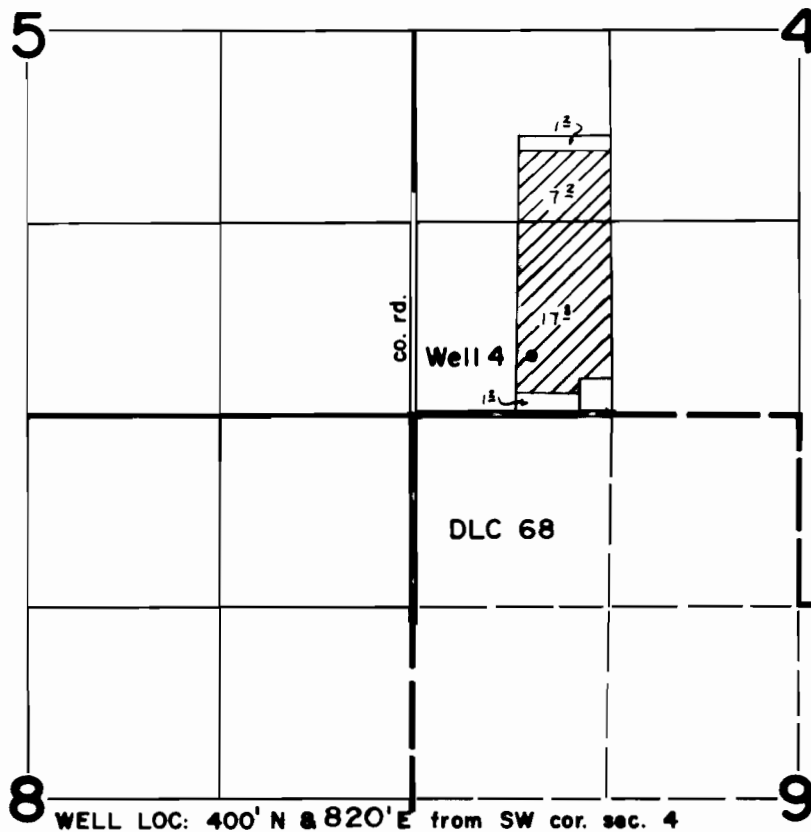

**FINAL PROOF SURVEY**  
UNDER

Application No. G-6002 Permit No. G-5710  
IN NAME OF

GLEN & JACQUELINE GHORMLEY



Surveyed April 12 1976, by D. Norby  
" April 23, 1979 by S.C. BROWN



T.10S., R.3W., W.M.

Scale: 1"=1320'

Legend

- Tax lot 10 S 3 W 4 906 boundary
-  Certificate 50301 POU
-  Certificate 50301 POU not part of this transfer

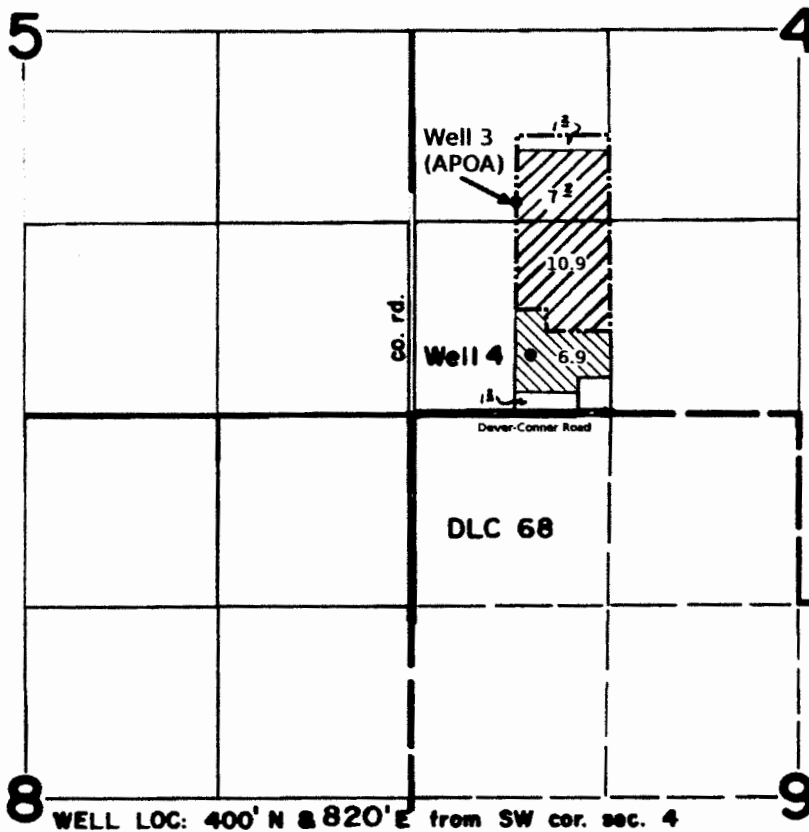

WELL LOC: 400' N & 820' E from SW cor. sec. 4  
 Well 3 (APOA) Loc: 1470' N & 720' E from SW cor. sec. 4

**FINAL PROOF SURVEY  
UNDER**

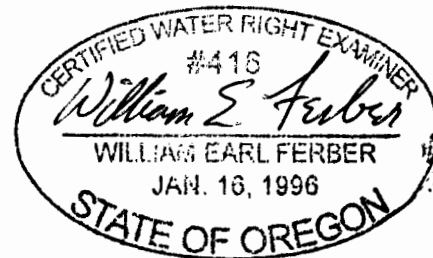

Application No. G-6002 Permit No. G-5710  
IN NAME OF

EXPIRES: 2015.12.31

GLEN & JACQUELINE GHORMLEY

Surveyed April 12, 1976 by D. Norby  
" April 23, 1979 by S.C. BROWN

**RECEIVED**

SEP 25 2015

WATER RESOURCES DEPT  
SALEM, OREGON

 DFN-6LL-34

Stamped 2015.9.25