

**T.24S., R.13W., W.M. SECTION 10
 MAP FOR SURFACE WATER RIGHT POINT OF DIVERSION
 COOS BAY LUMBER
 TAX LOTS 900
 MAP NO. 241310
 COOS COUNTY, OREGON
 SEPTEMBER 2009**

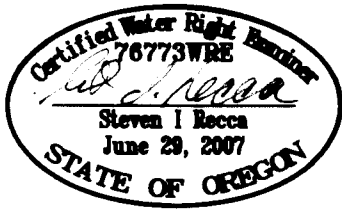
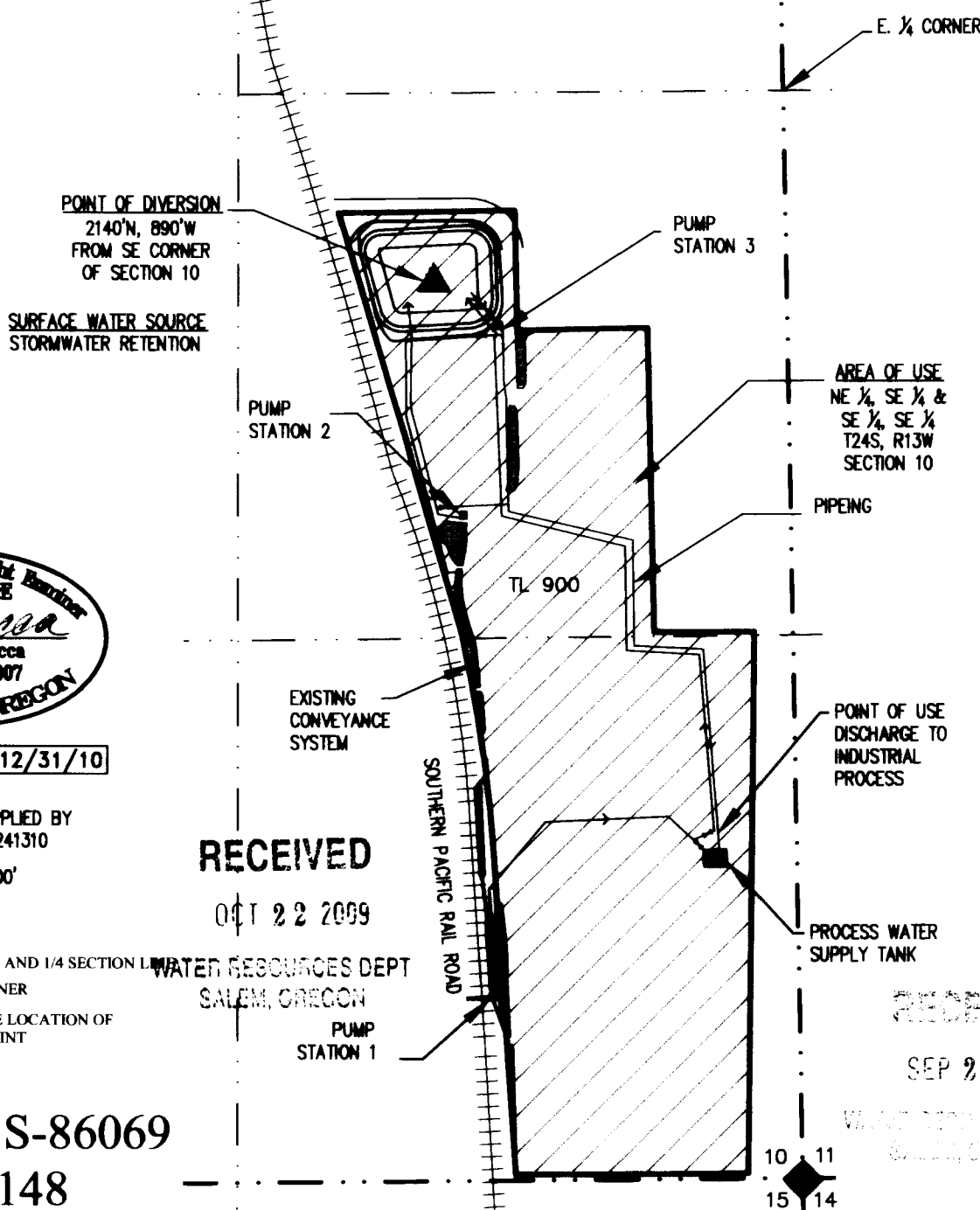

EXPIRATION DATE: 12/31/10

BASE MAPPING SUPPLIED BY
 ASSESSORS MAP #241310

SCALE: 1" = 400'

LEGEND

- SECTION LINE AND 1/4 SECTION LINE
- ◆ SECTION CORNER
- ▲ APPROXIMATE LOCATION OF DIVERSION POINT

**Application S-86069
 Permit S-54148**

THIS MAP IS FOR THE PURPOSE OF LOCATING A WATER RIGHT AND IS NOT INTENDED TO PROVIDE LEGAL DIMENSIONS FOR LOCATION OF PROPERTY BOUNDARIES.

EGR & Associates, Inc.
 Engineers and Geologists

2535B Prairie Road
 Eugene, Oregon 97402

(541) 688-8322
 Fax (541) 688-8067

10/29/09 10:51 AM C:\pwworking\Water Rights\241310\Map\241310.dwg 4 1/4" x 11" 10/29/09 10:51 AM