

KRUMBEIN ENGINEERING LTD.
 ENGINEERS - SURVEYORS - PLANNERS
 361. S.E. Second Pendleton, Oregon

Scale
 1" = 200'
 Date
 10-11-15

Drn. By
 Gkd. By

Draw. No.
 1807A
 Job No.
 1822

Revision 1
 Revision 2

SUPPLEMENT TO
 CLAIM OF BENEFICIAL USE
HOSKINS
 SE 1/4, NE 1/4, SECTION 8
 T. 3. 6., R. 25 E. W. M.
 MORROW COUNTY, OR.

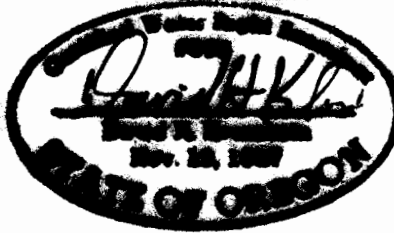

RENEWS 6/30/2017

PROPOSED
T-6761

RECEIVED BY OWRD

NOV 19 2015

SALEM, OR

RECEIVED

NOV 24 2003

WATER RESOURCES DEPT
SALEM OREGON

FINAL PROOF SURVEY

AND

CLAIM OF BENEFICIAL USE

ADDITIONAL POINTS OF DIVERSION
LOCATED WITHIN

SECTIONS 5,6,8,9 AND 16, T.3S., R.25E., W.M.,
MORROW COUNTY, OREGON

APPLICANTS: ROBERT M. HOSKINS AND FRED M. HOSKINS TRUST

TRANSFER 6761

SPECIAL ORDER VOLUME 55, PAGE 1,220

CORNER TIE:

ADDITIONAL P.O.D. 1 IS WITHIN THE SE 1/4,
NW 1/4 SECTION 16, T.3S, R.25E., AND IS
7,245 FEET SOUTH AND 1,575 FEET EAST OF
THE SECTION CORNER COMMON TO SECTIONS
4, 5, 8 AND 9, T.3S., R.25E., W.M.

ADDITIONAL P.O.D. 2 IS WITHIN THE NW 1/4,
SW 1/4 SECTION 9, T.3S, R.25E., AND IS
3,680 FEET SOUTH AND 530 FEET EAST OF
THE SECTION CORNER COMMON TO SECTIONS
4, 5, 8 AND 9, T.3S., R.25E., W.M.

ADDITIONAL P.O.D. 3 IS WITHIN THE NE 1/4,
NW 1/4 SECTION 8, T.3S, R.25E., AND IS 45
FEET SOUTH AND 3,550 FEET WEST OF THE
SECTION CORNER COMMON TO SECTIONS 4,
5, 8 AND 9, T.3S., R.25E., W.M.

ADDITIONAL P.O.D. 4 IS WITHIN THE SW 1/4,
SW 1/4 SECTION 5, T.3S, R.25E., AND IS
965 FEET NORTH AND 4,810 FEET WEST OF
THE SECTION CORNER COMMON TO SECTIONS
4, 5, 8 AND 9, T.3S., R.25E., W.M.

ADDITIONAL P.O.D. 5 IS WITHIN THE NW 1/4,
SE 1/4 SECTION 6, T.3S, R.25E., AND IS
3,815 FEET SOUTH AND 3,745 FEET EAST OF
THE TOWNSHIP CORNER COMMON TO
SECTIONS 1, 6, 31 AND 36, T.2 AND 3S.,
R.24 AND 25E., W.M.

ADDITIONAL P.O.D. 6 IS WITHIN THE SE 1/4,
NW 1/4 SECTION 6, T.3S, R.25E., AND IS
2,170 FEET SOUTH AND 1,975 FEET EAST OF
THE TOWNSHIP CORNER COMMON TO
SECTIONS 1, 6, 31 AND 36, T.2 AND 3S., R.
24E. AND 25E., W.M.

ADDITIONAL P.O.D. 7 IS WITHIN THE NW 1/4,
NW 1/4 SECTION 6, T.3S, R.25E., AND IS
340 FEET SOUTH AND 690 FEET EAST OF
THE SECTION CORNER COMMON TO SECTIONS
1, 6, 31 AND 36, T.2 AND 3S., R.24 AND
25E., W.M.

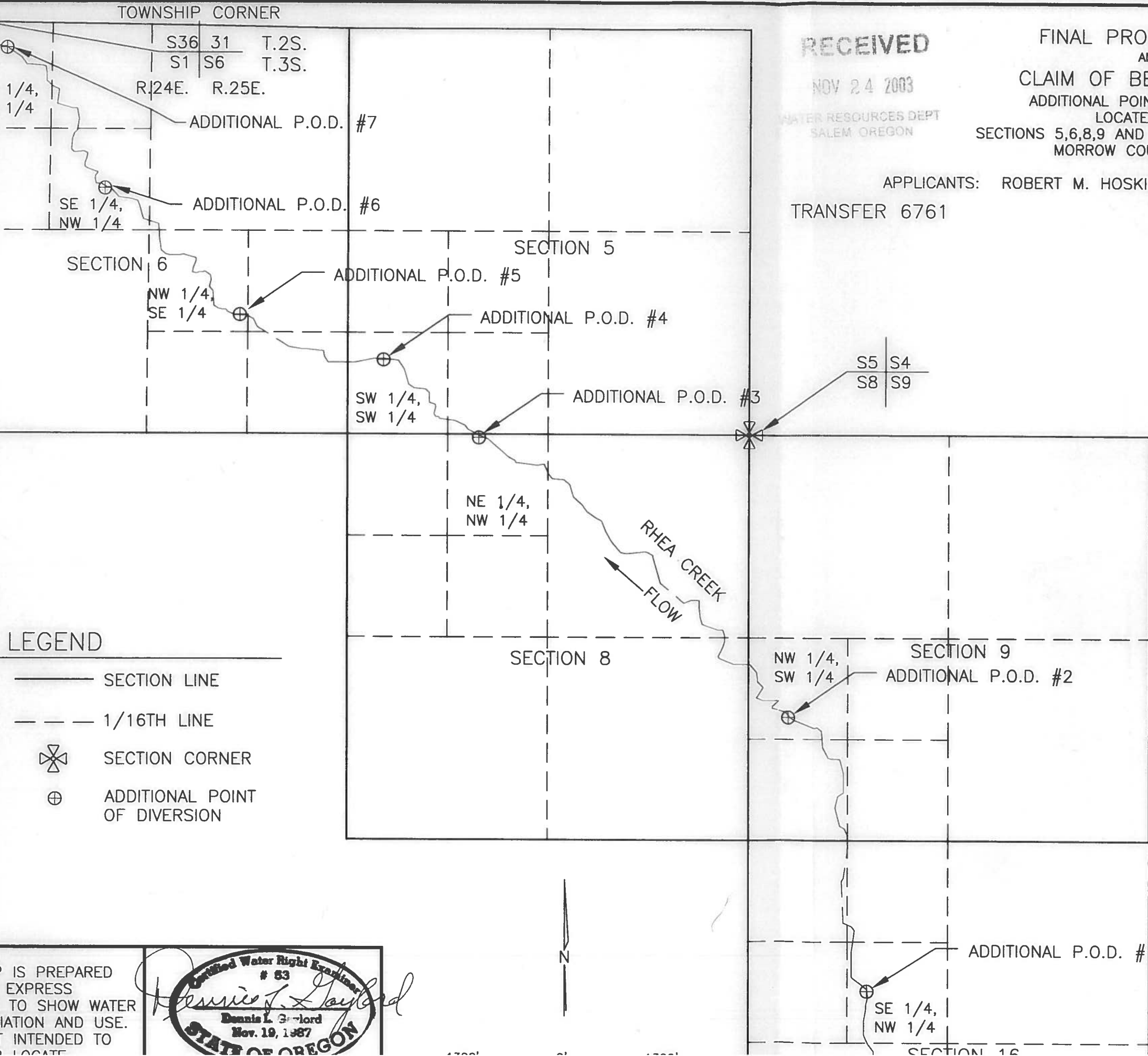

LEGEND

- SECTION LINE
- - - 1/16TH LINE
- ⊗ SECTION CORNER
- ⊕ ADDITIONAL POINT OF DIVERSION

MAP IS PREPARED
THE EXPRESS
USE TO SHOW WATER
APPROPRIATION AND USE.
NOT INTENDED TO
OR LOCATE

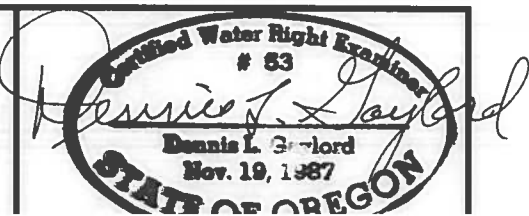

DENNIS L. GAYLORD,
CWRE
71614 S.W. LAKE DRIVE
PENDLETON OR 97801