

# Historic POD Transfer for Certificate 17181

## 36S-1E-4 NE/SW

### Tax Lots: 600, 1100, & 1000

### Place of Use 10.9 Acres in NE/SW

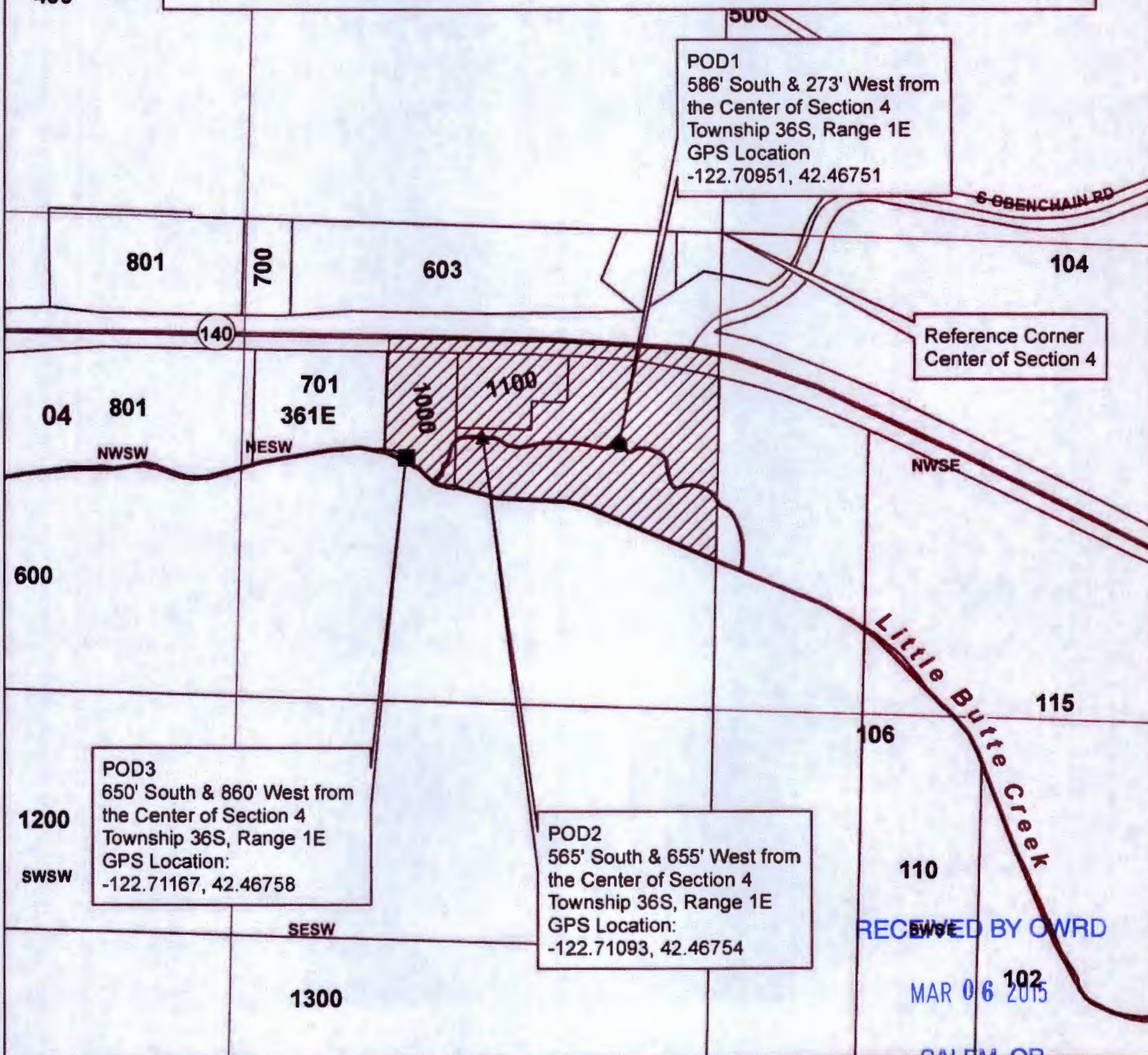

POD1  
586' South & 273' West from  
the Center of Section 4  
Township 36S, Range 1E  
GPS Location  
-122.70951, 42.46751

Reference Corner  
Center of Section 4

POD3  
650' South & 860' West from  
the Center of Section 4  
Township 36S, Range 1E  
GPS Location:  
-122.71167, 42.46758

POD2  
565' South & 655' West from  
the Center of Section 4  
Township 36S, Range 1E  
GPS Location:  
-122.71093, 42.46754

RECEIVED BY OWRD  
MAR 06 2015  
SALEM, OR

#### Legend

- Taxlots
- Place of Use Cert # 17181 (10.9 Acres)
- POD1
- Townships
- POD2
- Sections
- POD3
- Quarter Quarter Sections

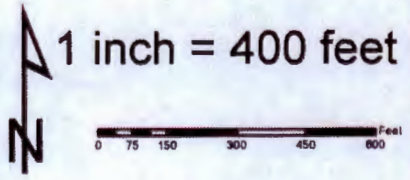

JACKSON COUNTY  
WATERMASTER

Prepared by Travis Kelly

This map is based on a digital database compiled by Jackson County from a variety of sources. Jackson County cannot accept responsibility for errors, omissions, or positional accuracy. There are no warranties, expressed or implied.

T 11998

# Authorized Point of Diversion Certificate 17181 36S-1E-11 SE/SW

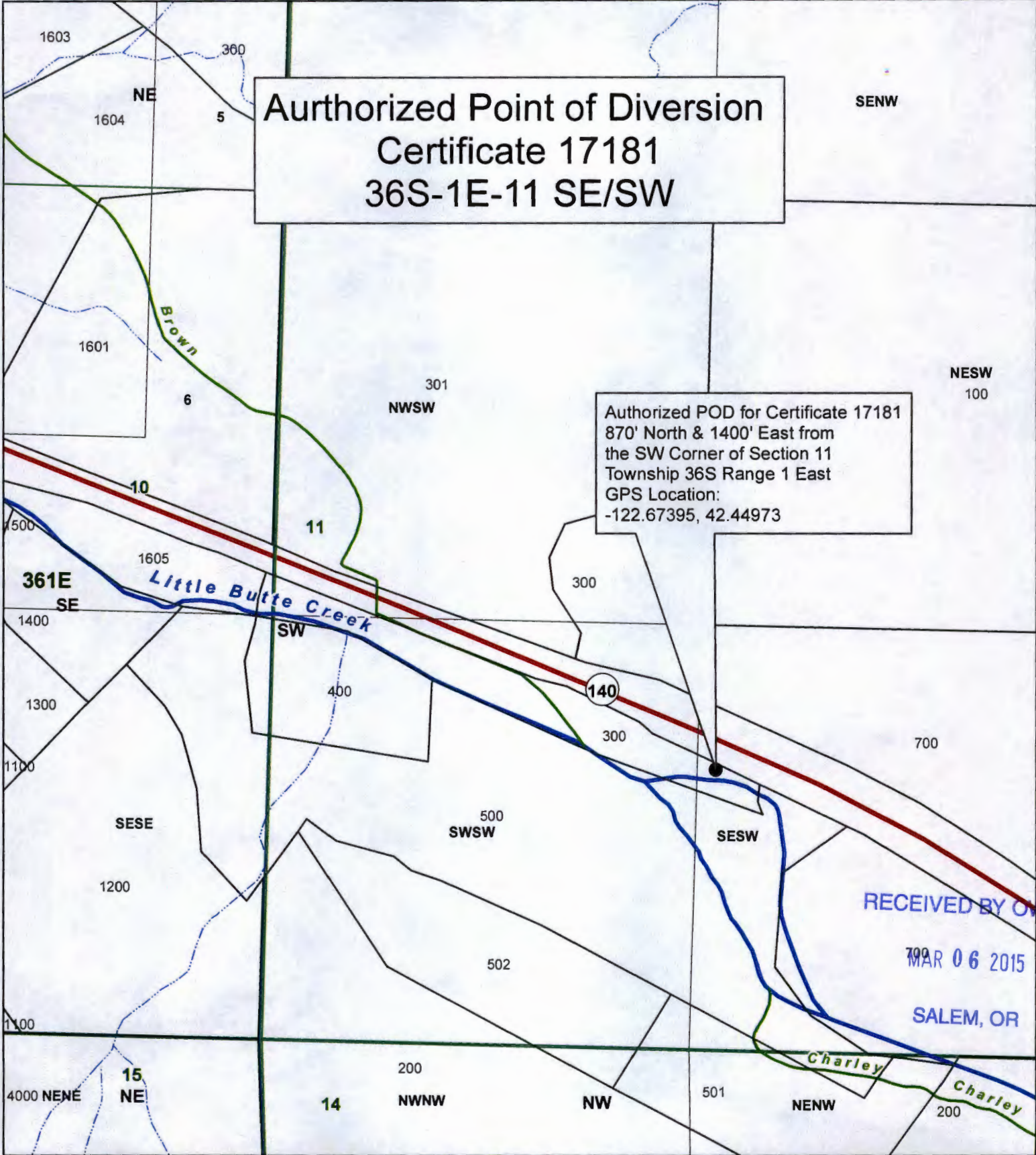

Authorized POD for Certificate 17181  
870' North & 1400' East from  
the SW Corner of Section 11  
Township 36S Range 1 East  
GPS Location:  
-122.67395, 42.44973

RECEIVED BY OWI  
MAR 06 2015  
SALEM, OR

### Legend

- Authorized\_POD
- Taxlots
- ▭ Townships
- ▭ Sections
- ▭ Quarter Sections
- ▭ Quarter Quarter Sections



1 inch = 400 feet

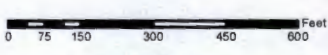

T 11998

JACKSON COUNTY  
WATERMASTER

Prepared by Travis Kelly

This map is based on a digital database compiled by Jackson County from a variety of sources. Jackson County cannot accept responsibility for errors, omissions, or positional accuracy. There are no warranties, expressed or implied.

Date: 01/22/2015; Authorized POD Cert # 17181.mxd; KellyTN

# Historic POD Transfer for Certificate 17181

## 36S-1E-4 NE/SW

### Tax Lots: 600, 1100, & 1000

### Place of Use 10.9 Acres in NE/SW

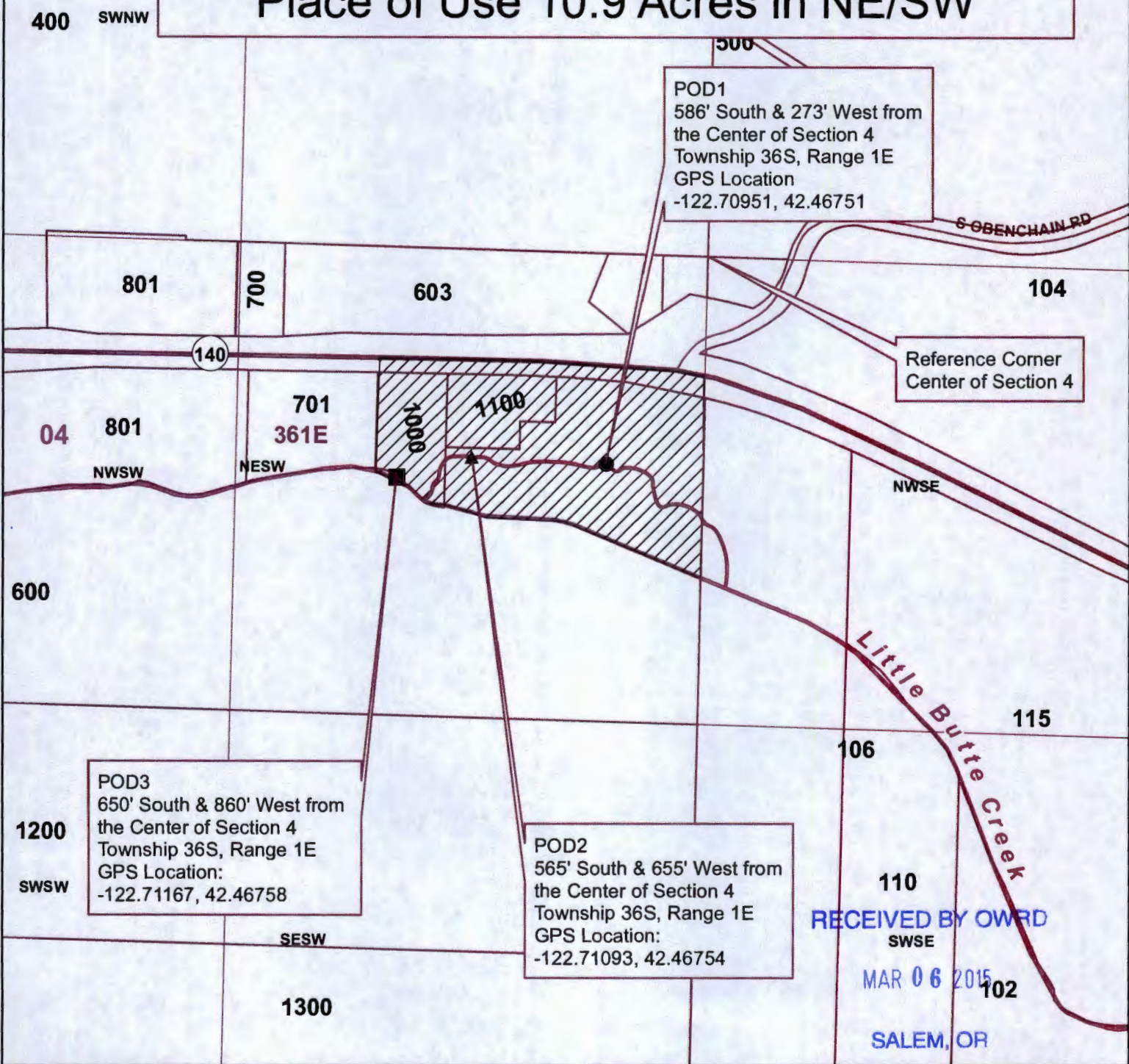

#### Legend

- Taxlots
- Place of Use Cert # 17181 (10.9 Acres)
- POD1
- Townships
- POD2
- Sections
- POD3
- Quarter Quarter Sections



1 inch = 400 feet

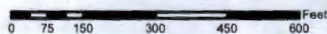

T 11998

JACKSON COUNTY  
**WATERMASTER**

Prepared by Travis Kelly

This map is based on a digital database compiled by Jackson County from a variety of sources. Jackson County cannot accept responsibility for errors, omissions, or positional accuracy. There are no warranties, expressed or implied.