

ORS 540.520(9)

SB 301 LANDS

LOCATED IN
SECTIONS 29, 32 & 33
T.10S., R.3W., W.M.

LINN COUNTY, OREGON

SCALE: 1"=1320'-0"

CITY OF MILLERSBURG

Certificate 85736
Permit S-47184
Application S-64515

"Attachment E"

Sale #2

ACREAGE SUMMARY

CERTIFICATE 85736 - PERMIT S-47184
12.0 CFS PLACE OF USE

SECTION 29	NW 1/4, NW 1/4	4.3 ACRES DLC 55
	NE 1/4, NW 1/4	17.9 ACRES DLC 55
	NW 1/4, NE 1/4	0.6 ACRES DLC 55
	SE 1/4, NE 1/4	0.8 ACRES DLC 46
	SW 1/4, NE 1/4	18.9 ACRES DLC 46
	SE 1/4, NW 1/4	7.1 ACRES DLC 55
	SW 1/4, NW 1/4	32.9 ACRES DLC 46
	SW 1/4, NW 1/4	3.7 ACRES DLC 55
	NE 1/4, SE 1/4	8.8 ACRES DLC 46
	NW 1/4, SE 1/4	3.2 ACRES DLC 46
SECTION 32	NE 1/4, SW 1/4	34.0 ACRES DLC 46
	NW 1/4, SE 1/4	36.8 ACRES DLC 46
	NE 1/4, SE 1/4	10.0 ACRES DLC 46
	SE 1/4, SE 1/4	14.6 ACRES DLC 46
	SW 1/4, SE 1/4	15.6 ACRES DLC 44
SECTION 33	SW 1/4, SE 1/4	20.9 ACRES DLC 46
	SE 1/4, SW 1/4	19.1 ACRES DLC 44
	SE 1/4, SW 1/4	12.6 ACRES DLC 48
		5.6 ACRES DLC 44
SECTION 32	NW 1/4, NE 1/4	13.3 ACRES DLC 44
	NE 1/4, NE 1/4	36.4 ACRES DLC 44
SECTION 33	NW 1/4, NW 1/4	5.4 ACRES DLC 44
		322.5 ACRES TOTAL

LEGEND:

- SECTION LINES
- - - FORTY LINES
- - - DONATION LAND CLAIM LINES
- - - APPROXIMATE PROPERTY LINE
- 30" CONCRETE PIPE TO MILL
- /// PLACE OF USE UNDER ORS 540.520(9).

NOTE:

THIS MAP SHOWS THE PLACE OF USE UNDER 1999 SB 301 ORS 540.520(9) FOR WATER RIGHT CERTIFICATE 85736.

THIS MAP AMENDS / REPLACES THE PLACE OF USE MAP FOR CERTIFICATE 85736.

THIS RE-MAP WAS CREATED AS PART OF THE CLOSURE OF THE PAPER MILL. THE MAP WAS PREPARED FOR INTERNATIONAL PAPER TO CLARIFY WHAT WATER RIGHTS GO WITH THE LAND AS IT IS SOLD. THE PROPERTY IS BEING MARKETED AS THREE PARCELS. THE LANDS SHOWN ARE PART OF SALE #2.

I. J. EDWARD HENRICKS, BEING DULY SWORN AS A WATER RIGHT EXAMINER LICENSE NO. 170, HAVE PREPARED THIS MAP FOR INTERNATIONAL PAPER ON THIS 3rd DAY OF APRIL, 2013. THE AREAS HATCHURED REPRESENT THE AREAS APPLIED TO BENEFICIAL USE.

PREPARATION OF THIS MAP IS FOR THE PURPOSE OF IDENTIFYING THE LOCATION OF THE WATER RIGHT ONLY AND HAS NO INTENT TO PROVIDE DIMENSIONS OR LOCATION OF PROPERTY OWNERSHIP LINES.

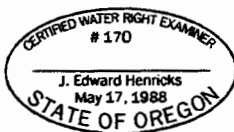
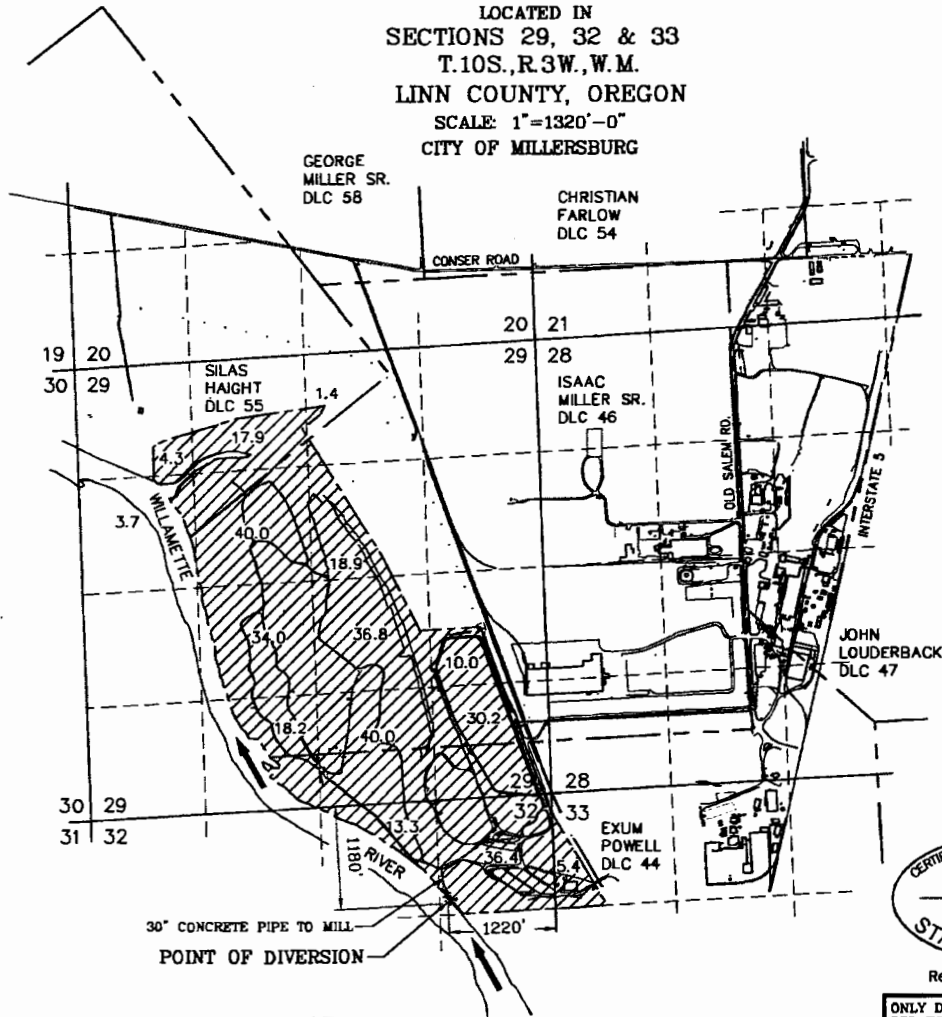

Renews: June 30, 2013

ONLY DOCUMENTS STAMPED WITH
RED INK ARE ORIGINALS.

DRAWING NO. 3650P03R1