

Instream Transfer Application Map
Authorized Place of Use and Point of Diversion
Deming Creek - Campbell Reservoir Diversion
Certificate #9961 & Campbell Reservoir

[Handwritten signature and checkmark]

Township 36 South, Range 15 East (W.M.)

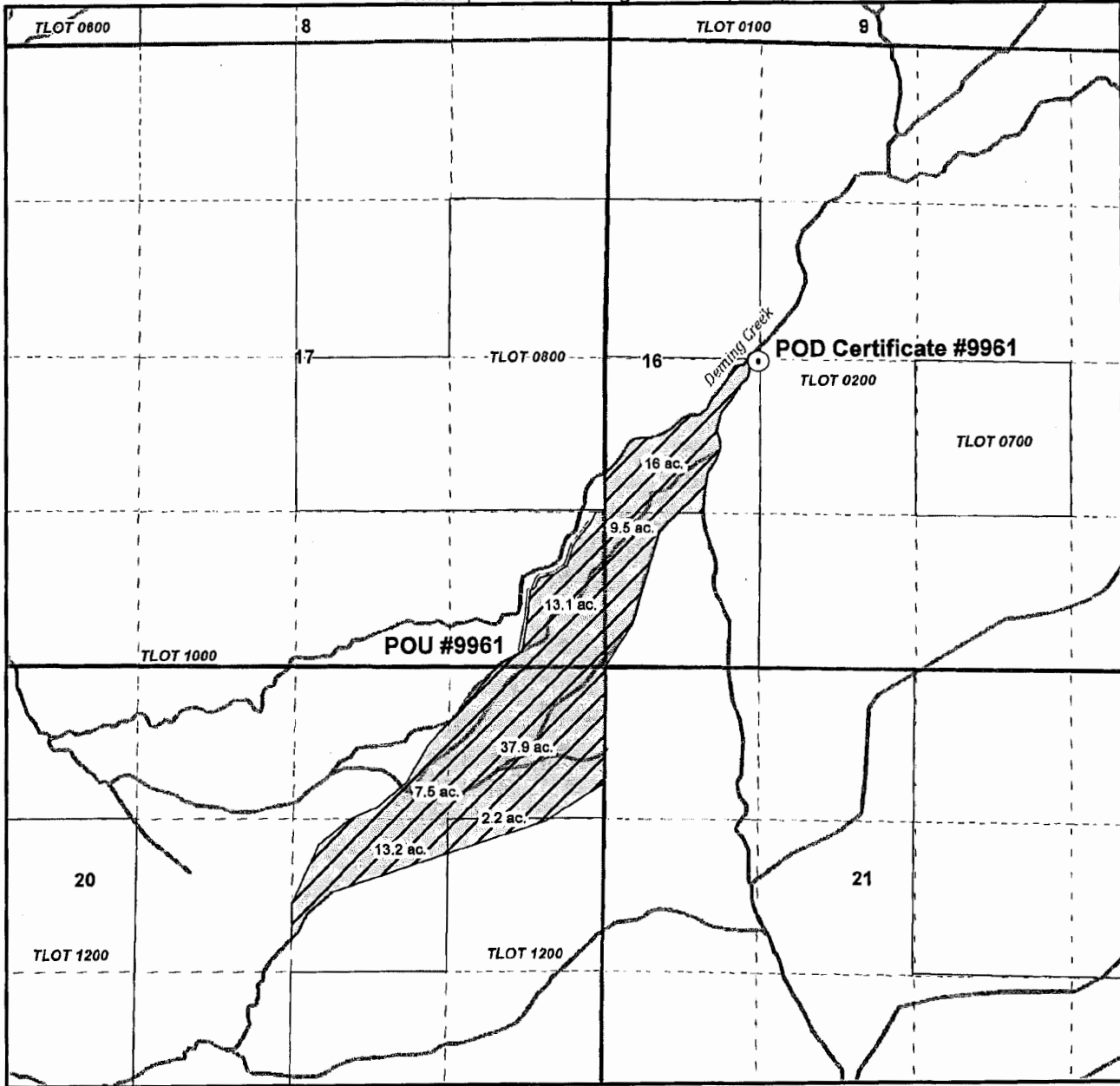

Path: D:\GIS\Deming Mapping\Map files\DemingTransfer_9961.mxd

Legend

- Authorized Place of Use (POU) #9961
- Authorized Point of Diversion (POD) #9961
- Tax Lots
- Streams
- Canal/ditch

POD Location Description

POD Cert.#: 9953
 Location: 42.448166°, -120.953362°

Disclaimer

This map was prepared for the purpose of identifying the location of a water right only and is not intended to provide legal dimensions or location of property ownership.

Map Notes

Date: March 12, 2014
 Data Sources: Klamath County, OWRD, & USGS GIS
 Prepared By: Klamath Basin Rangeland Trust

RECEIVED BY OWRD

MAY 05 2014

SALEM, OR

