

CLAIM OF BENEFICIAL USE MAP FOR T-8116

T 39 S, R 7 W, W M, JOSEPHINE COUNTY

Portions of Sections 22 and 23

October 18, 2009



1" = 400'

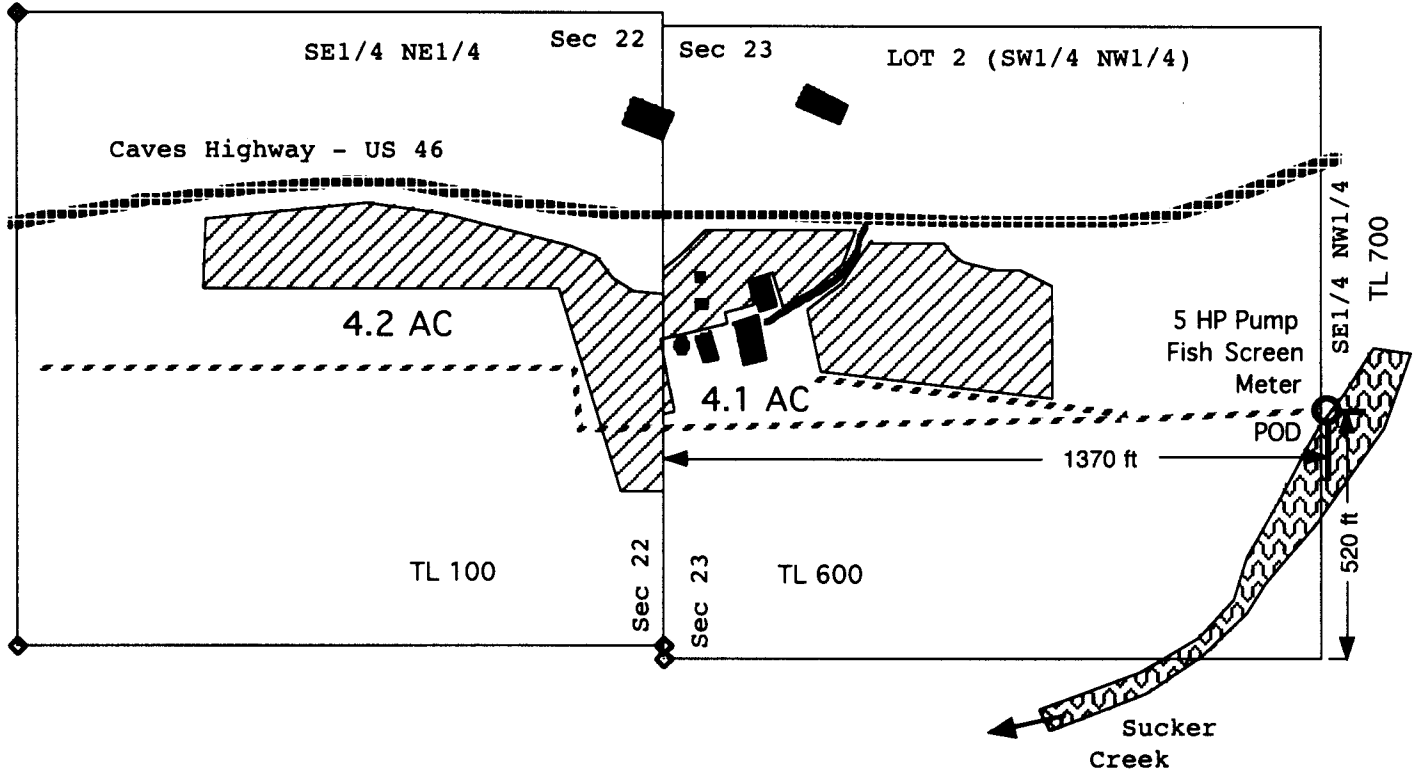

- 8.3 acres of irrigation with a priority of 1898 and a rate of 0.17 cfs.
- Point of diversion (POD).
- Buried 2 inch diameter PVC and Poly pipelines.
- Buildings.

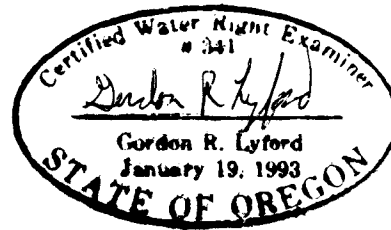

10-18-2009
exp 12-31-2010

This map was prepared by Gordon R. Lyford for Stanley R. and Roberta C. Richards to support their Claim of Beneficial Use under T-8116. They own tax lots 100 and 600.

This map was prepared for the purpose of identifying the location of water rights only and is not intended to provide legal dimensions or the location of property ownership lines.