

# FINAL PROOF SURVEY

SITUATED IN THE E1/2 OF SECTION 30 AND THE  
N1/2 NE1/4 OF SECTION 31, T40S, R10EWM,  
KLAMATH COUNTY, OREGON  
OCTOBER, 2013



SCALE  
1" = 1320'

MAP PREPARED FOR  
GRESHAM FAMILY TRUST

\* THE PURPOSE OF THIS MAP IS TO IDENTIFY THE LOCATION OF THE WELL AND PRIMARY IRRIGATION.

\*\* FOR SUPPLEMENTAL IRRIGATION SEE KLAMATH ADJUDICATION CLAIM MAP FOR KA1000 DATED FEBRUARY 12, 2013.

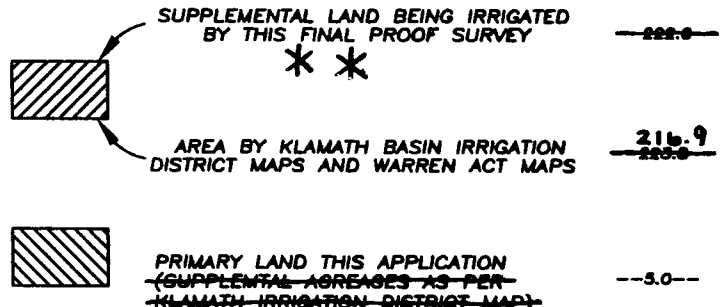
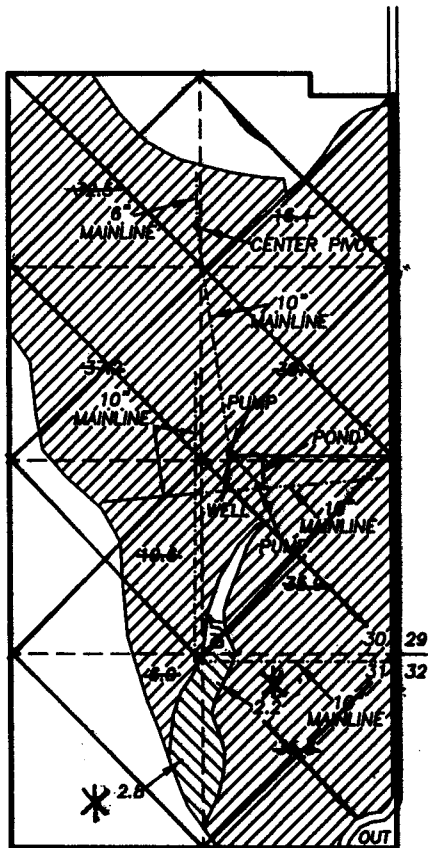

WRD VFB  
11-23-15

NOTES:

1. THERE ARE NO DEFINED BOUNDARIES OF THE WARREN ACT LAND AND KLAMATH BASIN IRRIGATION DISTRICT LAND (IN EACH 40) ON THE KLAMATH IRRIGATION DISTRICT MAP. ACREAGES FOR EACH 40, AS SHOWN ON THE ACCOMPANYING MAP, ARE WARREN ACT, KLAMATH BASIN IRRIGATION DISTRICT, AND PRIMARY LANDS COMBINED. ON THE LANDS ADJACENT TO CHEYNE ROAD THE ACREAGE WAS REDUCED BY THE AREA IN THE SAID ROAD.
2. THE PURPOSE OF THIS MAP IS TO IDENTIFY THE LOCATION OF THE WATER RIGHT. IT IS NOT INTENDED TO PROVIDE INFORMATION RELATIVE TO THE LOCATION OF PROPERTY OWNERSHIP BOUNDARY LINES.
3. MAP PREPARED FROM: ASSESSORS MAP, AERIAL PHOTOGRAPH, MAP OF KLAMATH IRRIGATION DISTRICT, AND FIELD SURVEY.
4. WELL IS 1354 FEET NORTH AND 1123 FEET WEST OF THE SOUTHEAST CORNER OF SECTION 30.
5. TOTAL AREA THIS APPLICATION: 228.0 ACRES
6. APPLICATION # G-12841
7. PERMIT # G-13532
8. TAX LOT #'S: R-4010-00000-3300 AND 3400

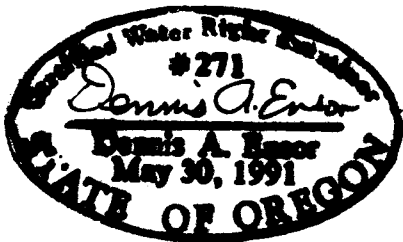

EXPIRES: 12/31/2013

MAPPED BY:

**TRU SURVEYING INC. LINE**  
2333 SUMMERS LANE  
KLAMATH FALLS, OREGON 97603

**SAN-DEN CONSULTING INC.**  
PO BOX 498  
MERRILL, OREGON 97633

